

# Contents

**1 FOR VIDEO DOORBELL INSTALLATION**

**2 AT A GLANCE**

**3 HOW THE SYSTEM WORKS**

**4 CHARGING THE DOORBELL**

**5 SETTING UP THE SYSTEM**

**6 MOUNTING THE DOORBELL**

# 1 FOR VIDEO DOORBELL INSTALLATION

## What You Need

- Phillips-Head Screwdriver
- Power Drill (15/64" Drill Bit)

## What's in the Box

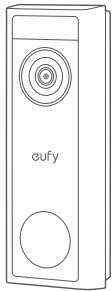

Video Doorbell C30  
Model: T8224

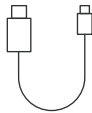

USB-C Charging  
Cable

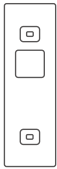

Mounting Bracket



Screw Hole Positioning  
Card

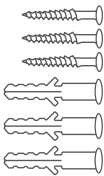

Screw Pack



Detaching Pin



Quick Start Guide

# 2 AT A GLANCE

## Front View

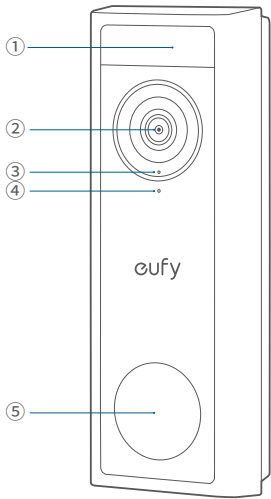

❶	Motion Sensor
❷	Camera Lens
❸	Microphone
❹	Ambient Light Sensor
❺	LED Ring / Doorbell Button

Rear View

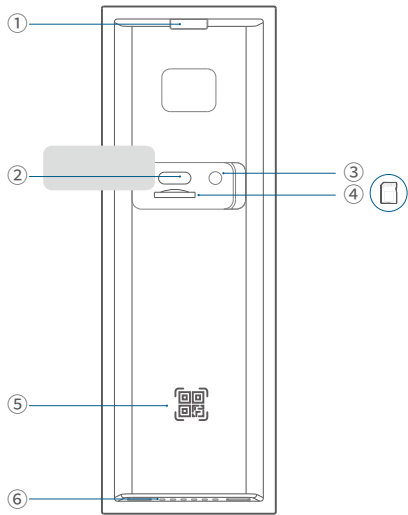

❶	<b>Detaching Mechanism</b>
❷	<b>USB-C Port</b> <ul style="list-style-type: none"><li>· Use to charge the doorbell.</li></ul>
❸	<b>SYNC Button</b> <ul style="list-style-type: none"><li>· Press to turn on the doorbell.</li><li>· Press and hold for 2 seconds until you hear a beep to set up the doorbell. (Optional)</li><li>· Press quickly 5 times within 3 seconds to turn off the doorbell.</li></ul>
❹	<b>SD Card Slot</b>
❺	<b>QR Code</b> <ul style="list-style-type: none"><li>· Scan to add the doorbell in the app.</li></ul>
❻	<b>Speaker</b>

3 HOW THE SYSTEM WORKS

Works Independently

This video doorbell can work independently once it is connected to your home wireless router. Additionally, you have a variety of options to receive notifications and hear a ring when someone presses your video doorbell.

- Use a eufy Security doorbell chime (sold separately).
- Use an Amazon Alexa Echo Show device.

Works with eufy Security HomeBase (Optional)

The video doorbell detects motion at your porch and lets you to answer the door anytime, anywhere. You can store video clips in the built-in storage of your eufy HomeBase S380 (sold separately). When someone rings the doorbell, people in the house will be notified.

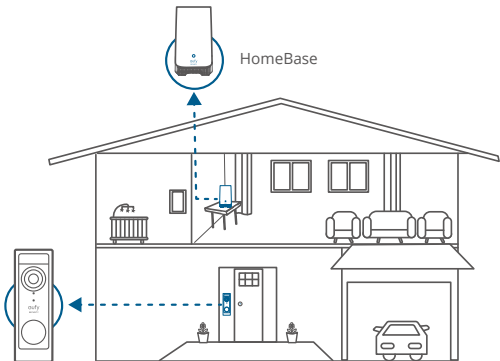

## 4 CHARGING THE DOORBELL

1. Pull out the silicone lid on the back of the doorbell, and plug the charging cable into the charging port.

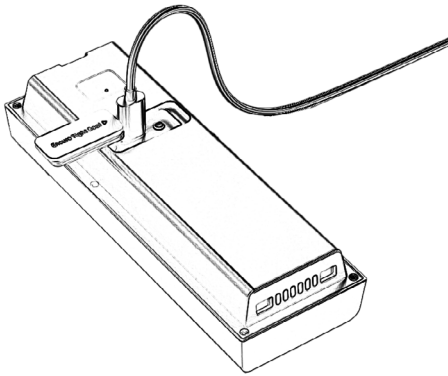

2. Plug the charging cable into a USB power adapter, then plug the power adapter into the wall. Fully charge the doorbell before installation.

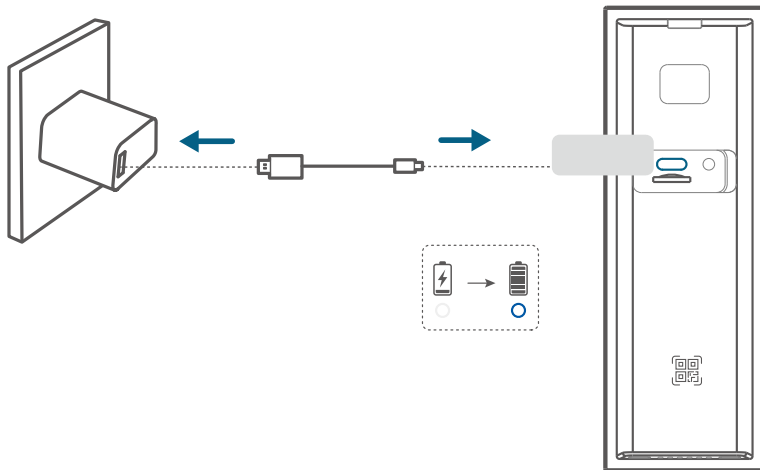

## 5 SETTING UP THE SYSTEM

1. Download and install the eufy Security app, then sign in or create an account.



2. Follow the in-app instructions to add the video doorbell.

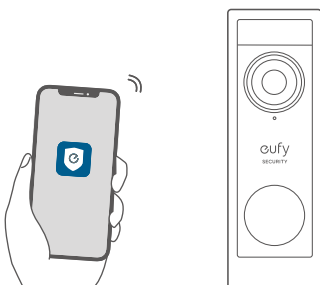

## 6 MOUNTING THE DOORBELL

### Choose a Location

1. Take the video doorbell to your front door and check the live view in the app. Choose a location where you can see the desired field of view. Consider the following factors:
  - Check if you can reuse the existing holes and anchors in the wall or door frame.
  - If you want to place the doorbell near a side wall, make sure the wall isn't in the field of view. Otherwise, the IR light will be reflected and the night vision will be blurred.
  - If you are drilling the mounting holes for the first time, the recommended height is 48" (1.2m) above the ground.

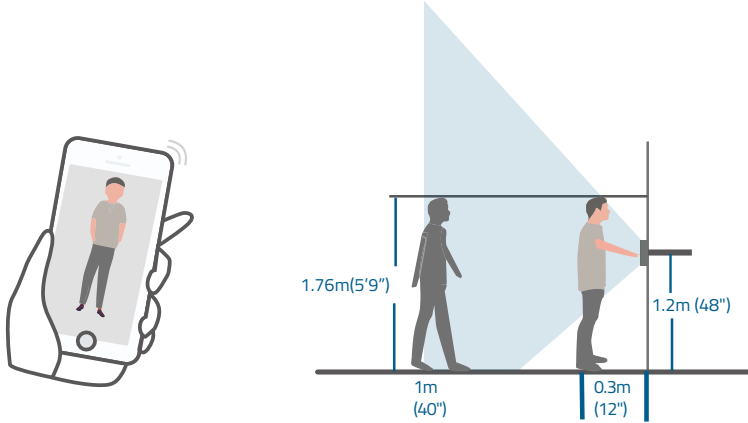

2. Place the screw hole positioning card against the wall to mark the location. If mounting on a hard wall (brick, concrete, or stucco), use a 15/64" (5.95mm) drill bit to drill 2 holes through the screw hole positioning card.

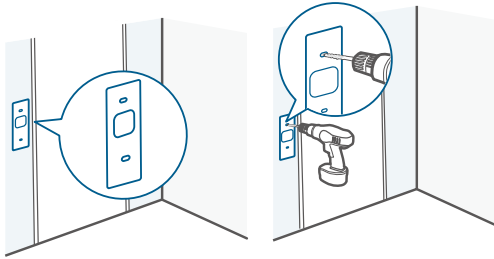

 What you need: Phillips-Head Screwdriver; Power Drill (15/64" Drill Bit)

### Mount the Bracket

Use the provided screws to secure the mounting bracket on the wall.

#### Wooden Wall

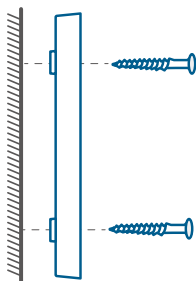

Mounting  
Bracket

#### Hard Wall

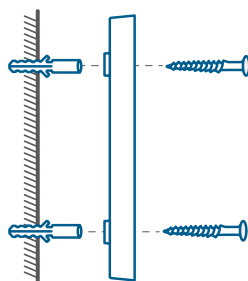

Mounting  
Bracket

## Install the Doorbell

Align the doorbell with the bottom of the mounting bracket, then press the top of the doorbell into place until it clicks.

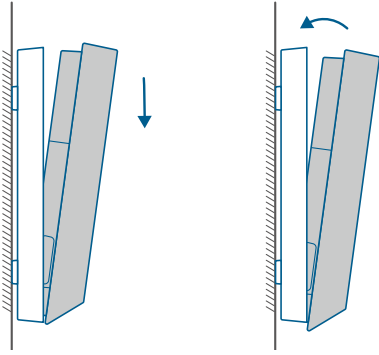

## Recharging the Doorbell

1. Insert the detaching pin into the pin hole on the top of the doorbell, then lift the top for removal.

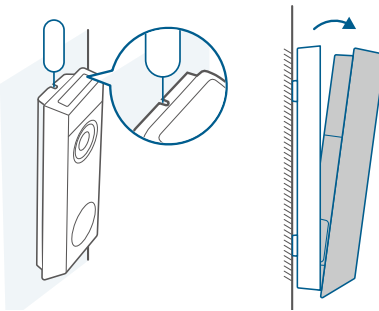

2. Repeat steps in "**CHARGING THE DOORBELL**".