

SUPPORT

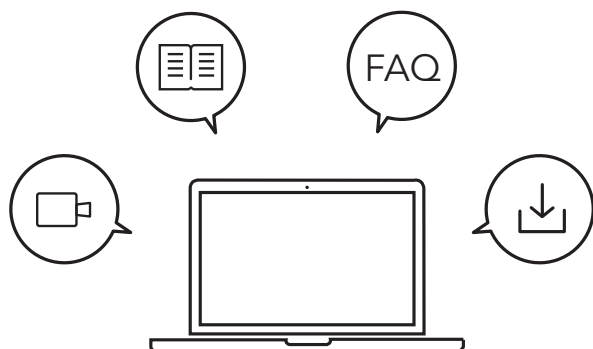

For FAQs and additional support, visit <https://support.soundcore.com/s/>.

APP



Google Play and the Google Play logo are trademarks of Google Inc.



Apple and the Apple logo are trademarks of Apple Inc.



Download the soundcore app to customize EQ settings and BassUp functions, update firmware, and access additional features.

If your headphones cannot connect to the soundcore app, re-install the app from your mobile app store or update it to the latest version.

OVERVIEW

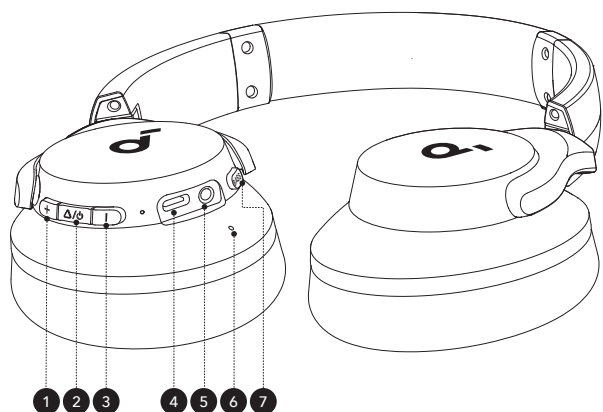

1. Volume Up Button
2. Multi-Function Button
3. Volume Down Button
4. USB-C Charging Port
5. 3.5mm Input
6. LED Indicator
7. BassUp Button

WEARING

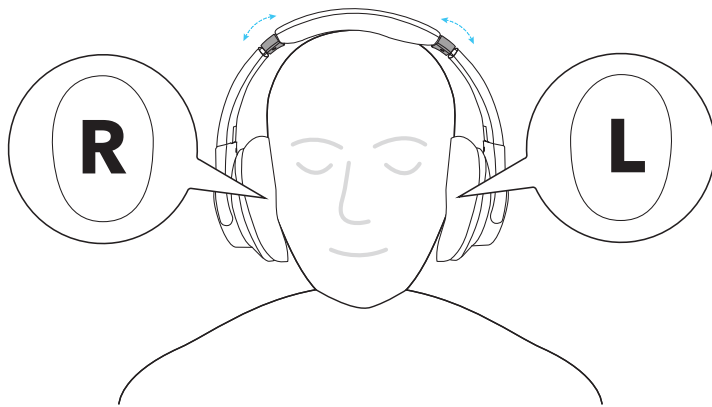

Wear the headphones with the "L" marking on your left ear and the "R" marking on your right. Adjust the headband length for a comfortable fit.

CHARGING

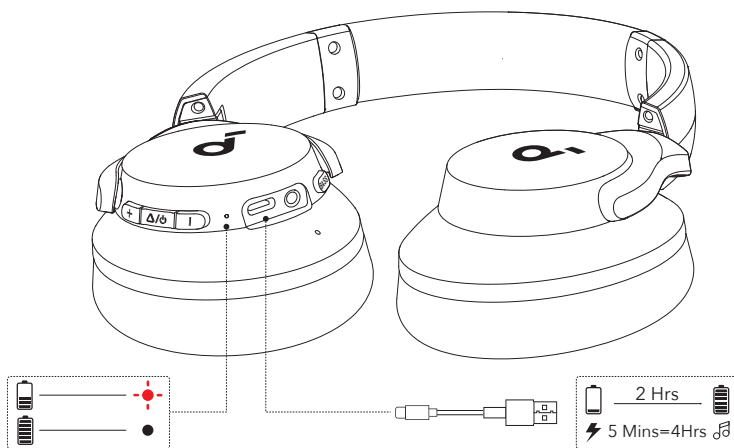

Use the provided USB-C charging cable to connect your headphones to a power source. A full charge takes about 2 hours while 5 minutes of charging provides up to 4 hours of playtime.



- Ensure the headphones and USB-C charging port are fully dry before charging.
- Do not power on your headphones while charging.

POWERING ON AND PAIRING

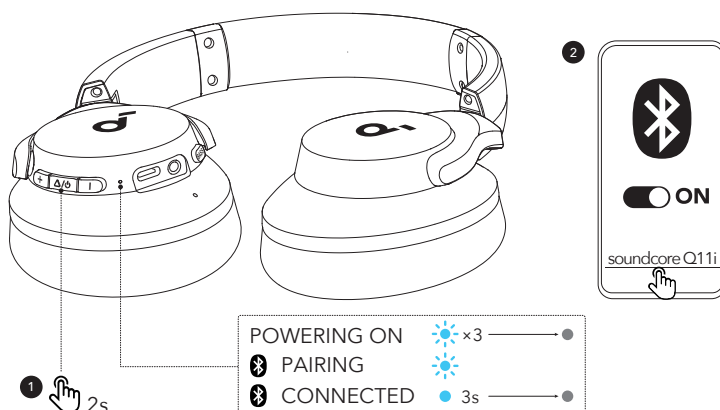

1. Press the multi-function button for 2 seconds to power on the headphones.
2. Then, they will automatically enter Bluetooth pairing mode.
3. Select **soundcore Q11i** from your device's Bluetooth list to connect.

MANUAL PAIRING

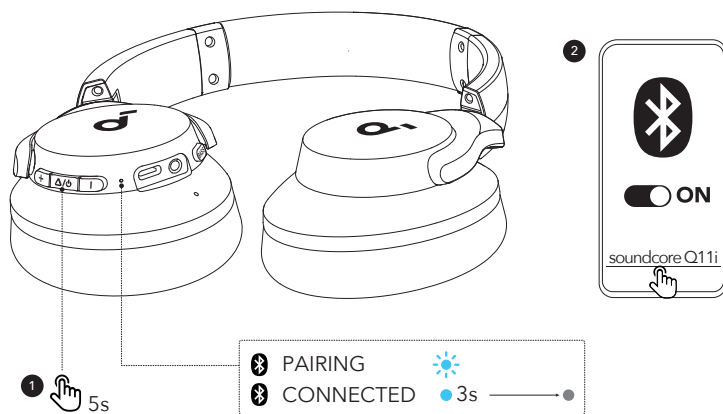

To manually enter Bluetooth pairing mode, power off the headphones and press the multi-function button for 5 seconds.

DUAL CONNECTIONS

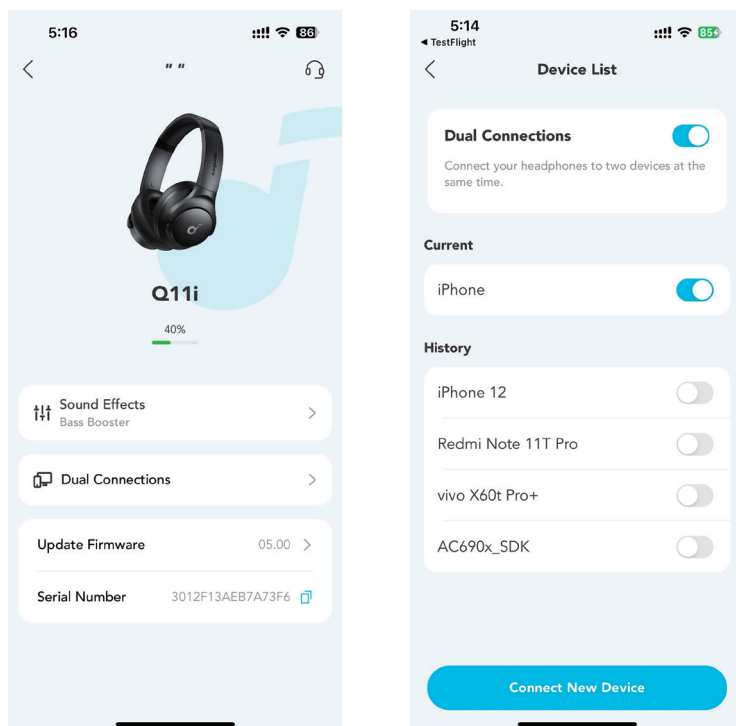

To connect the headphones with two devices at the same time, ensure they are connected to only one device. Then, press the multi-function button twice to pair with the second device.

You can also enable Dual Connections via the soundcore app. In the soundcore app, go to **Dual Connections > Enable Dual Connections > Connect New Device**.



- Dual Connections is enabled by default.

BUTTON CONTROLS

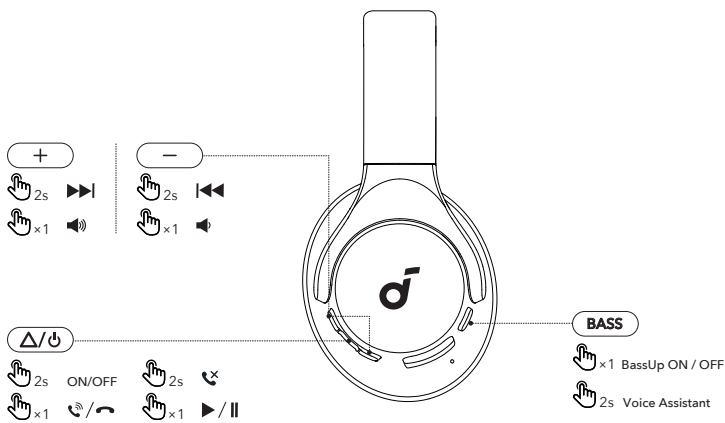

x1: Press once x2: Press twice 2s: Press for 2 seconds

	BassUp On / Off		Press Once
	Power On / Off		Press for 2 Seconds
	Play / Pause Audio		Press Once
	Play the Next Track		Press for 2 Seconds
	Play the Previous Track		Press for 2 Seconds
	Increase / Decrease Volume		Press Once
	Answer / End a Call		Press Once
	Reject a Call		Press for 2 Seconds
	Activate Voice Assistant		Press for 2 Seconds

WIRED LISTENING

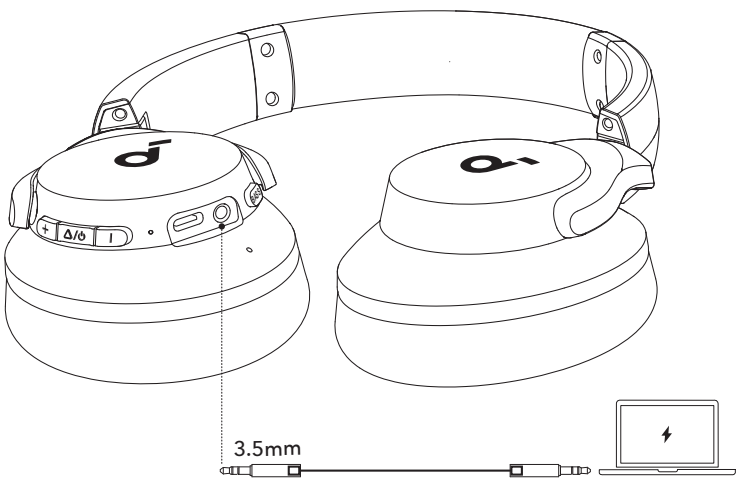

To play audio from an external device, connect the provided 3.5mm AUX cable. This will disable Bluetooth mode and the buttons will not function during wired listening.



- Wired listening provides a Hi-Res audio experience.

POWERING OFF

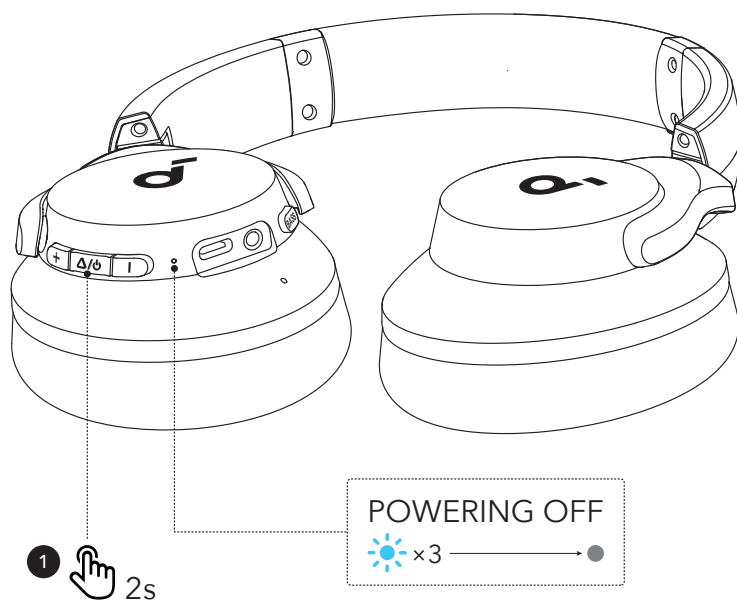

To power off, press the multi-function button for 2 seconds.



- When connected, the headphones will automatically power off after 1 hour of inactivity. This duration can be customized in the soundcore app.
- When not connected, the headphones will automatically power off after 10 minutes of standby mode.

DETACH YOUR EAR PADS

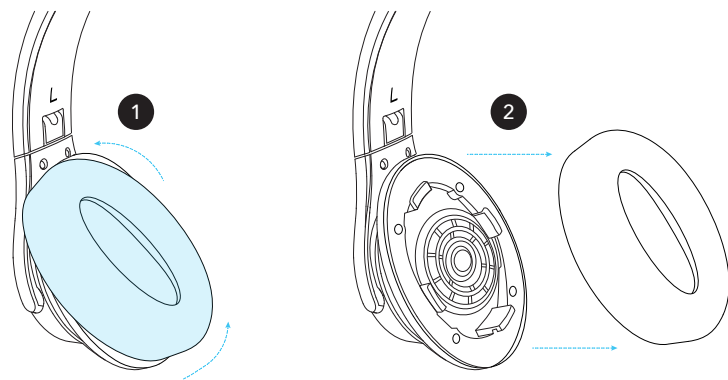

To detach the ear pads, rotate them counterclockwise.

To re-install them, align the four slots on the ear pads with the four clips on the panels, then rotate them clockwise until you hear a click.

RESET

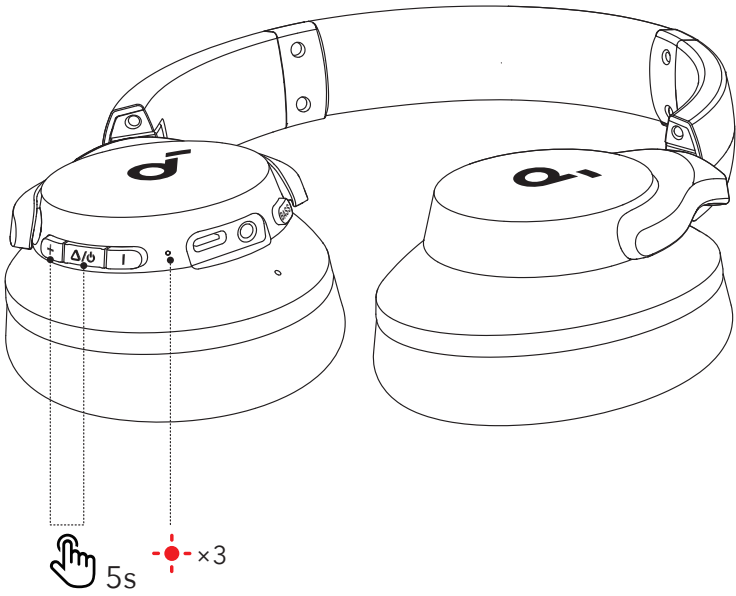

Reset your headphones if they malfunction or become unresponsive. With the headphones powered on, press the volume up and multi-function buttons simultaneously for 5 seconds until the LED slowly flashes red three times.

LED INDICATOR GUIDE

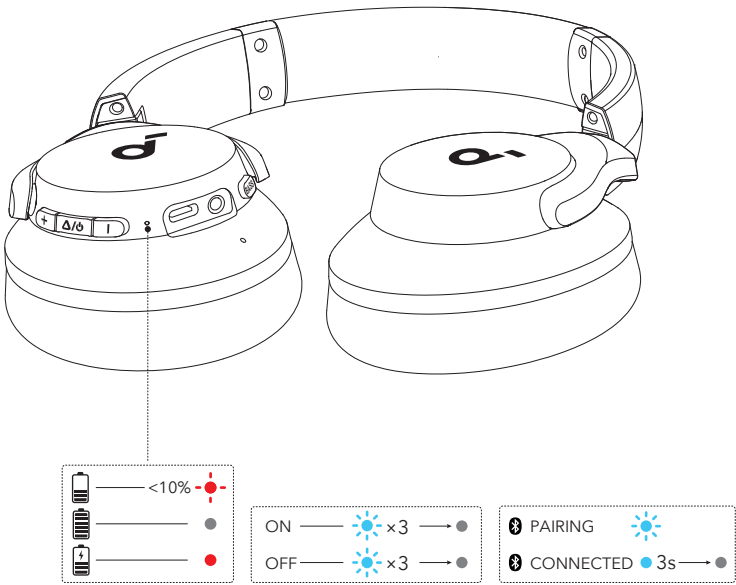

	Flashing Red Slowly
	Solid Red
	Flashing Blue Rapidly
	Solid Blue
	Light Off

FIRMWARE UPDATE

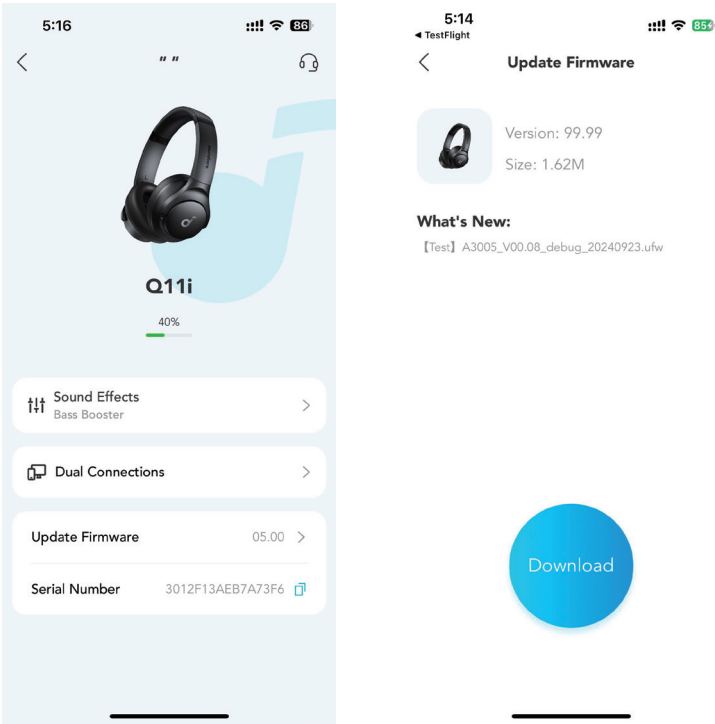

You will be notified once a new firmware version is detected when the headphones are connected to the app. Ensure the headphones are powered on and connected to a device until the firmware update is complete. Avoid any usage during the update.

SPECS

Specifications are subject to change without notice.

Input	5V $\overline{\text{---}}$ 0.75A
Rated Output Power	900mV
Battery Capacity	800mAh
Charging Time	2 Hours
Playtime (Bluetooth Mode)	Up to 60 Hours
Driver Size	40mm
Frequency Response	20Hz-40kHz
Impedance	16 Ω
Bluetooth Version	5.3
Bluetooth Range	14m

Regulations and Compliance Information

Hereby, Anker Innovations Limited declares that this device is in compliance with The Product Security and Telecommunications Infrastructure (Security Requirements for Relevant Connectable Products) Regulations 2023. For the Statement of Compliance, visit the website: <https://uk.soundcore.com/pages/psti-related>.

Note: The 'x' of SN Code: xxxxxxxxxxxxxxxx is a variable, see below table.

Variable 'x'	Range of variable	Content
Seventh	0-9 or A-F	Denotes the hardware version which is not effected on the safety compliance.
Eighth	8,9,A,B,C...	Denotes the year, 8 means 2018, 9 means 2019, A means 2020, B means 2021, C means 2022, and so on.
Ninth and tenth	01,02,03...	Denotes weeks, 01 means the first week in this year, 02 means the secondary week in this year, and so on.
Eleventh	1-7	Denotes date, 1 means Monday, 2 means Tuesday..., 7 means Sunday and so on.
The last five	00001-99999	Denotes serial No.