

What's in the Box

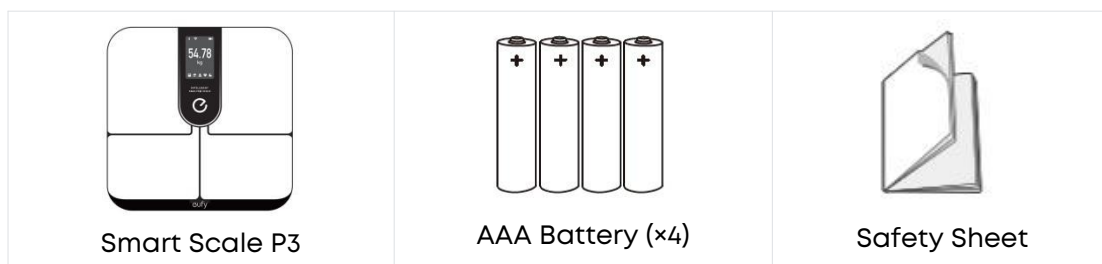

Inserting the Batteries

1. Turn the scale over and place it on a flat surface.
2. Slide down to open the battery door and insert 4 AAA batteries. Make sure the positive and negative ends are facing the correct polarity directions marked in the battery compartment.
3. Slide up to close the battery compartment door. Make sure the battery door is fixed in place.

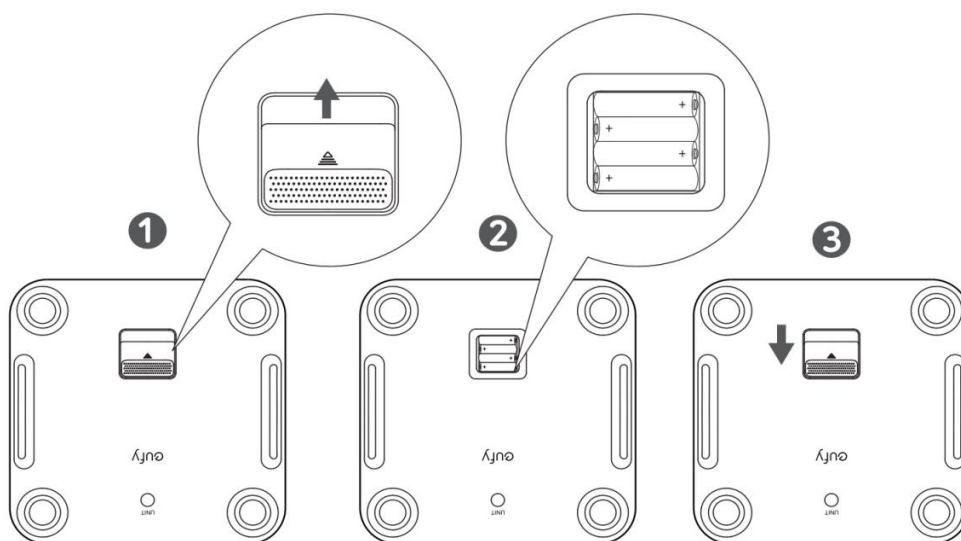

- **Low Battery** will appear on the TFT display when battery level is low. Replace all batteries at the same time. Do not mix new and used batteries.
- When not measuring, the TFT display will be off automatically after being idle for 10 seconds.

Selecting the Measuring Unit

1. Press the UNIT button at the bottom of the scale to cycle through and select the measuring unit: lb (pound) / kg (kilogram) / st (stone).

- To restore factory settings, press and hold the UNIT button for 10 seconds.

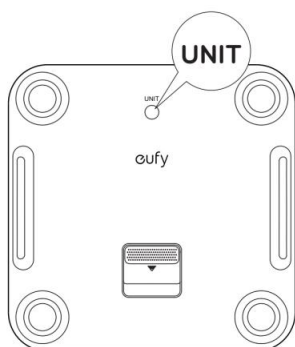

2. The measuring unit can be selected and saved within the EufyLife app. Open the EufyLife app and select the weight unit in the Device Settings menu.

Installing the EufyLife App and Pairing

1. Download the EufyLife app from the App Store (iOS devices) or Google Play (Android devices).
2. Enable Bluetooth and Wi-Fi on your smartphone.
3. Open the EufyLife app and create a user account. Please enter accurate information in your user profile.
4. Select “Add Device” on the Me page. Follow the in-app instructions to add the Smart Scale P3.

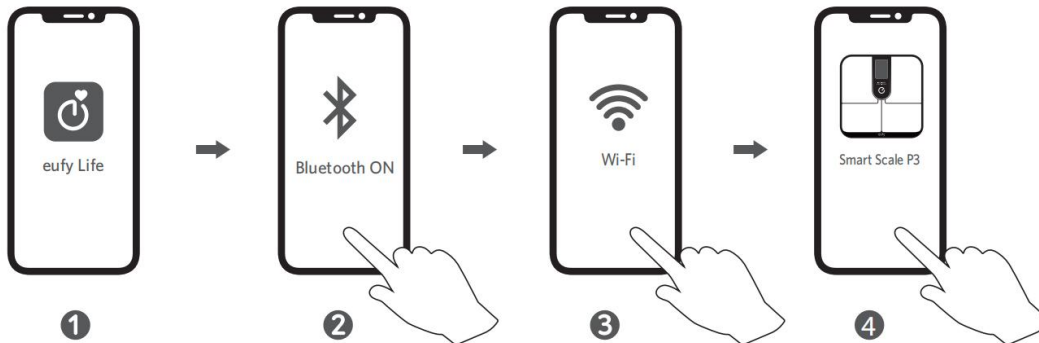

***Only compatible with 2.4GHz Wi-Fi connection**

5. Open the EufyLife app and follow the on-screen instructions to pair the scale with your device. Once paired, the app and scale will automatically connect the next time the app is opened.

 Bluetooth Status Icon	Status Icon	Indicates
	Flashing	Pairing
	Solid	Connected

 Wi-Fi Status Icon	Status Icon	Indicates
	Off	Not connected
	Flashing slowly	Ready for connecting
	Flashing quickly	Connecting
	Solid	Connected



- This scale is compatible with devices running iOS 11.0 and above or Android 6.0 and above.
- To complete the setup, you need to allow the EufyLife app to use your location.
- Do not pair the scale from your smartphone's Bluetooth menu. Use the EufyLife app to pair the scale with your smartphone.

Starting a Measurement

1. Place the scale on a hard and flat surface.
2. When measuring for the first time, please make sure you have selected your user profile.
3. Step barefoot onto the scale.
4. An analysis of your weight and your body's composition will begin automatically.
5. After measuring, your weight and other available information will be shown on the scale's screen display. You can find detailed body composition analysis within the EufyLife app.



- Step barefoot onto the scale. Stand still until the measurement is complete.
- The scale can automatically recognize users based on their previous stats.
- If the current user is not recognized, simply tap your feet to rotate between users.

Weight-Only Measurement

This scale can also be used as a conventional weight-reading scale.

1. Open the EufyLife app and tap **Device Settings**, then select **Simple Mode**.
2. Step on the scale to measure your current weight.

Data Service

Third Party Services

EufyLife App supports three third-party data service software, Apple Health, Google Fit, and Fitbit. You can open EufyLife App and find **Third Party Services** on **Me** page to synchronize data.



Only registered accounts data can be synchronized, family member data will not be synchronized.

Data Export

EufyLife APP supports exporting a copy of your data. You can open EufyLife App and find **Privacy and Data - Export All Data** on **Me** page to export data.

Maintenance

Regularly clean the scale with a dry or slightly dampened soft cloth.

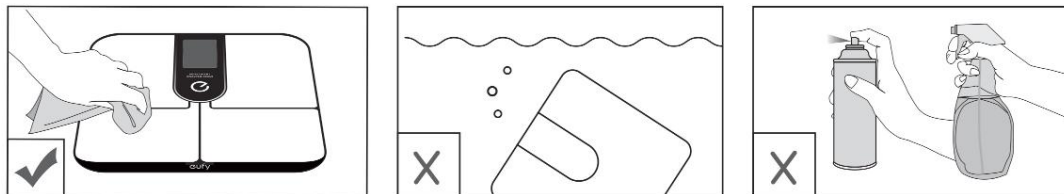

- Never wash the scale with water or immerse it in water.
- Never use detergents to clean the scale as this may cause it to malfunction or discolor.

Troubleshooting

Error Display	Description	Solution
	Overload. The device will power off.	Stop using this scale for measurement.
	Low battery. The device will power off.	Replace all batteries at the same time.
	Wi-Fi setup failure.	<ul style="list-style-type: none">• Open the EufyLife app and follow the on-screen instructions to reconnect the scale with your device.• Move the scale to a place near your router before the Wi-Fi setup.• Press and hold the UNIT button for 10 seconds to restore factory settings, then restart the Wi-Fi connection.
	Upgrade Failed	Open the EufyLife app and tap Device Settings , and then select Firmware Upgrade .

When Measuring

Issue	Cause	Solution
Abnormal measurement results: <ul style="list-style-type: none">• Too high• Too low• Large difference between two consecutive measurements	Incorrect posture.	Step onto the scale barefoot and stand still.
	Inaccurate user profile.	Make sure the user profile is accurate.
	Device is placed on soft carpeting or uneven surface.	Place the device on a hard and flat surface.
TFT display does	Batteries not installed.	Install 4 new AAA batteries.

not turn on after stepping onto the scale.	Worn batteries.	Replace all batteries at the same time.
Scale does not proceed to analyse body composition.	Taking a measurement while wearing shoes or socks.	Stand barefoot on the scale.
	Using the weight-only measuring mode in the EufyLife app.	Change the measuring mode in the EufyLife app.
	Incorrect posture.	Step onto the scale barefoot and stand still.
	Inaccurate user profile.	Make sure the user profile is accurate.

Specifications

Model	T9150
Power	6V (4 × AAA batteries)
TFT Display	3.5 inch (320*480pixel)
Measurement Units	Pound / Kilogram / Stone
Unit Increments	0.1lbs / 0.05kg
Body Fat Unit Increments	0.1 %
Body Water Unit Increments	0.1 %
Muscle Mass Unit Increments	0.1kg
Measurement Range	3kg-200kg / 6.6lbs-440lbs / 0st: 6.6lbs - 31st: 7 lbs
Activation Weight	5 kg
Working Environment	Temperature: 10°C- 40 °C Humidity: 20%-90% RH
Storage Environment	Temperature: -10 °C - 50 °C Humidity: ≤90% RH
Operating Frequency Range	2400 MHz - 2500 MHz
Transmitted Power	Wi-Fi: 18 dBm Bluetooth: 4 dBm
Bluetooth Version	5.1
Wi-Fi Version	2.4 G