

At a Glance

eufyCam E40 (T8144)

HomeBase 2 (T8010)

HomeBase S380 (T8030)

Before Mounting

For HomeBase 2

For HomeBase S380

Mounting Your eufyCam

Mounting Backup Solar Panel

Congratulations!

At a Glance

eufyCam E40 (T8144)

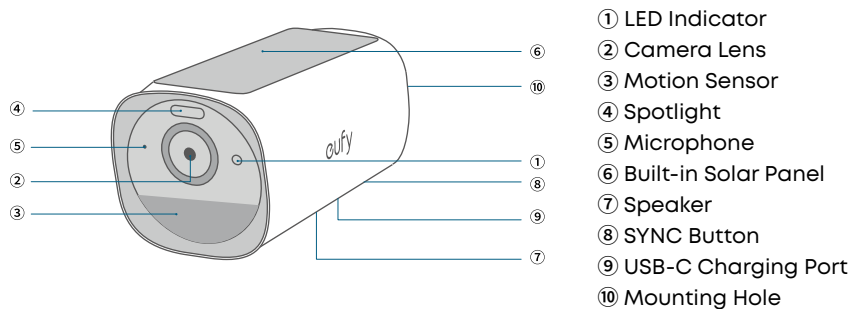

HomeBase 2 (T8010)

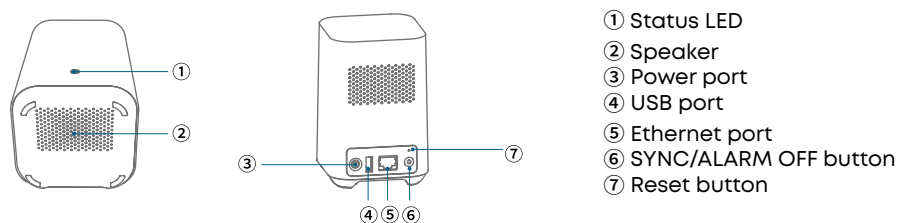

HomeBase S380 (T8030)

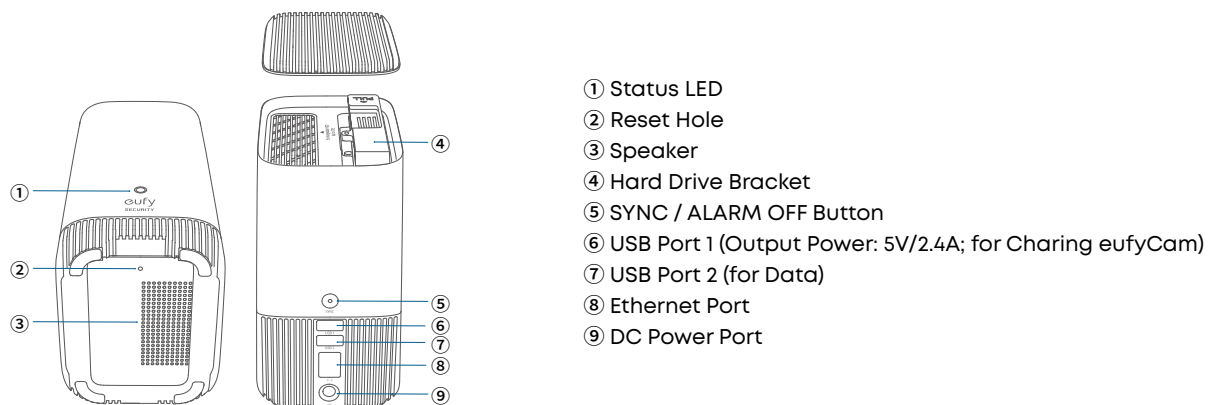

Before Mounting

For HomeBase 2

1. Download eufy App

Download and install the eufy app, then sign in or create an account.



If you already have the app, please ensure it is updated to the latest version.

2. Add HomeBase

Follow the in-app instructions to add HomeBase.

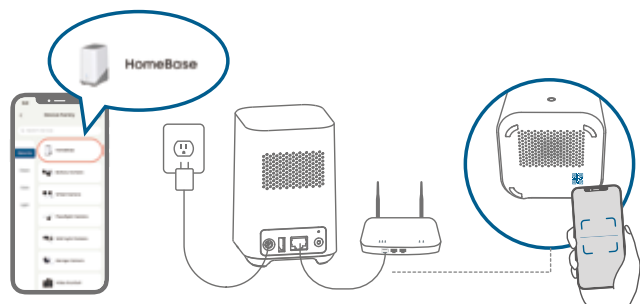
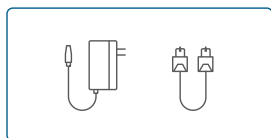

1

2

3

3. Add Cameras

Follow the in-app instructions to add cameras and sync them with HomeBase.

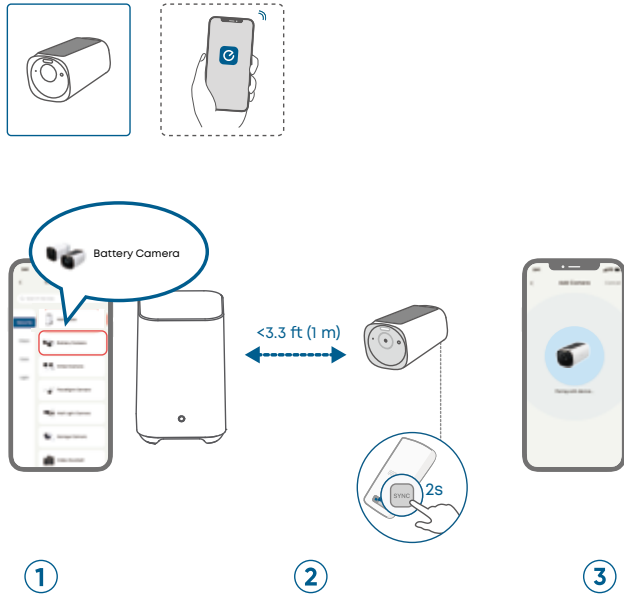

4. Fully Charge the Cameras

Fully charge the cameras before first use. This may take up to 8 hours for each camera.

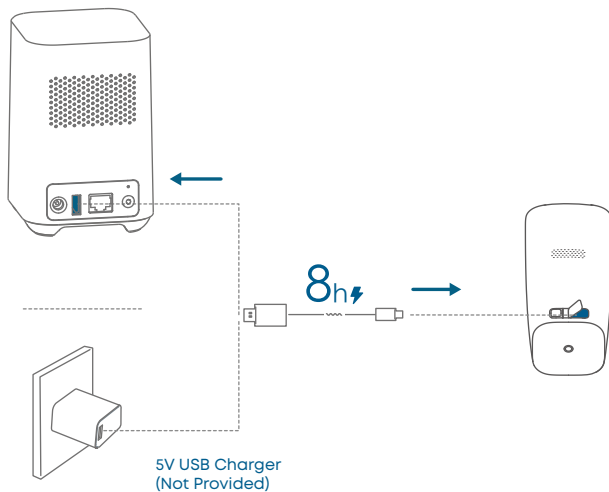

You can check the battery level in the app.

5. Check Wi-Fi Signal

Take the camera and your phone to the desired mounting location to test the Wi-Fi signal strength.

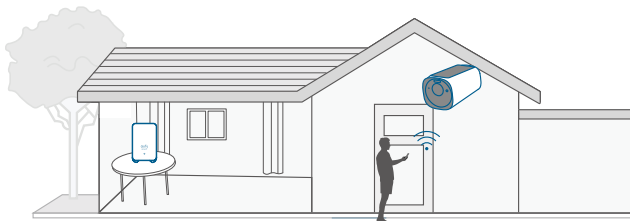

For HomeBase S380

1. Download eufy App

Download and install the eufy app, then sign in or create an account.



If you already have the app, please ensure it is updated to the latest version.

2. Add HomeBase

Follow the in-app instructions to add HomeBase.

1

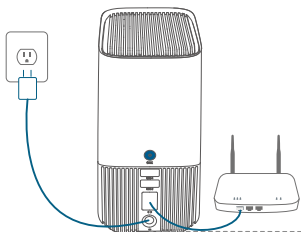

2

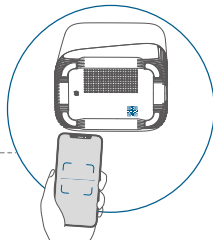

3. Add Cameras

Follow the in-app instructions to add cameras and sync them with HomeBase.

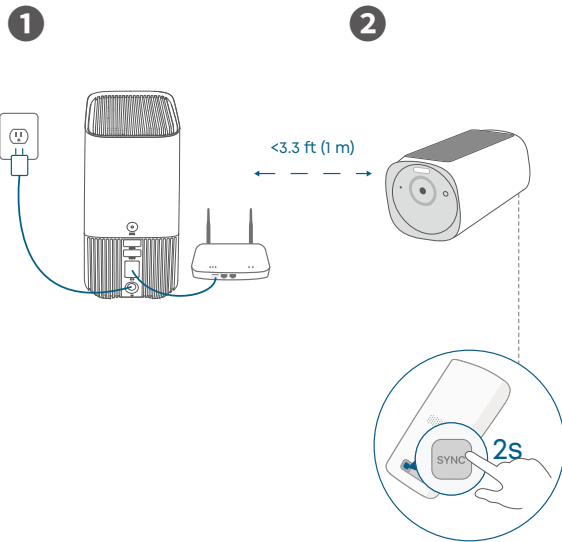

4. Fully Charge the Cameras

Fully charge the cameras before first use. This may take up to 8 hours for each camera.

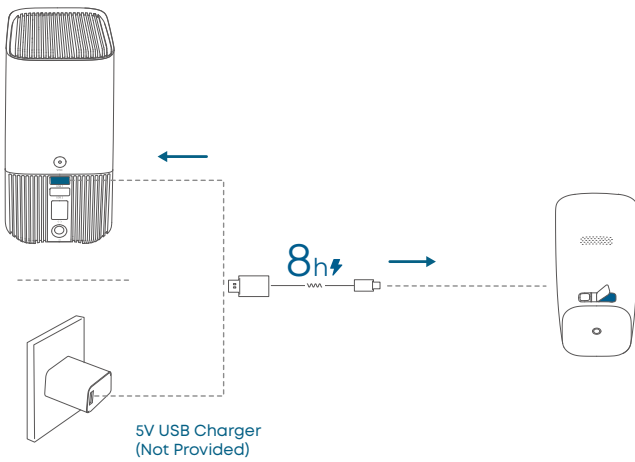

 You can check the battery level in the app.

5. Check Wi-Fi Signal

Take the camera and your phone to the desired mounting location to test the Wi-Fi signal strength.

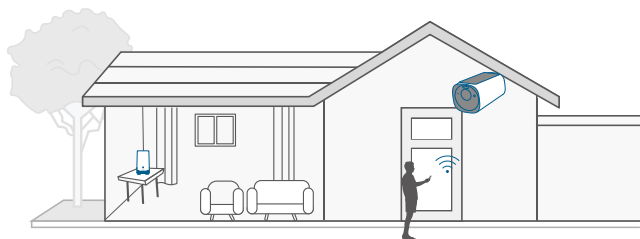

Mounting Your eufyCam

1. Choose a Location

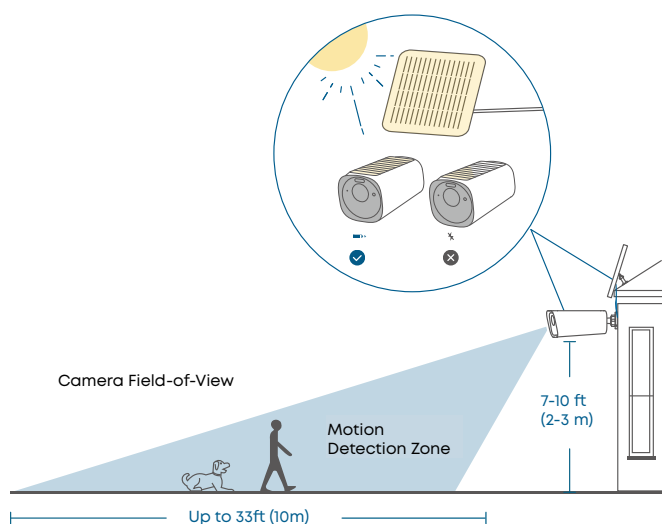

You may need a screwdriver, a 1/64" (6mm) drill, and a ladder.

2. Position & Drill Holes (for Concrete or Brick Wall)

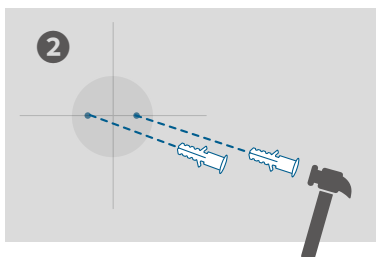
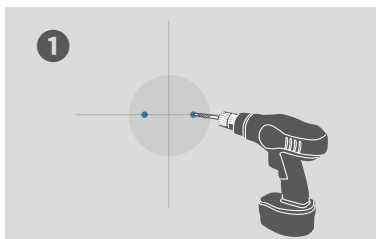

 Skip this step if you are installing it on a wooden wall.

3. Install the Mounting Base

Rotate the knob on the mounting bracket to loosen and disassemble, then firmly install the mounting base using the 2 long screws provided.

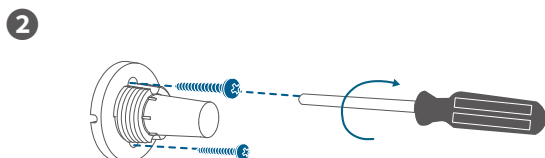
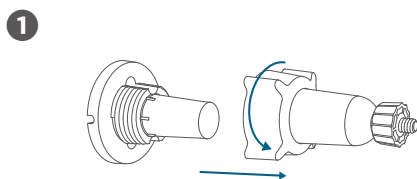

4. Mount the Camera

Attach the mounting bracket to the base by turning the large knob clockwise. Hold and screw the camera onto the bracket, then turn the small knob to secure.

⚠ Do not remove the protective film during installation.

1

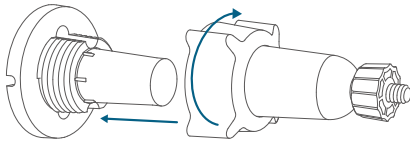

2

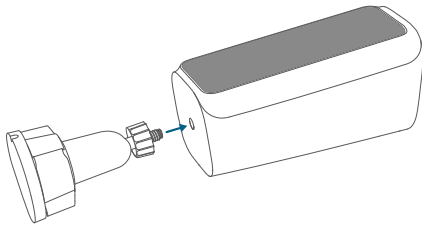

5. Adjust the Camera Field of View

Rotate the camera to get an optimal angle when viewing the live stream in the eufy app.

1

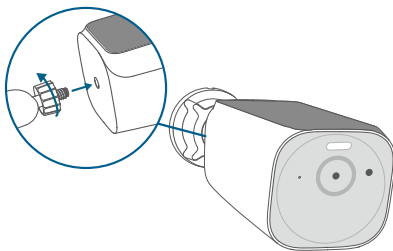

2

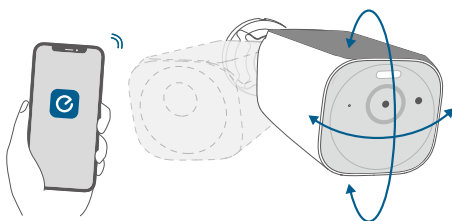

6. Tighten the Camera and Complete

Turn the large knob to tighten and secure the camera.

1

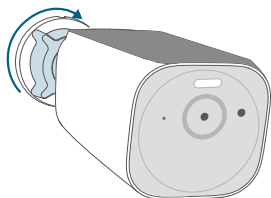

2

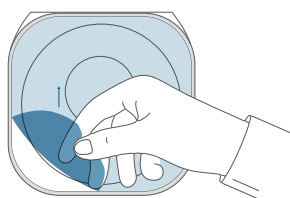

⚠ Remove the protective film before use.

Mounting Backup Solar Panel

If you need to install the camera in areas with insufficient sunlight (such as under the eaves), please use the backup solar panel, which works in conjunction with the built-in solar panel.

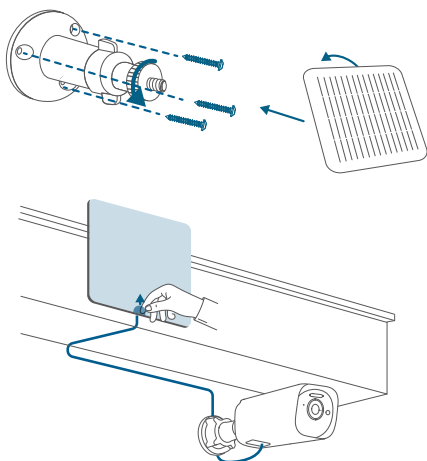
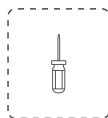

⚠ Remove the protective film before use.

Congratulations!



Now you're all set to use your eufyCam!

Please explore more in the eufy app.

Default Open Port 1: Wi-Fi (2.4GHz)

Port Description:

1. When powered on for the first time or after a reset, if there is no configured Wi-Fi information, it may enter network pairing mode (such as AP/BLE pairing);
2. In normal working mode, it will automatically connect to the router and save the SSID and password;
3. If you need to switch Wi-Fi configuration, you can use the App or follow the instructions in the manual to reconfigure the network.
4. TCP monitors Port 15250, and is used for connecting HomeBase.