

eufy

QUICK START GUIDE

eufy Smart Display E10



For User Manual



SETTING UP THE SYSTEM

1. Download and install the eufy Security app, then sign up for an account.



- 2. Press and hold the power button for 3 seconds to power on the Smart Display.
- 3. Connect the Smart Display to a Wi-Fi network.
- 4. Sign in with your eufy account or with a login QR code.
- 5. Follow the on-screen instructions to complete the setup.

For online support, tutorial videos, FAQs, and more information, please visit <http://support.eufy.com/s/>.



Scan the QR code to read the detailed user guide.



OVERVIEW

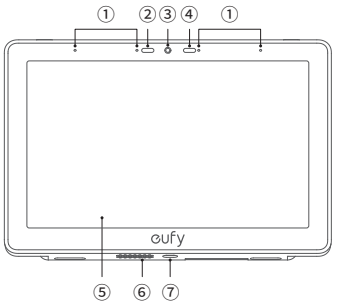

- 1 Microphones
- 2 Proximity Sensor
- 3 Low Battery Indicator Light
- 4 Light Sensor
- 5 Touchscreen
- 6 Speaker
- 7 Charging Pins

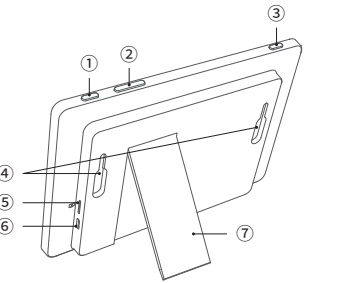

- 1 Power Button
- 2 Volume Up / Down Button
- 3 Alarm Button
- 4 Mount Slots
- 5 MicroSD Card Slot
- 6 Charging Port
- 7 Folding Bracket

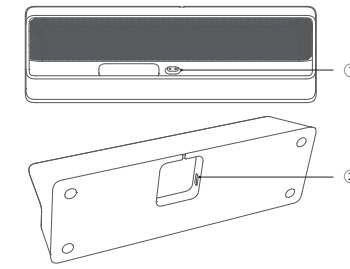

- Charging Dock
- 1 Charging Pins
- 2 Power Port

WALL MOUNT

Adjust the Wall Mount Position with the Bubble Level

Adjust the position of the wall mount with the bubble level before you stick it to the wall or drill holes on the wall.

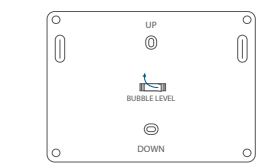

1

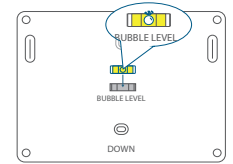

2

Option 1: 3M Stickers

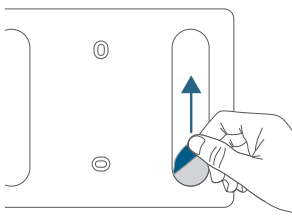

1

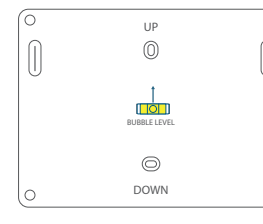

2

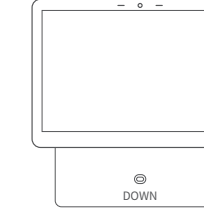

3

Option 2: Anchors and Screws

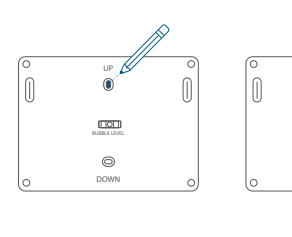

1

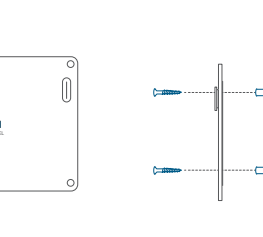

2

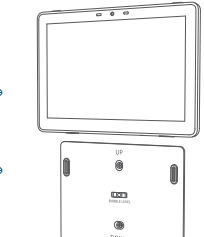

3

Fix the Cable Holder

Use the cable holder if necessary. Fix the cable holder with the 3M sticker or an expansion screw.

1

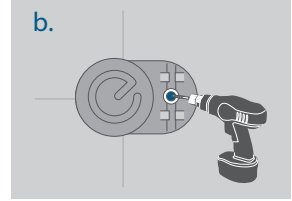
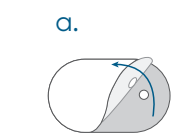

2

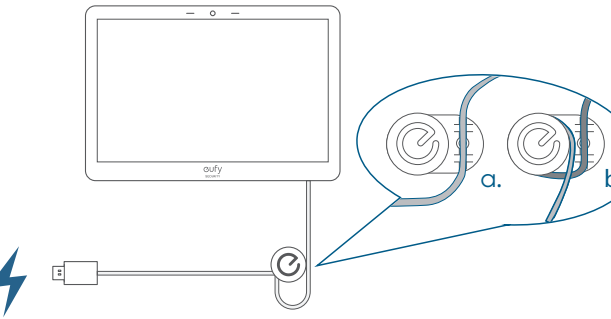

SPECIFICATIONS

Items	Parameters	eufy Smart Display E10
Mechanical	Dimensions	5.47"H x 7.91"W x 0.65"D (139mm x 201mm x 16.5mm)
LCD Display	Size	8 inch LCD
	Resolution	1280(RGB) x 800 pixels
	Brightness	250 cd/m²
	RGB Color	24bit, 16.7 Million Colors
Touchscreen	Type	Capacitive glass multi-touch
Network	WiFi	Support 2.4GHz/5GHz Wi-Fi6
Flash Memory	Internal Storage	8GB EMMC Flash
	External storage	Supports up to 512GB microSD card
LED Indicator	Low Battery Indicator	Red Ring LED
Speaker/Siren	2.5W x 1	65-decibel siren at a distance of 3 meters (10 feet)
Microphone	MEMS x 4	4 MEMS (Micro-Electro-Mechanical System)

Battery	Model: T87A0	Rechargeable Lithium Ion available 4900mAh Rated for over 24 hours
	Pass-Through Charging	Supports long-term charging without damaging battery life
Power Supply	DC	5V DC 2000mA CC, Input 100-240VAC 50/60Hz Adpater

NOTICE

- The recommended temperature range for devices and accessories is 0°C to 40°C (32°F to 104°F).
- Unless specifically indicated that it is safe to do so in the user guide or instruction manual, do not use this device in an environment that exceeds the recommended low or high temperature.
- Unless specifically indicated that it is safe to do so in the user guide or instruction manual, avoid exposing your device to direct sunshine or excessively wet environments.
- It is recommended to supply the device in an environment with a temperature that ranges from 5°C to 25°C (41°F to 77°F). .
- When charging, please place the device in an environment that has a normal room temperatureand good ventilation.
- For pluggable equipment, the socket-outlet shall be easily accessible.
- Please ensure to use only the adapter offered by the manufacturer. Using unauthorized adapter may cause danger and violate the authorization of the device and the guarantee article.

FCC Statement

- This device complies with Part 15 of the FCC Rules. Operation is subject to the following two conditions: (1) this device may not cause harmful interference, and (2) this device must accept any interference received, including interference that may cause undesired operation.
- Warning: Changes or modifications not expressly approved by the party responsible for compliance could void the user's authority to operate the equipment.
- Note: This equipment has been tested and found to comply with the limits for a Class B digital device, pursuant to Part 15 of the FCC Rules. These limits are designed to provide reasonable protection against harmful interference in a residential installation.
- This equipment generates uses and can radiate radio frequency energy and, if not installed and used in accordance with the instructions, may cause harmful interference to radio communications. However, there is no guarantee that interference will not occur in a particular installation. If this equipment does cause harmful interference to radio or television reception, which can be determined by turning the equipment off and on, the user is encouraged to try to correct the interference by one or more of the following measures: (1) Reorient or relocate the receiving antenna. (2) Increase the separation between the equipment and receiver. (3) Connect the equipment into an outlet on a circuit different from that to which the receiver is connected. (4) Consult the dealer or an experienced radio/TV technician for help.

FCC Radio Frequency Exposure Statement

This device meets the government’s requirements for exposure to radio waves. The exposure standard for wireless device employs a unit of measurement known as the Specific Absorption Rate, or SAR. The SAR limit set by the FCC is 1.6W/kg. Tests for SAR are conducted using standard operating positions (0mm) accepted by the FCC with the device transmitting at its highest certified power level in all tested frequency bands. The highest reported SAR value for your device is: 0.444 W/kg

Operation of this device in the band 5150-5250 MHz is restricted to indoor use only.

Le fonctionnement de cet appareil dans la bande 5150-5250 MHz est limité à une utilisation en intérieur uniquement.

Notice: Shielded cables
All connections to other computing devices must be made using shielded cables to maintain compliance with FCC regulations.

The following importer is the responsible party:
Company Name: POWER MOBILE LIFE, LLC
Address: 10900 NE 8th St, Ste 501, Bellevue WA 98004
Telephone: 1-800-988-7973

CUSTOMER SERVICE

12-month limited warranty

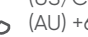

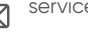

(US/Canada) +1 (800) 988 7973
(AU) +61 3 8331 4800



support@eufy.com
service@myeufy.com.au (AU)

@EufyOfficial

@EufyOfficial

@EufyOfficial



Anker Innovations Limited. All rights reserved, registered in the United States and other countries.

Anker Innovations Limited
Unit 56, 8th Floor, Tower 2, Admiralty Centre, 18 Harcourt Road, Hong Kong



Model: T87A0
51005004875_V2