

At a Glance

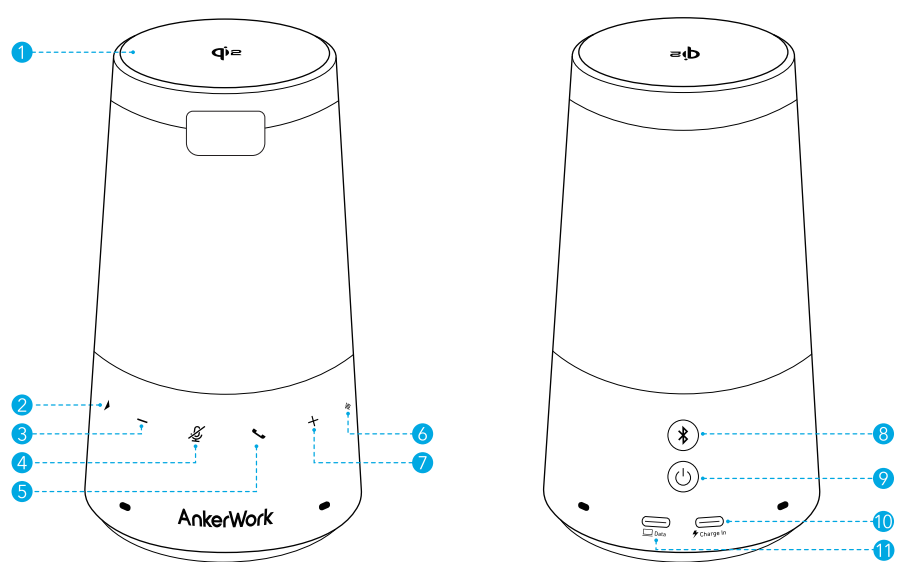

1	Wireless Charging Pad	7	Volume Up Button
2	Multi-function Button	8	Bluetooth Button
3	Volume Down Button	9	Power Button
4	Mute Button	10	USB-C Port (Charge In)*
5	Phone Call Button	11	USB-C Port (Data)*
6	Voiceprint Button		

* Both USB-C ports can be used to transfer data and to charge this product, but charging via the USB-C port (Data) is not recommended due to the limited input power.

AnkerWork Software / App

Download the AnkerWork software or app to enhance your experience.

software.ankerwork.com

DOWNLOAD CENTER

software

APP

Designed to optimize and Personalize your AnkerWork Products.

Supported Devices >

Download for Windows PC V2.5.7

Download for macOS V2.5.7

*For Windows 7/8/10 and above

*For mac 10.14 and above

(The firmware updates is not supported for Windows 7/8)

AnkerWork

9:41

AnkerWork S600

4 Voiceprint Recognition

Enhance and highlight your voice in the meeting and reduce other vocal distractions

Create VoicePrint

Device

Note

Solution

Messages

- Check product information
- Read user manual
- Check the battery level
- Check the latest software updates

- Adjust volume
- Set auto-power off
- Set voice pickup modes
- Manage your own voiceprint

Powering On/Off

Press and hold the power button for 2 seconds to power on or off.

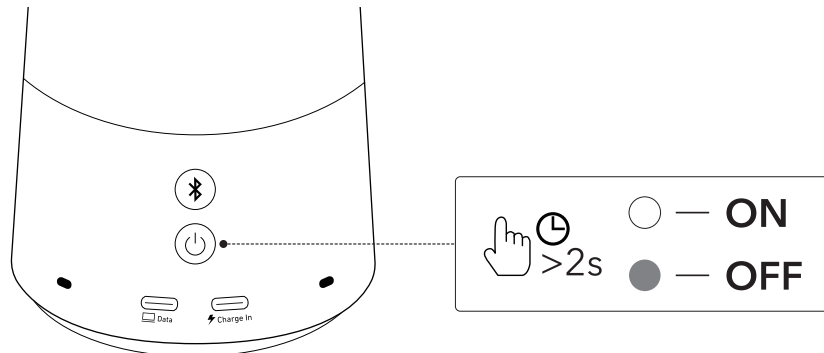

- The speakerphone will automatically power on once connected to your PC using the USB-C cable.
- The speakerphone will automatically power off after 15 minutes if there is no signal input or output.

Connecting

Plug-and-Play

- Connect to your PC via the USB-C port (Data) using a USB-C cable.
- Once connected to your PC, the speakerphone will automatically power on.

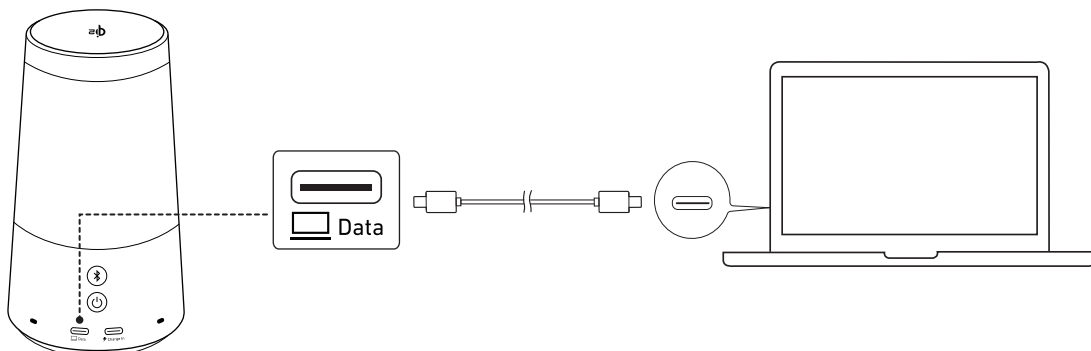

Bluetooth Pairing

Press the Bluetooth button on the back to enter Bluetooth pairing mode, then select "**AnkerWork S600 Speakerphone**" from the Bluetooth list to connect.

- Each time you power on the product, it will automatically connect with the last successfully connected device if available.

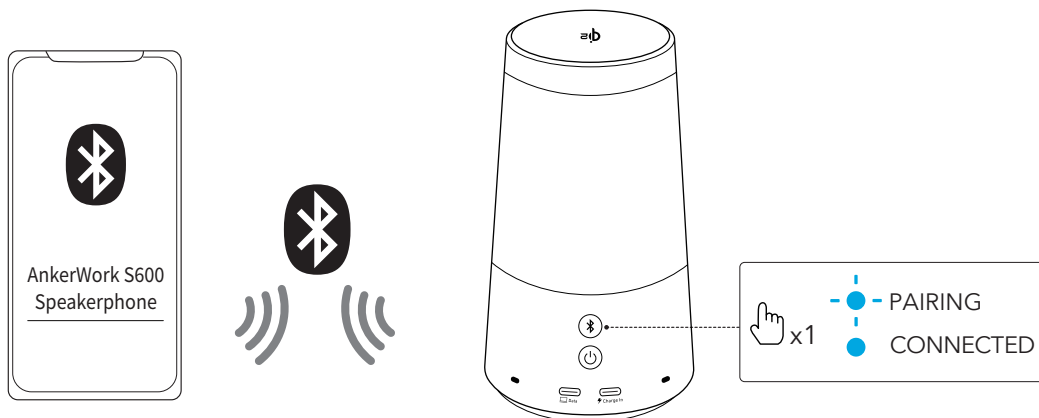

Voiceprint Recognition

Create or delete your voiceprints in the AnkerWork app.

To create your voiceprint, tap [Create Voiceprint] > [Start] and speak into the speakerphone.

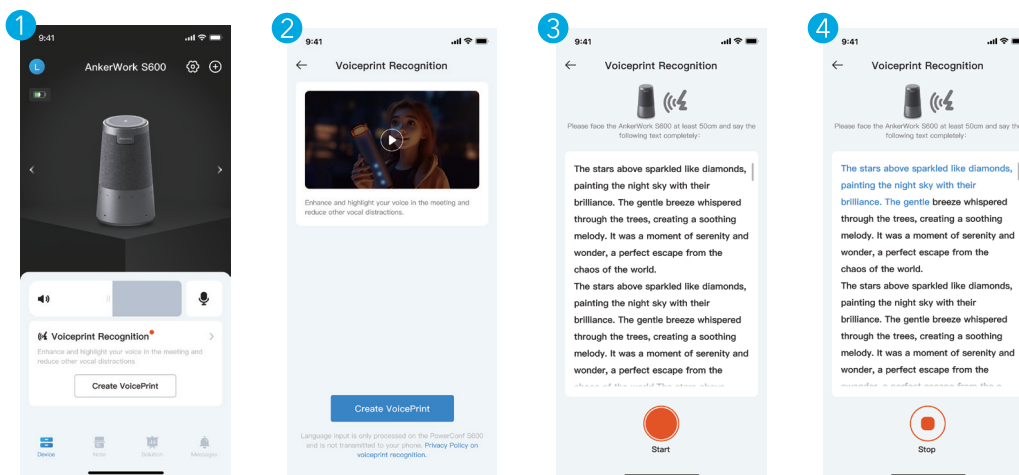

	Turns Green	Voiceprint On
	Turns White	Voiceprint Off
	Flashes White Three Times	Voiceprint Not Recorded

Wireless Charging

To enable or disable wireless charging, press the power button twice.

- Use a magnetic phone case for better charging performance.
- If the battery level is less than 5%, it will not offer to charge.

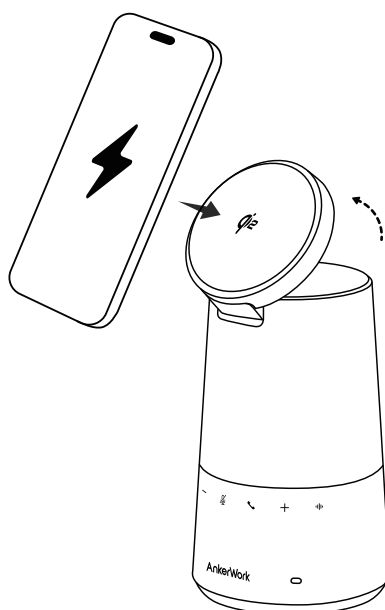

Charging Your Speakphone

Charge this product via the USB-C (Charge In) port.

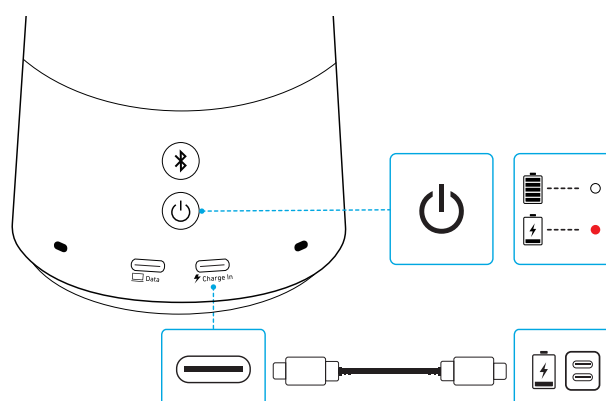







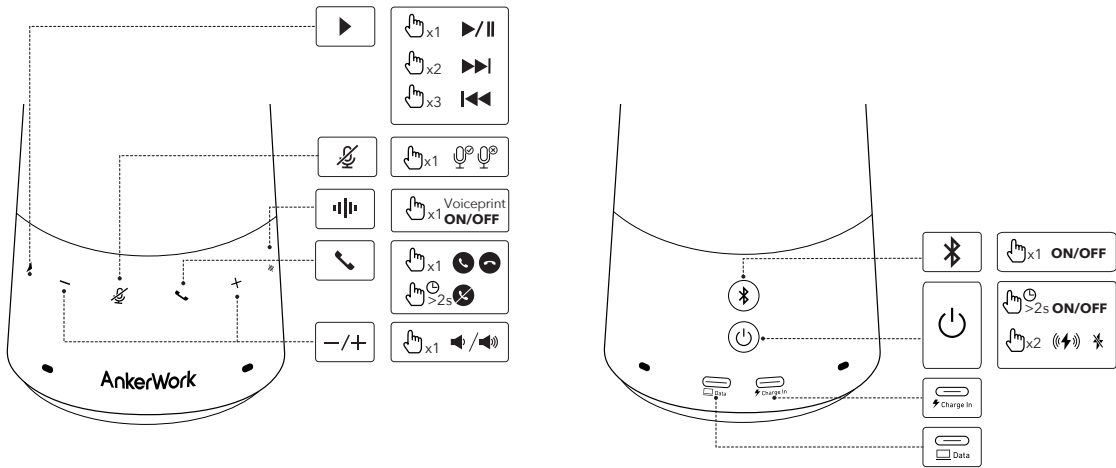

Check Battery Level

When powered on, press the power button to check the battery level.

	Power LED	Battery Level
	Steady White	>20%
	Steady Red	<20% (Plugged to power)
	Flashing Red	<20% (Unplugged)

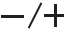
Button Controls



	Press and hold for 2 seconds	Power on or off
	Press	Check the battery level when powered on
	Press twice	Enable / Disable wireless charging
	Press	Enter / Exit Bluetooth pairing mode
	Press	Answer / End a call
	Press and hold for 2 seconds	Reject a call
	Press or press and hold for 2 seconds	Increase / Decrease volume level
	Press	Mute or unmute the microphone
	Press	Play or Pause music
	Press	Activate Voiceprint recognition

Ring Light

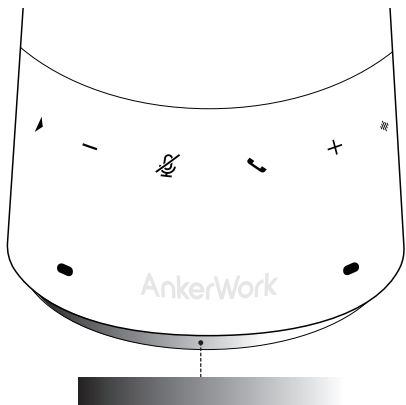

Connected to a PC	○	White
Press the power button to check battery level	●	Green (Battery level >20%)
	●	Red (Battery level <20%)
Sound Detected	●	Blue
Bluetooth Pairing	●	Blue
Press the mute button to mute the microphone	●	Red

Specifications

- Specifications are subject to change without notice.

Input (Charge In)	9V=3A, 15V=2A, 20V=1.5A
Input (Data)	5V=2A
Output (Wireless Charging)	15W Max
Battery Capacity	3100mAh / 7.2V
Charging Time	4 Hours
Talktime	16 Hours
Driver Size	1 x 1.75" (full range)
Microphone	4 Microphones
Microphone Frequency Response	50 Hz - 20 kHz
Bluetooth Version	V 5.3
Bluetooth Range	50 m / 164 ft

Hereby, Anker Innovations Limited declares that this device is in compliance with The Product Security and Telecommunications Infrastructure (Security Requirements for Relevant Connectable Products) Regulations 2023. For the Statement of Compliance, visit the website:
<https://uk.ankerwork.com/psti-related>.

Note: The 'x' of SN Code: xxxxxxxxxxxxxxxx is a variable, see below table.

Variable 'x'	Range of variable	Content
Seventh	0-9 or A-F	Denotes the hardware version which is not effected on the safety compliance.
Eighth	8,9,A,B,C...	Denotes the year, 8 means 2018, 9 means 2019, A means 2020, B means 2021, C means 2022, and so on.
Ninth and tenth	01,02,03...	Denotes weeks, 01 means the first week in this year, 02 means the secondary week in this year, and so on.
Eleventh	1-7	Denotes date, 1 means Monday, 2 means Tuesday..., 7 means Sunday and so on.
The last five	00001-99999	Denotes serial No.

1. Power consumption in standby mode: $\leq 0.5W$
2. Power consumption in networked standby mode: $\leq 2W$
3. Power consumption in networked standby mode that all wired network ports are connected and all wireless network ports are activated: $0.27W$
4. Power management: $\leq 20min$
5. Information of applicable adapter:

Brand: ANKER

Manufacturer: Anker Innovations Limited

Model: A2337

Input: 100-240V~ 1.0A, 50-60Hz

Output: 5.0V=3.0A 15.0W / 9.0V=3.0A 27.0W / 12.0V=2.5A 30.0W / 15.0V=2.0A 30.0W / 20.0V=1.5A 30.0W (30.0W Max)

Average Active Efficiency: 85.42%

Efficiency at Low Load (10%): 74.56%

No-Load Power Consumption: 0.06W

Default Open Port: Classic Bluetooth

Port Description: After the device is powered on, Classic Bluetooth visibility (or pairing mode) is automatically enabled, providing Bluetooth pairing (or control) services. The Bluetooth service is disabled when the device is powered off.