



©Anker Innovations Limited. All rights reserved, registered in the United States and other countries.

Model:T8410  
51005005660\_V1

eufy

# QUICK START GUIDE

Indoor Cam E220

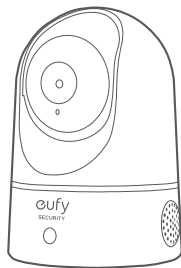

## Table of Contents

What's included	01
Product Overview	02
Setting up the System	03
Mounting the Indoor Cam	05
Powering on the Indoor Cam	09
Notice	11
Customer Service	15

## WHAT'S INCLUDED

Indoor Cam E220 × 1  
Model: T8410C  
Mounting Plate × 1  
USB Cable × 1  
USB Adapter × 1  
Mounting Screw Pack × 1  
User Manual × 1

## PRODUCT OVERVIEW

### Indoor Cam E220

---

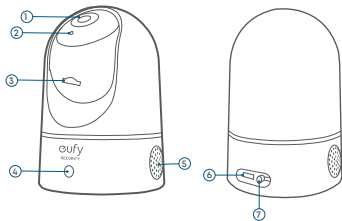

- 1 Lens
- 2 Microphone
- 2 SD card slot
- 4 Status LED

- 5 Speaker
- 6 Power input
- 7 SYNC button

## SETTING UP THE SYSTEM

1. Download the eufy app from the App Store (iOS devices) or Google Play (Android devices).



2. Sign up a eufy account. Go to the app homepage. Tap **Add Device**, and add the camera to your system.
3. Follow the on-screen instructions to complete the setup.

## LED Status

LED Status	Description
Breathing blue	Ready for setup
Solid blue	Powered on and working properly
Blinking red	Disconnected from the internet
Blinking red once	Motion or sound detected
Solid red	Working properly with someone viewing the live stream or recording event
Solid bluish violet	System is initializing
Flashing blue and red alternately	Firmware upgrade in progress

## MOUNTING THE INDOOR CAM

### Select a Location for Mounting

The camera can be placed on a table, shelf, or can be mounted on a wall or ceiling. Select a location and height where you can get the desired view, and can reach a power outlet easily.

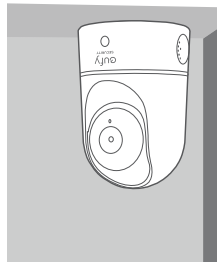
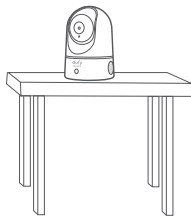



- Disconnect the Indoor Cam from the power outlet before mounting.
- Keep the eufy Indoor Cam at least 0.7 ft / 20 cm away from walls or anything that may obstruct the view. Do this to avoid infrared reflection which can have a negative impact on the night vision performance.

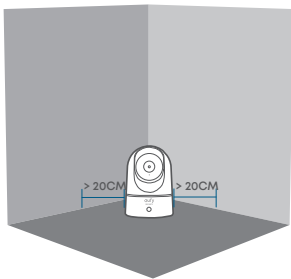

## Mount the Indoor Camera

To mount the eufy Indoor Cam on the ceiling, follow the steps below:

1. Place the positioning card against the ceiling and then mark the points at which drilling will be required.

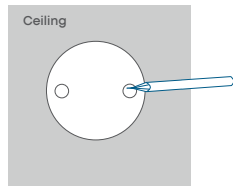

2. Drill holes with a 5/16" (8 mm) drill bit.

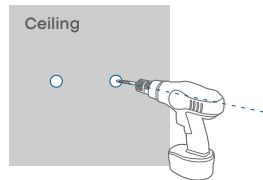

3. Align the holes on the mounting plate with those in the ceiling. Insert the anchors into the holes; anchors are necessary for walls that are made out of hard materials such as concrete, brick, or stucco. Fix the screws with a Phillips-head screwdriver to fasten the mounting plate to the ceiling.

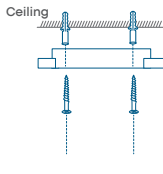

4. Align the grooves with the mounting plate and rotate the eufy Indoor Cam clockwise until it clicks into place.

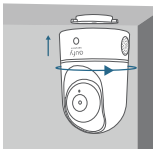

To mount the eufy Indoor Cam on a wall, we recommend using the mounting bracket (not provided) as the illustration below.

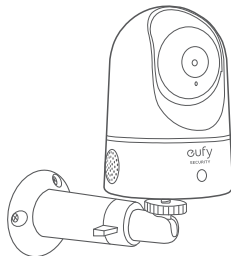

## POWERING ON THE INDOOR CAM

Connect the eufy Indoor Cam to a power outlet using the provided USB cable and USB adapter. After being powered on, the eufy Indoor Cam will be connected to

the system. When it is successfully connected, the status LED will turn solid blue.

Rotate the eufy Indoor Cam to adjust the view and check it using the live stream which you can access in the eufy Security app. You are now all set to use your eufy Indoor Cam.

### Tip:

For troubleshooting, check Help on the eufy Security app. Refer to the app page for LED indicator status.

Use of the Works with Apple badge means that an accessory has been designed to work specifically with the technology identified in the badge and has been certified by the developer to meet Apple performance standards. Apple is not responsible for the operation of this device or its compliance with safety and regulatory standards.

## Important Safety Instructions

- The recommended temperature range for devices and accessories is 0°C to 40°C (32 °F to 104 °F ).
- Unless specifically indicated that it is safe to do so in the

user guide or instruction manual, do not use the device in an environment that exceeds the recommended low or high temperature.

- Unless specifically indicated that it is safe to do so in the user guide or instruction manual, avoid exposing your device to direct sunshine or excessively wet environments.
- For pluggable equipment, the socket outlet should be easily accessible.
- Use only the adaptor provided by the manufacturer. Using unauthorized adapters may cause danger and violate the authorized use of the device or the warranty article.

## NOTICE

### FCC Statement

This device complies with Part 15 of the FCC Rules. Operation is subject to the following two conditions: (1) this device may not cause harmful interference, and (2) this device must accept any interference received, including interference that may cause undesired operation.

**Warning:** Changes or modifications not expressly approved by the party responsible for compliance could void the user's authority to operate the equipment.

**Note:** This equipment has been tested and found to comply with the limits for a Class B digital device, pursuant to Part 15 of the FCC Rules. These limits are designed to provide reasonable protection against harmful interference in a residential installation.

This equipment generates uses and can radiate radio frequency energy and, if not installed and used in accordance with the instructions, may cause harmful interference to radio communications. However, there is no guarantee that interference will not occur in a particular installation. If this equipment does cause harmful interference to radio or television reception, which can be determined by turning the equipment off and on, the user is encouraged to try to correct the interference by one or more of the following measures: (1) Reorient or relocate the receiving antenna. (2) Increase the separation between the equipment and receiver. (3) Connect the equipment into an outlet on a circuit different from that to which the receiver is connected. (4) Consult the dealer or an experienced radio/ TV technician for help.

### **FCC Radio Frequency Exposure Statement**

The device has been evaluated to meet general RF exposure requirements. The device can be used in fixed/ mobile exposure condition. The min separation distance is 20cm.

Notice: Shielded cables

All connections to other computing devices must be made using shielded cables to maintain compliance with FCC regulations.

The following importer is the responsible party

Company Name: POWER MOBILE LIFE, LLC

Address: 10800 NE 8TH ST #900, BELLEVUE, WA, 98004, UNITED STATES

Telephone:1-800-988-7973

### **IC Statement**

This device complies with Industry Canada licence-exempt RSS standard(s). Operation is subject to the following two conditions:

- (1) this device may not cause interference, and
- (2) this device must accept any interference, including interference that may cause undesired operation of the device.

Le présent appareil est conforme aux CNR d'Industrie Canada applicables aux appareils radio exempts de licence. L'exploitation est autorisée aux deux conditions suivantes:

- (1) l'appareil nedoit pas produire de brouillage, et



(2) l'utilisateur de l'appareil doit accepter tout brouillage radioélectrique subi, même si le brouillage est susceptible d'en compromettre le fonctionnement.

This Class B digital apparatus complies with Canadian ICES-003.

Cet appareil numérique de la classe B est conforme à la norme NMB-003 du Canada.

#### **IC RF Statement:**

When using the product, maintain a distance of 20cm from the body to ensure compliance with RF exposure requirements.

Lors de l'utilisation du produit, maintenez une distance de 20 cm du corps afin de vous conformer aux exigences en matière d'exposition RF.

Use of the Works with Apple badge means that an accessory has been designed to work specifically with the technology identified in the badge and has been certified by the developer to meet Apple performance standards. Apple is not responsible for the operation of this device or its compliance with safety and regulatory standards.

## **CUSTOMER SERVICE**

- **Warranty**

12-month Limited Warranty

- **Call Us**

(US) +1 (888) 3839-123

- **Email Us**

support.expert@eufy.com (US)

support.au.eufy.com (AU)



@EufyOfficial



@EufyOfficial



eufyofficial

Anker Innovations Limited

Unit 56, 8th Floor, Tower 2, Admiralty Centre, 18 Harcourt Road, Hong Kong