

## What's in the Box

### For Camera Installation

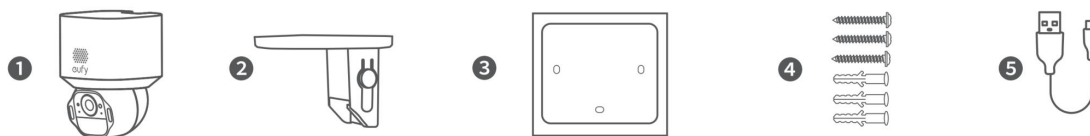

### For Solar Panel Installation



### Others



### For HomeBase Setup

\*Only available in kits with HomeBase.



- ❶ Camera
- ❷ Camera Mounting Bracket
- ❸ Positioning Sticker for Camera Mount
- ❹ Screw Pack (Camera)
- ❺ USB-C Charging Cable
- ❻ Solar Panel
- ❼ Solar Panel Mounting Bracket
- ❽ Positioning Sticker for Solar Panel Mount
- ❾ Screw Pack (Solar Panel)
- ❿ QSG
- ⓫ HomeBase S380
- ⓬ Ethernet Cable
- ⓭ Power Adapter
- ⓮ Reset Pin & Hard Drive Screw Pack

## Tools You Will Need

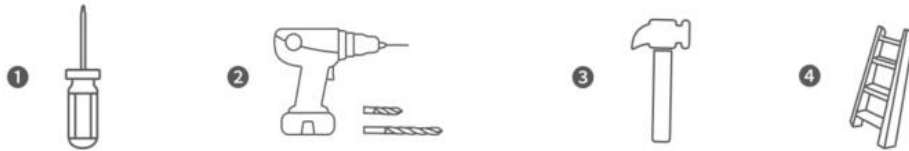

- ❶ Phillips Screwdriver
- ❷ Power Drill & Drill Bits
  - Pilot Holes: 1.5 mm (1/16 in)
  - Wall Anchors: 5.95 mm (15/64 in)
- ❸ Hammer
- ❹ Ladder

## At a Glance

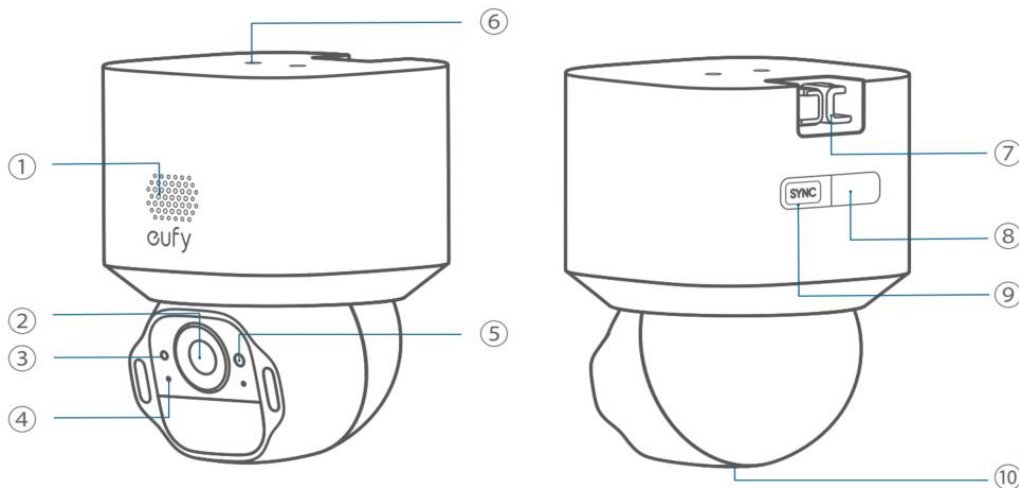

- ❶ Speaker
- ❷ Lens
- ❸ Photosensitive Sensor
- ❹ Microphone
- ❺ LED Indicator
- ❻ Solar Panel Mounting Hole
- ❼ Mounting Hook
- ❽ USB-C Charging Port
- ❾ SYNC Button
- ❿ microSD Card Slot

## Before Mounting

### 1. Download eufy App

Make sure your app is updated to the latest version.



### 2. Fully Charge the Cameras

Fully charge the cameras before first use.

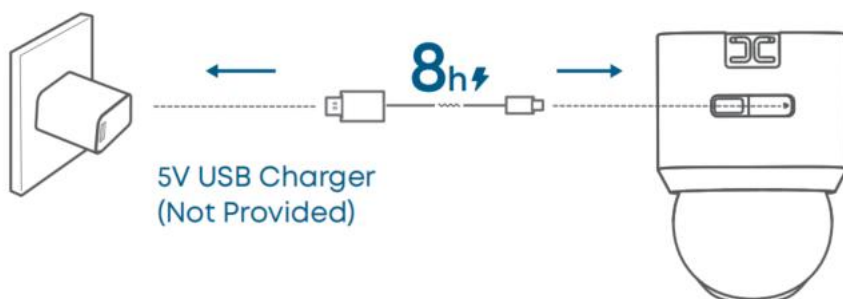

You can check the battery level in the app.

### 3. Add HomeBase (Optional)

Follow the in-app instructions to add HomeBase.

- ① Add HomeBase
- ② Connect
- ③ Scan via the app

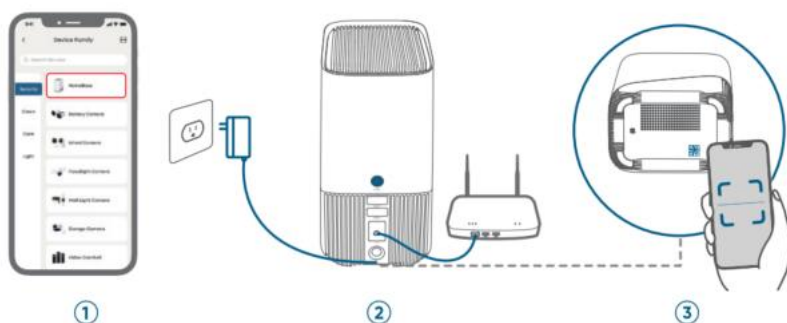

#### 4. Add Cameras

##### ① Add camera



##### ② Sync with HomeBase

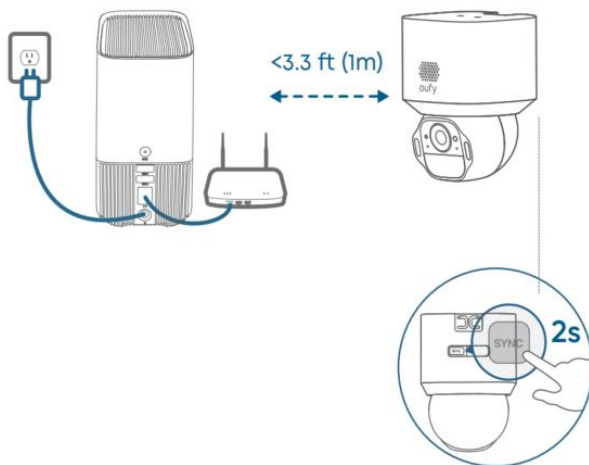

#### 5. Recheck in the App

Check before installation:

- Strong Wi-Fi signal
- Smooth live streaming



## 6. Choose a Location

Recommended location:

- Height of 2 m to 3 m (7 ft to 10 ft)
- Where solar panels get enough sunlight
- Strong Wi-Fi signal

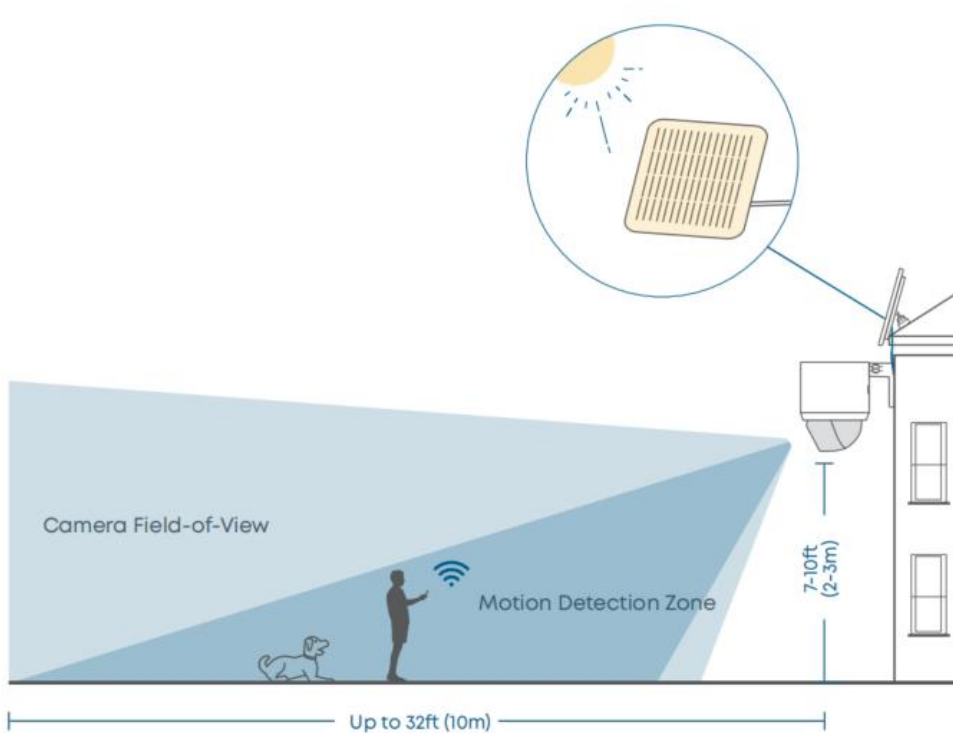

To avoid missed detections, install the cameras at an angle rather than directly facing the monitoring area.

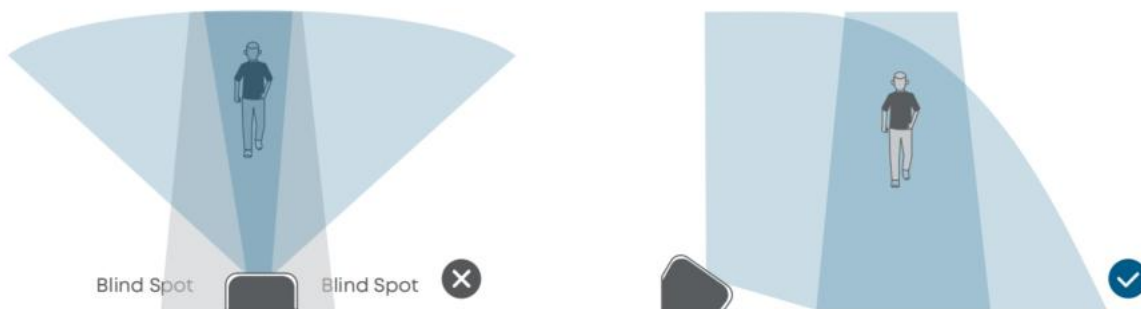

# Mounting the Solar Panel

## 1. Flexible Mounting (Best Sunlight)

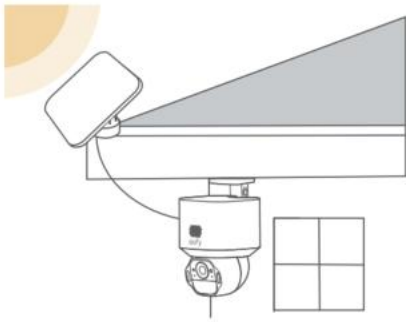

Top Mounting

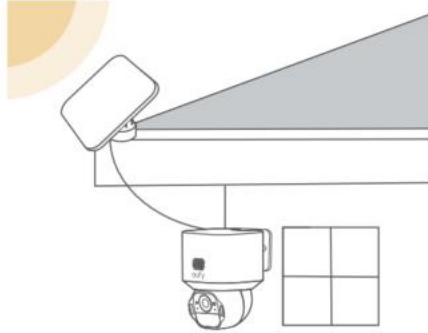

Wall Mounting

- ① Install the base
- ② Install the supporting piece
- ③ Screw the mounting bracket

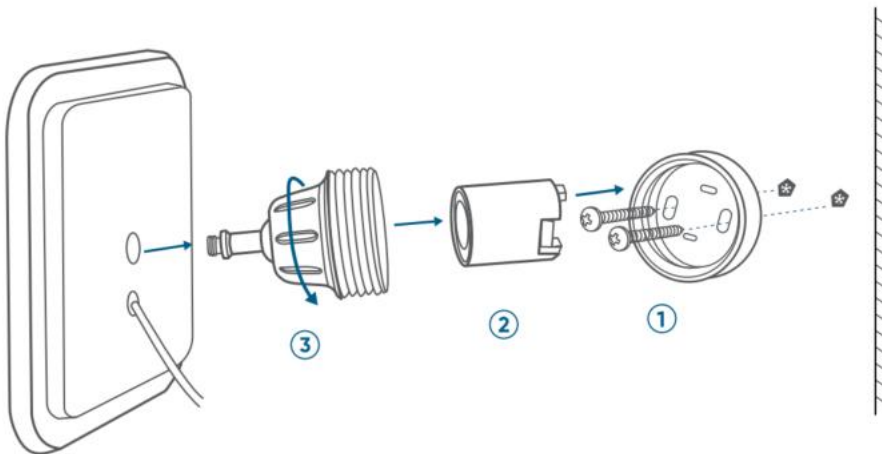

- ④ Connect the solar panel to the camera

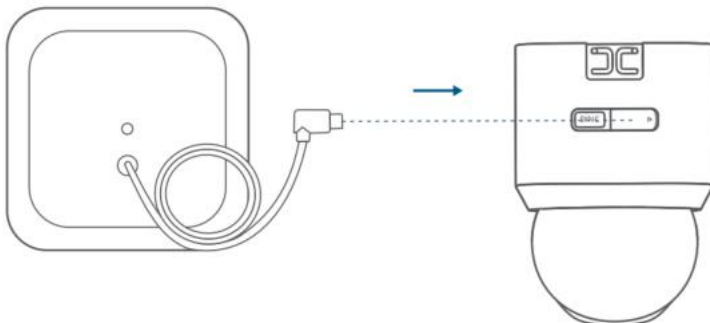

## 2. Integrated Mounting (Less Drilling)

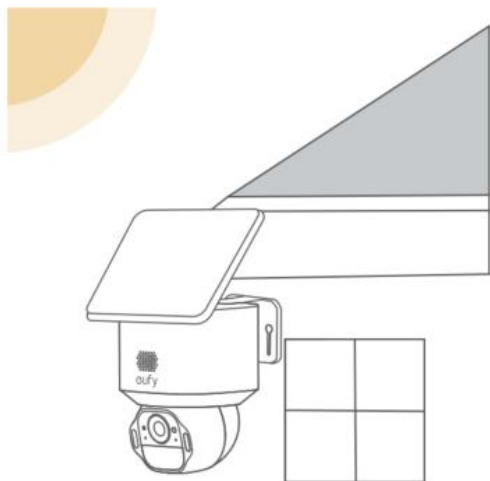

Wall Mounting Only

- ① Install the base
- ② Install the supporting piece
- ③ Screw the mounting bracket

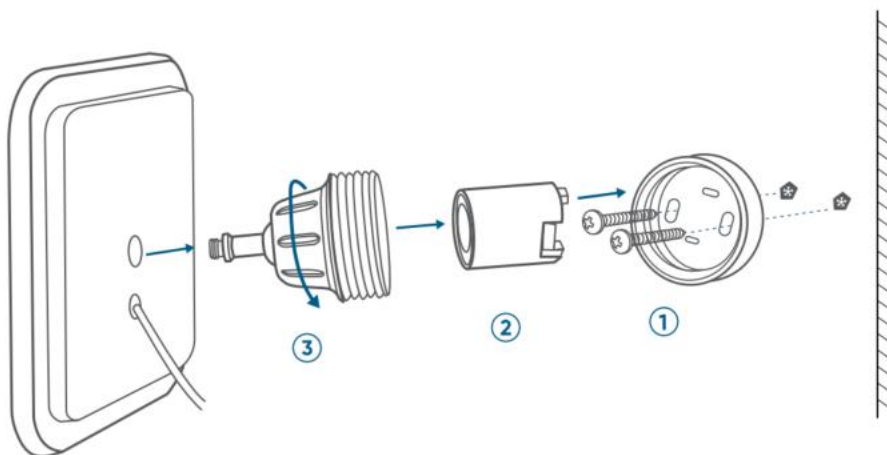

- ④ Connect the solar panel to the camera

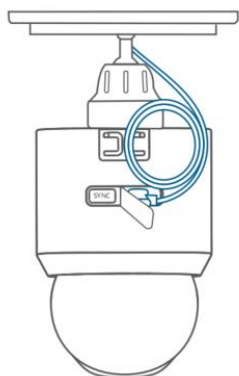

# Mount the Camera

## 1. Top Mounting

### ① Position & Drill holes

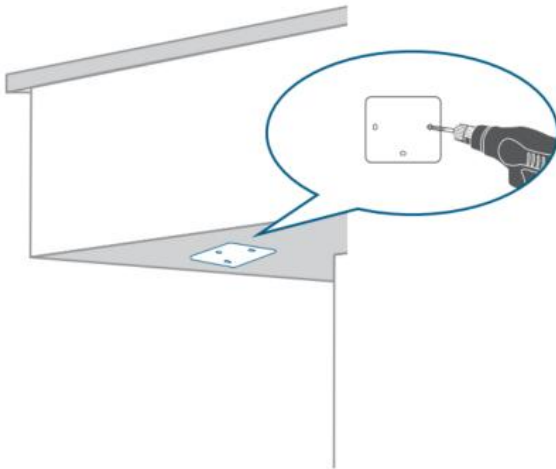

### ② Install the Mounting Bracket

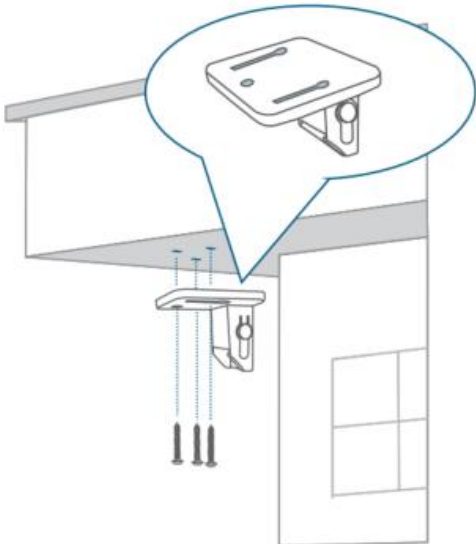

### ③ Insert the camera

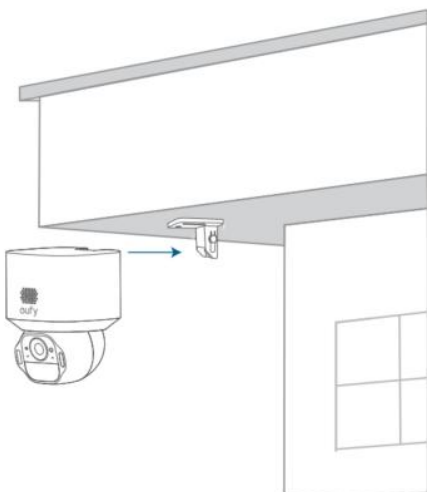



## 2. Wall Mounting

### ① Position & Drill holes

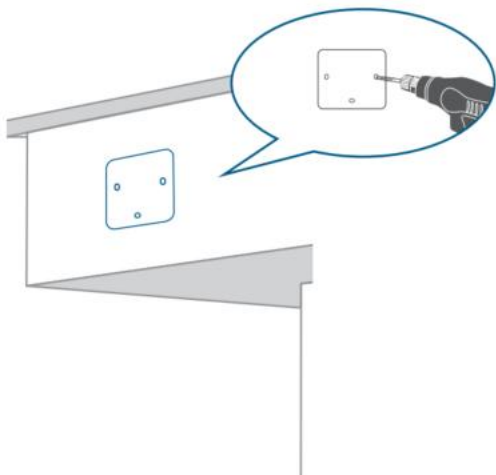

### ② Install the Mounting Bracket

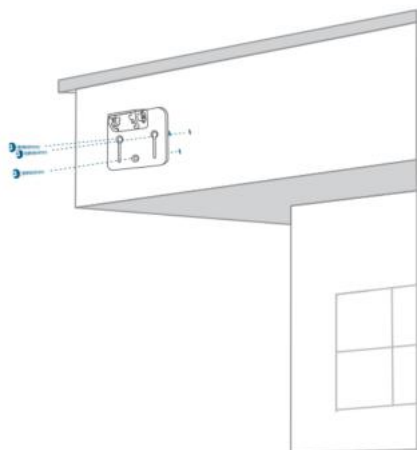

### ③ Insert the camera

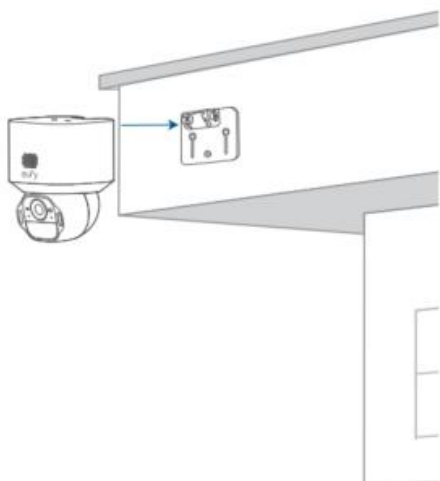

## After Mounting

### Adjust the Camera Field of View

- ① Remove the protective film

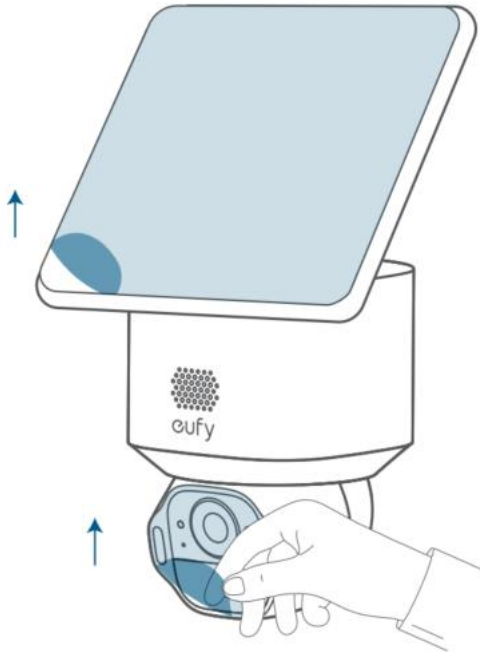

- ② Rotate the camera to the optimal angle

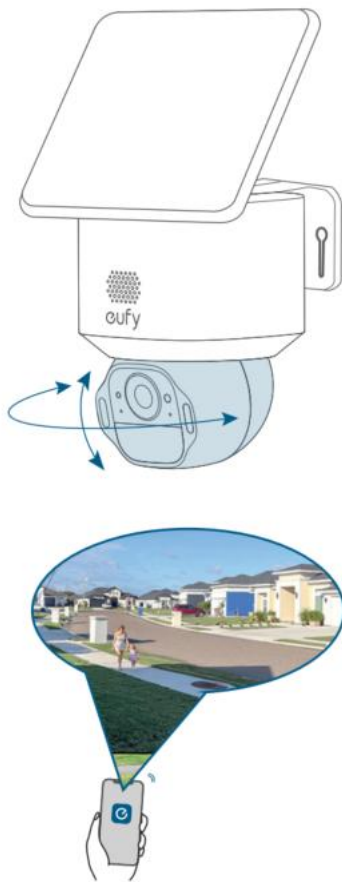

## Find Out More

Congratulations! Now you're all set to use your SoloCam E42!  
Please explore more in the eufy app.

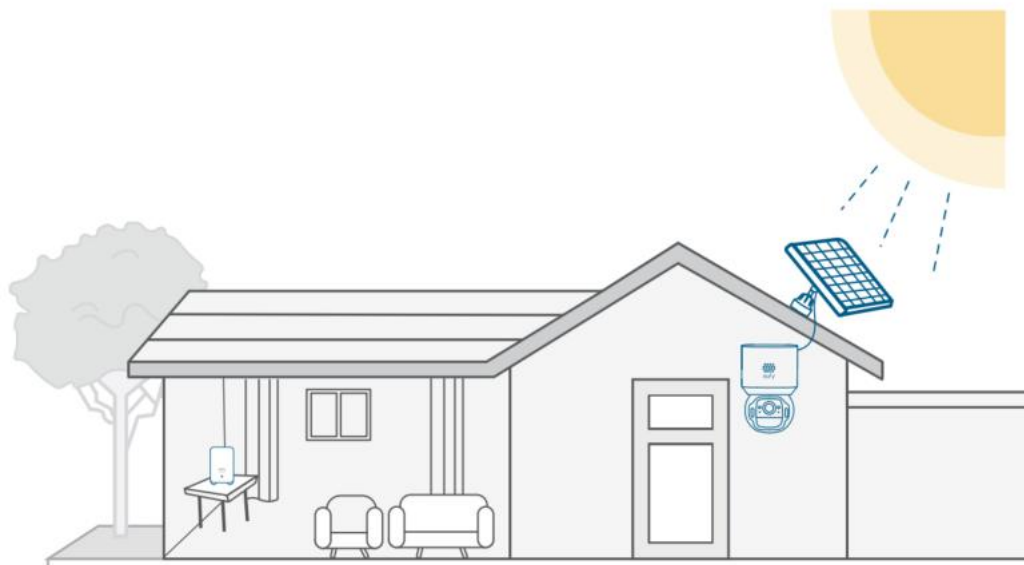

## Other Information

Default Open Ports: Wi-Fi (2.4GHz/5GHz)

Port Description:

1. Upon first power-on or after a reset, if no Wi-Fi information has been configured, the Wi-Fi will enter standby mode.
2. In normal operating mode, the device will automatically connect to the saved router SSID and password.
3. To switch Wi-Fi configurations, you can navigate to Settings -> WiFi or follow the instructions in the user manual to reset and reconfigure the network.