

APP

OVERVIEW

POWERING ON AND PAIRING

WEARING GUIDE

Check the Fit

How to Deep Clean Liberty Buds

DUAL CONNECTIONS

MANUAL PAIRING

CHARGING

CONTROLS

WEARING DETECTION

AMBIENT SOUND

AI TRANSLATION

Real-Time Translation

Face-to-Face Translation

LDAC

RESET

LED BEHAVIOR

Check the Battery Level

Charging

Bluetooth Connection

FIRMWARE UPDATE

SPECS

CUSTOMER SERVICE

APP

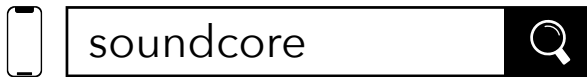

Google Play and the Google Play logo are trademarks of Google Inc.



Apple and the Apple logo are trademarks of Apple Inc.



Download the soundcore app to try out ambient sound modes, adaptive EQ settings, Spatial Audio, AI Translation, HearID sound, firmware updates, and more exciting features.

If your earbuds cannot connect to the soundcore app, try re-installing the app or updating it to the latest version available in your mobile app store.

OVERVIEW

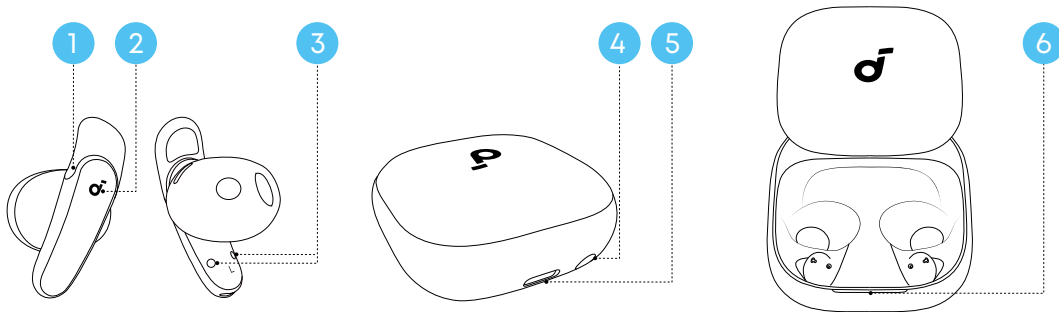

1. Ear Fin

- Size 2 ear fins come attached to the earbuds at the time of purchase.

2. Touch Control Area

- Tap the control area on the earbud stems to manage different functions.

3. Earbud Charging Contacts

4. Charging Case Button

5. USB-C Charging Port

6. LED Light Strip

POWERING ON AND PAIRING

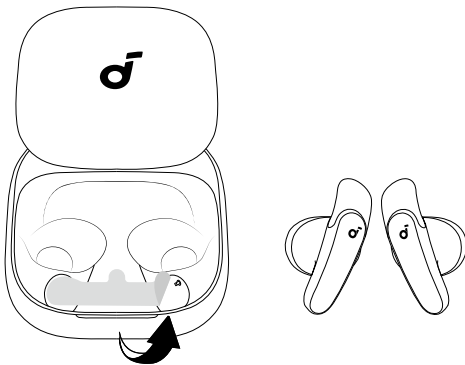

1. Remove the protective films from the earbuds.

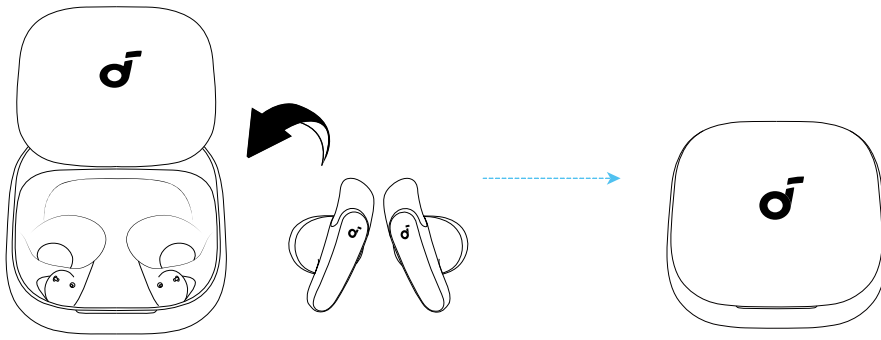

2. Place the earbuds back in the case and close the lid.

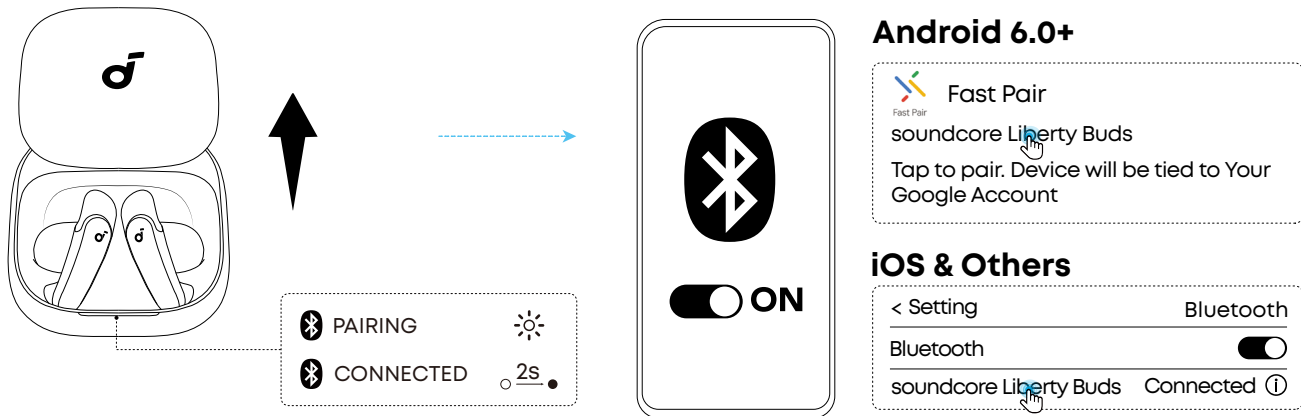

3. Open the case again to power on and enter pairing mode. Select "soundcore Liberty Buds" to connect. Once connected, the LED light strip will stay on for 2 seconds before turning off.

Google Fast Pair Supported: Enjoy instant pairing with your Android smartphone (running Android 6.0 or above) using Google Fast Pair.

WEARING GUIDE

Properly wearing your semi in-ear earbuds will provide a more comfortable and stable fit while ensuring optimal noise cancellation and sound quality.

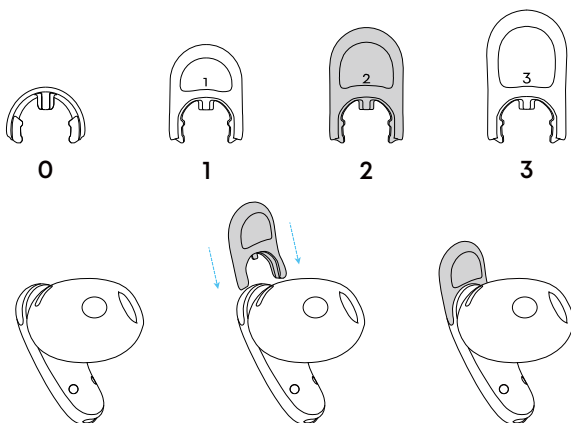

Try different ear fins for the optimal fit, comfort, and stability.



How to choose the right ear fins?

Start by wearing the pre-installed No. 2 ear fins. After wearing them properly:

- If the ear fins cause pressure or discomfort, switch to the No. 1 or No. 0 ear fins.
- If there is no proper contact and they feel loose or unstable, switch to the No. 3 ear fins.

Check the Fit

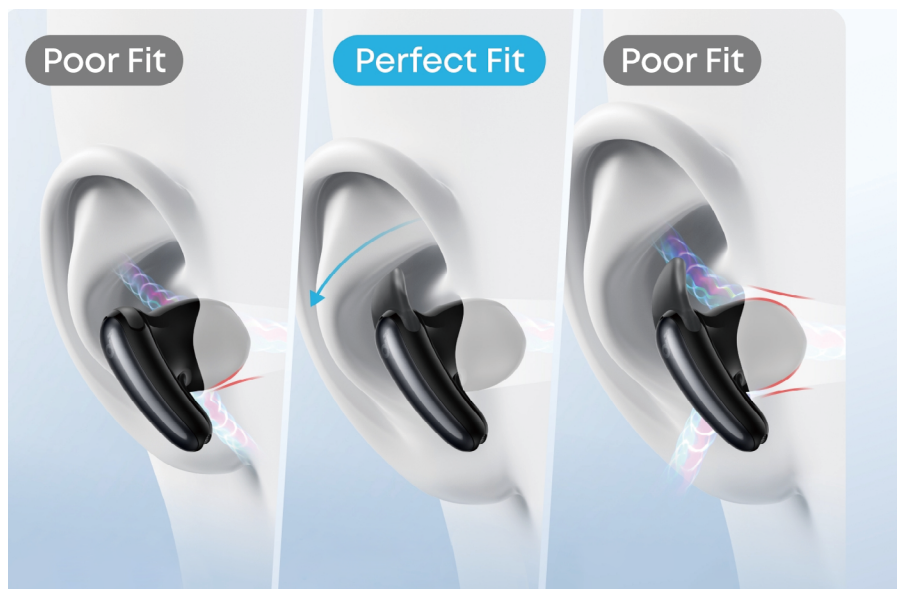

Poor Fit : If your ear or ear canal is small, noise cancellation performance may be impacted.

Perfect Ft : Achieved by changing the ear fin size and adjusting the angle for the best noise reduction performance.

Poor Fit : If your ear or ear canal is large, noise cancellation performance may be impacted.

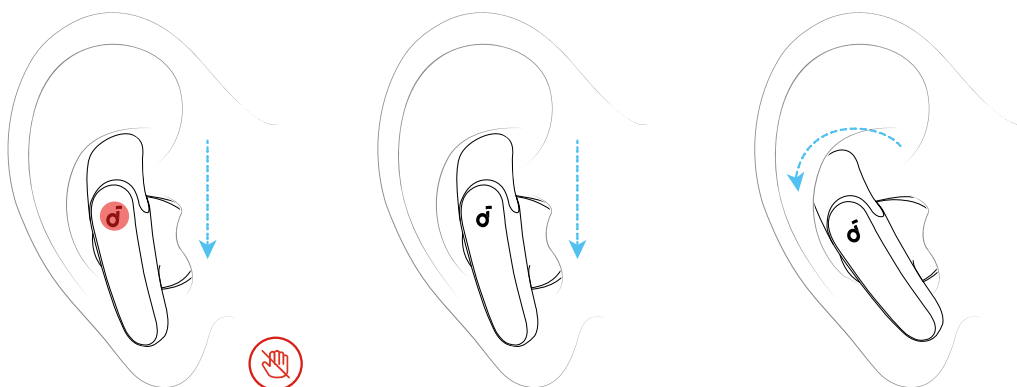

Gently place the earbuds into your ear canal and rotate them for a snug fit.



When wearing the earbuds, avoid touching the area near the logo to prevent accidental touches.

How to Deep Clean Liberty Buds

You will need alcohol wipes and a cleaning brush.

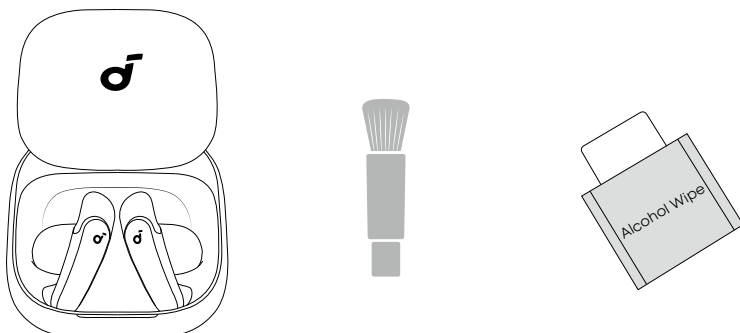

1. Prepare a cleaning brush and alcohol wipes.

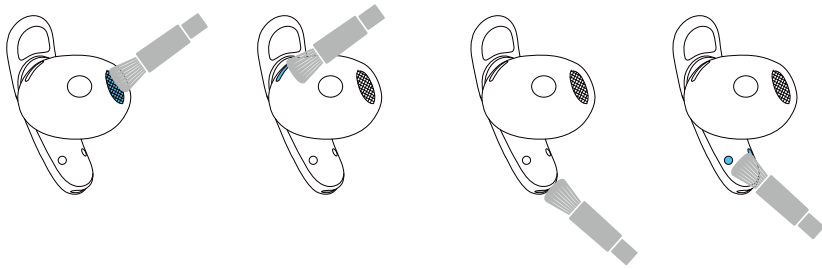

2. Gently brush the nozzle mesh, rear vent holes, microphone area, and charging contacts in an up-and-down motion for about 15 seconds.

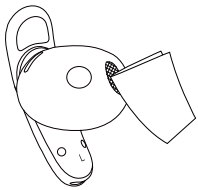

3. Use an alcohol wipe to thoroughly clean these areas.
4. After cleaning, wipe away any remaining alcohol from the earbuds. Wait until they are completely dry before connecting them to your phone and using them again.

DUAL CONNECTIONS

Dual Connections feature is enabled by default.

1

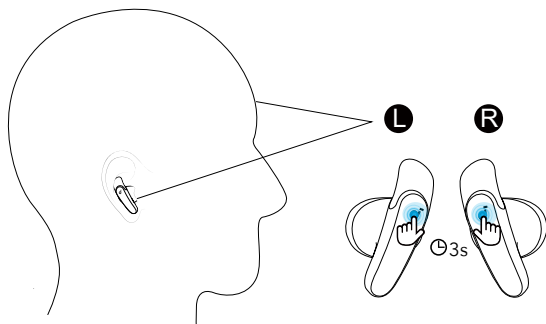

2

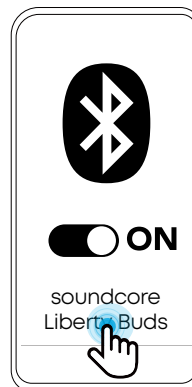

To connect a second device while one device is already connected, tap the control area on both earbud stems for 3 seconds until you hear a voice prompt indicating the earbuds are in pairing mode. You can then proceed to pair with the second device.

If you wish to disable Dual Connections, you can do so in the soundcore app. Tap the cogwheel icon in the upper-right corner to access **Settings**, then swipe the **Dual Connections** toggle switch to the left to turn it off.

MANUAL PAIRING

1

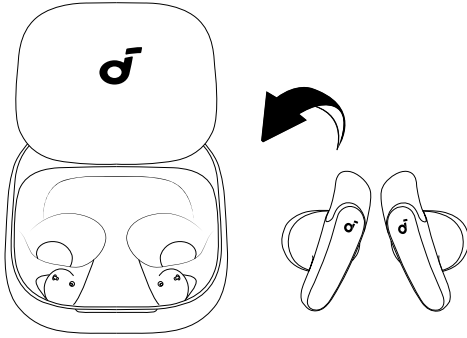

2

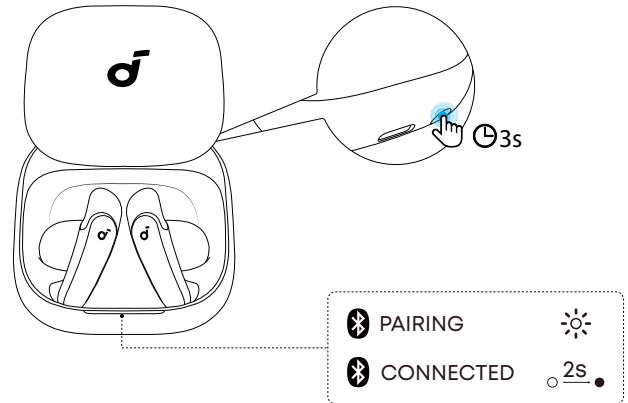

To manually enter Bluetooth pairing mode, place the earbuds in the charging case and leave the lid open. Press and hold the reset button behind the charging case for 3 seconds until the LED indicator flashes white rapidly.

CHARGING

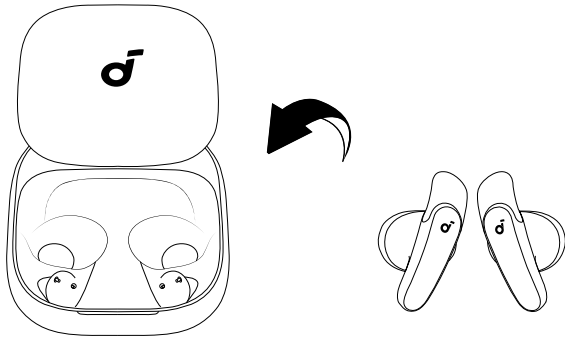

1. Place the earbuds in the charging case and close it.
 - Fully dry off the earbuds and the USB-C charging port before charging.

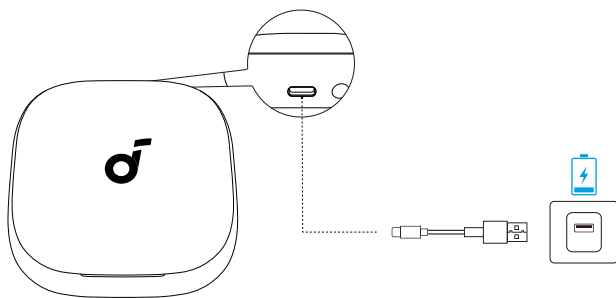



2. Connect the charging case to a power supply by using the provided USB-C charging cable.

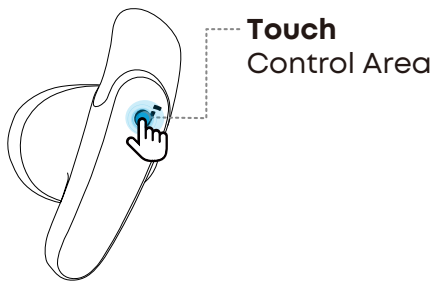

Fully charging the case with earbuds inside takes about 3 hours via the cable.
A 10-minute charge of the earbuds in the charging case provides 4 hours of playtime.

CONTROLS

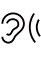

		Using Dual Earbuds	Using Single Earbud
	Play / Pause Audio	Tap twice (R)	Tap twice
	Play the Next Track	Tap twice (L)	/
	Answer a Call	Tap twice (L/R)	Tap twice
	Reject / End a Call	Tap and hold for 2 seconds (L/R)	Tap and hold for 2 seconds
	Switch Between Ambient Sound Modes	Tap and hold for 2 seconds (L/R)	Tap and hold for 2 seconds

WEARING DETECTION

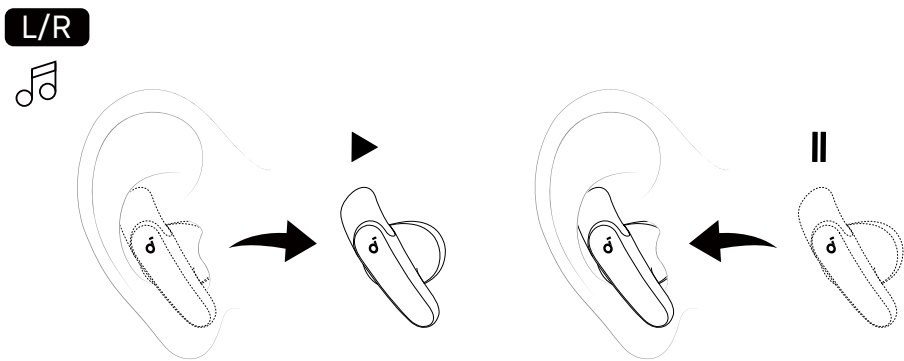

Playback will automatically pause when an earbud is removed and will resume once worn.

AMBIENT SOUND

You can select from Noise Cancellation, Normal, or Transparency modes in the soundcore app.

- **Adaptive ANC:** Optimize noise cancellation by adapting to your ears and environment.
- **Normal:** Enjoy balanced sound without noise cancellation.
- **Transparency:** Stay aware of your surroundings while listening to music.

AI TRANSLATION



Note: Feature paths and interface visuals may change with software updates. For the most accurate guidance, please refer to your latest app version.

Before Use:

- Please upgrade to the latest version of the soundcore app and ensure that your earbuds are connected to the app.
- Disable Dual Connections.

Real-Time Translation

In settings where you're exposed to content in a foreign language for extended periods (e.g., lectures, classes), real-time translation delivers continuous text display and audio playback of the translated content with almost no lag.

In the soundcore app, go to ***Anka page***, then tap ***Real-Time Translation***. Make sure your earbuds are connected to the app.

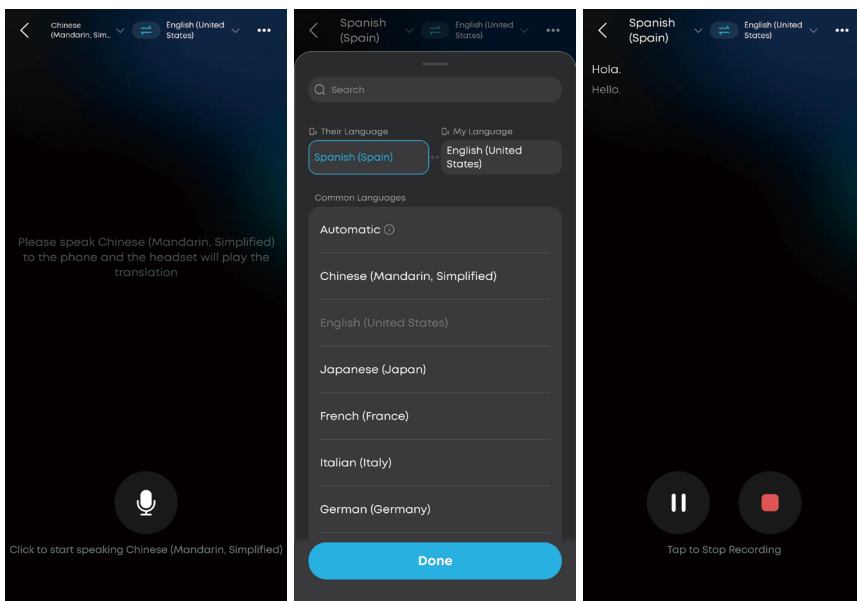

1. Tap **Real-Time Translation**.
2. Tap the language section at the top of the page, then select **Their Language** and **My Language**.
3. Tap the microphone button to start recording.

Face-to-Face Translation

In the soundcore app, go to ***Anka page***, then tap ***Face-to-Face Translation***.

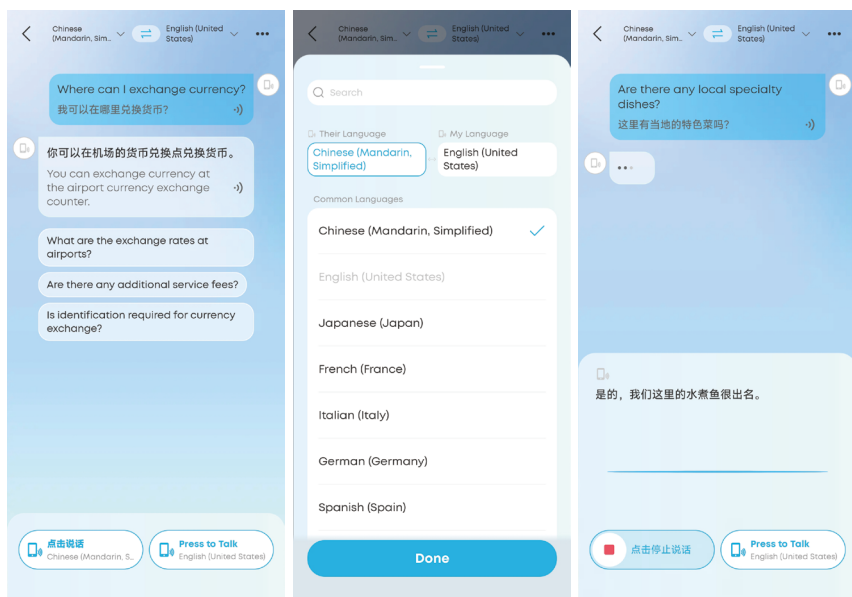

When your earbuds are connected to the app, follow the steps below to try out Face-to-Face Translation.

1. Tap the language section at the top of the page, then select **Their Language** and **My Language**.
2. Tap the bottom-right button and speak into your earbuds. The translation will play from your phone.
3. Tap the bottom-left button and speak into your phone. The translation will play from your earbuds.



This feature works even if your earbuds aren't connected to the app. Just speak into your phone, and the translation will play through its speaker.

LDAC

To use the LDAC codec, your devices must run Android 8.0 or later.

LDAC offers higher sound quality but uses more power, which may reduce battery life.

For a stable Bluetooth connection, enable LDAC in low-interference environments.

Note: UI images are for illustrative purposes only; actual display may vary by software version.

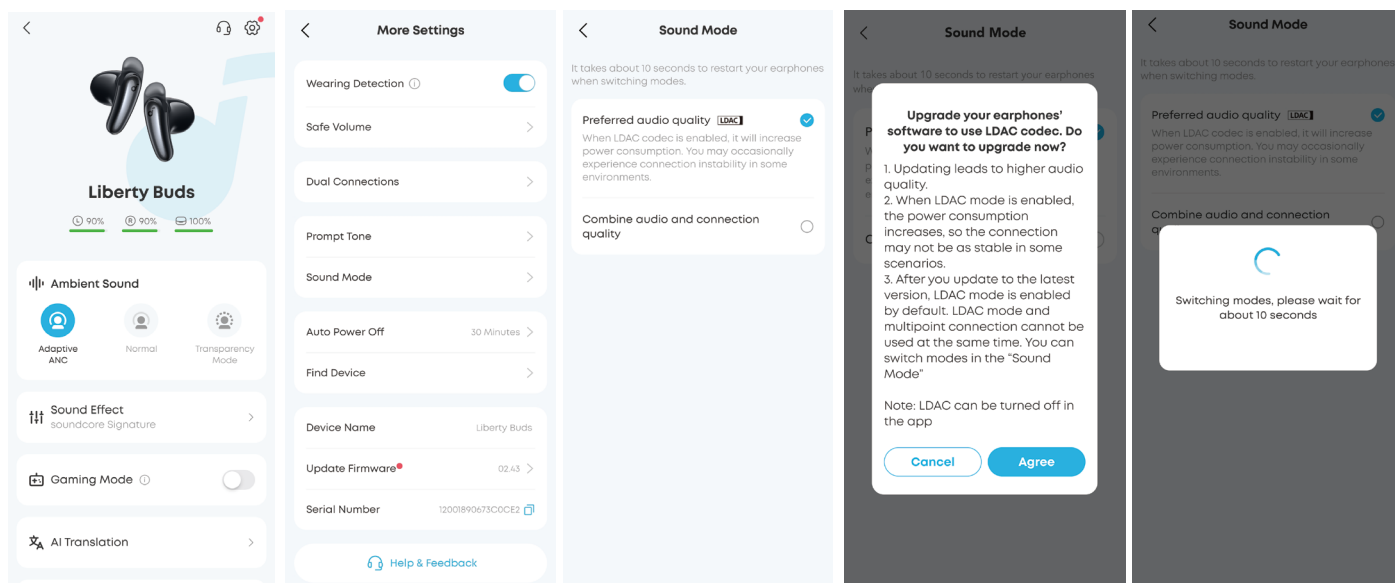

In the soundcore app:

1. Select **Sound Mode**.
2. Tap **Preferred audio quality**.

- 3. Tap **Agree** to proceed.
- 4. Switching audio codecs takes about 10 seconds. You may be prompted to update the firmware if a new version is available.

RESET

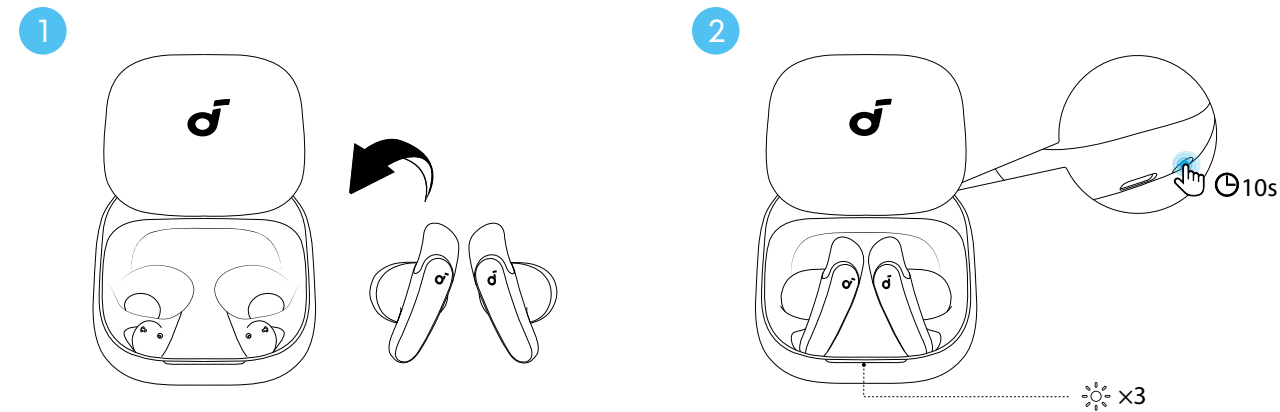

You might need to reset the earbuds if you experience any connectivity issues. Place the earbuds in the charging case and leave the lid open. Press and hold the reset button behind the charging case for 10 seconds until the LED light strip flashes white rapidly three times.

LED BEHAVIOR

Check the Battery Level

You can check the battery level indicated by the LED light strip whenever you open the lid.

Battery Level	LED Behavior
0-20%	The middle part of the LED light strip stays on in red for 5 seconds and then goes off.
20-60%	The middle part of the LED light strip stays on in white for 5 seconds and then goes off.
>60%	The entire LED light strip stays on in white for 5 seconds and then goes off.

Charging

When charging, the LED behavior varies as the battery reaches different levels.

Battery Level	LED Behavior
0-20%	The middle part of the LED light strip breathes in red.
20-60%	The middle part of the LED light strip breathes in white.
60%-100%	The entire LED light strip breathes in white.
100%	The entire LED light strip stays on in white for 5 minutes and then goes off.

Bluetooth Connection

Status	LED Behavior
Pairing	The entire LED light strip flashes quickly in white.
Connected	The entire LED light strip stays on for 2 seconds and then goes off.
Bluetooth Settings Reset Successfully	The entire light strip flashes in white three times.

FIRMWARE UPDATE

You will be informed once a new firmware version is detected when you connect the earbuds to the app. Ensure the earbuds are placed in the charging case and the lid remains open until the firmware update is complete. During the update, ensure the earbuds are being charged and avoid using them.

SPECS

Specifications are subject to change without notice.

Input	5V \equiv 0.8A
Output	5V \equiv 0.4A
Battery Capacity	Earbuds: 62mAh Case: 690mAh
Playtime (with ANC Off)	7 Hours (Up to 30 Hours with Charging Case)
Playtime (with ANC On)	6 Hours (Up to 26 Hours with Charging Case)
Charging Time	Up to 3 Hours (Charging Case with Earbuds)
Driver Unit	11 mm
Frequency Response	20 Hz - 40 kHz
Impedance	14 Ω \pm 15%
Waterproof Rating (Earbuds)	IP55
Bluetooth Version	6.1
Bluetooth Range	10 m / 33 ft

CUSTOMER SERVICE



service@soundcore.com
uk.support@soundcore.com (UK)
ie.support@soundcore.com (Ireland)
support.india@anker.com (India)
support.mea@anker.com (For Middle East and Africa Only)
support@anker.com (日本)
support.kr@anker.com (한국)
ced-cn@anker.com (中国)



+1 (800) 988-7973 (US/Canada)
+44 (0) 1604 936 200 (UK)
+49 (0) 69 9579 7960 (DE)
03 4455 7823 (日本)
+86 400 0550 036 (中国)
+82 1666-8470 (한국)
+971 8000 320 817 (UAE)
+966 8008 500 030 (KSA)
+965 22069086 (Kuwait)
+20 8000 000 826 (Egypt)
+90 (850) 460 1414 (Türkiye)
+91 8000 504 414 (India)

Note: The 'x' of SN Code: xxxxxxxxxxxxxxxx is a variable, see below table.

Variable 'x'	Range of variable	Content
Eighth	0-9 or A-F	Denotes the hardware version which is not effected on the safety compliance.
Ninth	8,9,A,B,C...	Denotes the year, 8 means 2018, 9 means 2019, A means 2020, B means 2021, C means 2022, and so on.
Tenth and Eleventh	01,02,03...	Denotes weeks, 01 means the first week in this year, 02 means the secondary week in this year, and so on.
Twelfth	1-7	Denotes date, 1 means Monday, 2 means Tuesday..., 7 means Sunday and so on.
The last five	00001-99999	Denotes serial No.

Hereby, Anker Innovations Limited declares that this device is in compliance with The Product Security and Telecommunications Infrastructure (Security Requirements for Relevant Connectable Products) Regulations 2023. For the Statement of Compliance, visit the website:

<https://uk.soundcore.com/pages/psti-related>.

Default Open Port: Classic Bluetooth

Port Description: After the device is powered on, Classic Bluetooth visibility (or pairing mode) is automatically enabled, providing Bluetooth pairing (or control) services. The Bluetooth service is disabled when the device is powered off.