



USER MANUAL

Smoke Alarm E10



Conforms to UL Standard 217 and Certified to CAN/ULC Standard S531

Scan to View



Installation Guide

Introduction

The eufy Smoke Alarm is a photoelectric smoke alarm that meets the UL217 9th Edition standards, designed to accurately and promptly detect the presence of fire smoke. Once the danger of fire smoke is detected, the red LED light will flash rapidly, and an alarm sound will be emitted.

Important Safety Information

- This product is for smoke detection use only.
- This product is NOT designed to connect with other manufacturers' products unless otherwise specified.
- This product is not suitable for locations where the wind speed exceeds 300 meters per minute (985 FPM).
- The unit will not alert hearing-impaired residents. It is recommended that you install special units with visual and vibration alarms to alert hearing-impaired residents.
- It is not recommended for operation in areas where the temperature may fall below 40 °F (4.4°C) or rise above 100 °F (37.8°C) or where humidity is higher than 95%, as this may reduce battery life.
- Do not stand too close to the unit when the alarm is sounding. It is loud to wake you in an emergency. Exposure to the noise at close range may harm your hearing.
- Do not paint over the unit. Paint may clog the openings to the sensing chamber and prevent the unit from operating properly.
- Never ignore any alarm. If the unit alarms and you are not testing it, it is warning you of a potentially dangerous situation that requires immediate attention.
- Never remove the battery from the smoke alarm to stop nuisance alarms.
- Make sure no door or other obstruction could prevent smoke from reaching the unit. The units cannot provide an alarm if the smoke does not reach them.
- Never use an open flame of any kind to test the smoke alarm. You might accidentally damage or set fire to the device or to your home.
- You should always replace a smoke alarm after 10 years from date of purchase.
- Smoke alarms are not to be used with smoke alarm guards unless the combination has been evaluated and found suitable for that purpose.

[WARNING: Mobile alert services are ancillary to the

product and for informational purposes only. They are not intended or suitable for life safety or critical purposes nor do these services take the place of third-party life safety monitoring services. This product's smartphone and tablet notifications require a stable network connection, and are only as reliable as your home network connection.

NOTE: The app receives real-time updates. The paper or online copy of your user guide will most likely lag behind the app's real-time updates.

What's in the Box

- Smoke Alarm × 1
- Mounting Bracket × 1 (pre-installed on the sensor)
- Battery × 1 (pre-installed in the sensor)
- Screw Pack × 1
- User Manual × 1

Tools You Need (Not Provided)

- Phillips Crosshead Screwdriver
- Pencil
- Ladder (If necessary)
- Power Drill (If necessary)
- 3/16-inch Drill Bit (If necessary)

At a Glance

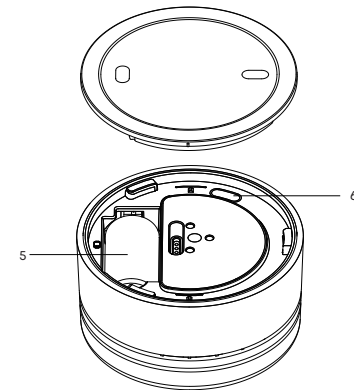
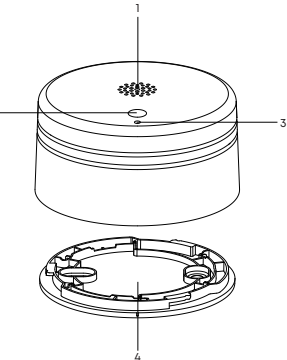

- Alarm Hole
- Test/Hush Button
- LED Indicator
- Mounting Bracket (pre-installed on the sensor)
- CR123A Battery (pre-installed in the sensor)
- SYNC Button

Installing the Smoke Alarm

Adding the Smoke Alarm to the System

- Ensure the HomeBase is properly set up.
- Download and install the eufy app, then sign in or create an account.

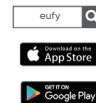

- Select the + icon in the top right corner, and select Smoke Alarm in the **Device Family**.

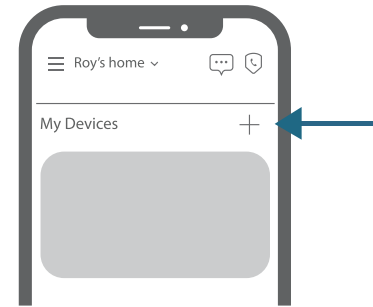

- Follow in-app instructions to complete the setup.

Selecting the Installation Locations

Determine where you are going to place your smoke alarm:

- On every floor level, including finished attics and basements.
- In every sleeping area and in every bedroom.
- If your room or hallway is more than 30 feet (9.1 meters) long, install a sensor at both ends.
- At the top of the first-to-second-floor stairway and on the basement ceiling near the entry of the stairs.

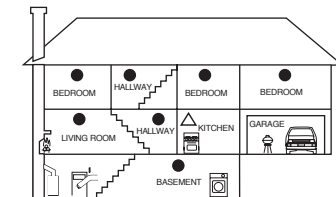

Recommended Locations

- This device should be installed in accordance with the National Fire Protection Association's Standard 72 (National Fire Protection Association, Batterymarch Park, Quincy, MA 02269).

The National Fire Protection Association (NFPA) recommends installing a smoke alarm in the following areas:

- In all sleeping rooms and guest rooms.
- Outside of each separate dwelling unit sleeping area, within 21 feet (6.4m) of any door to the sleeping room, the distance measured along a path of travel.
- On every level of a dwelling unit, including basements.
- On every level of a residential board and care occupancy (small facility), including basements and excluding crawlspaces & unfinished attics.
- In the living area(s) of a guest suite.
- In the living area of a residential board & care occupancy (small facility).

- These alarms are intended primarily for private dwellings. For use for other purposes, please seek the manufacturer's advice.

Locations to Avoid

For best performance, please avoid installing a smoke alarm in these areas:

- In dusty or dirty areas. Dirt and dust can build up and impair performance.
- In areas where the normal ambient temperature is below 40°F (4.4°C) or exceeds 100°F (37.8°C), such as garages and unfinished attics.
- In highly humid areas. Moisture or steam may cause nuisance alarms.
- Near fresh air vents, ceiling fans, or in very drafty areas. Drafts can blow smoke away from the unit, preventing it from reaching the sensing chamber.
- In kitchens, garages, and furnace rooms. Burning material creates combustion particles which could cause your smoke alarm to go off unnecessarily.
- Less than 4 inches (10 centimeters) from the peak of an A-frame ceiling. The dead air space may prevent

- smoke from reaching the smoke alarm.
- Near fluorescent lights, amateur radios, or other devices that may transmit an RF signal, as electrical noise can interfere with the sensor.

Mounting the Smoke Alarm

The smoke alarm is designed to be mounted on the ceiling (best) or the wall with the provided screw pack. Position Requirements:

- On the ceiling (recommended):** at least 4 inches (10 centimeters) away from the side wall.
 - If you have a sloped, peaked or cathedral ceiling, the alarm should be installed within 3 feet (90 centimeters) of the peak of the ceiling measured horizontally.
- On the wall:** 4 to 12 inches (10 to 30 centimeters) below the ceiling.

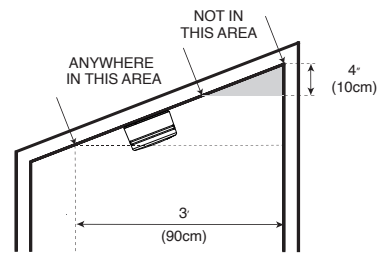
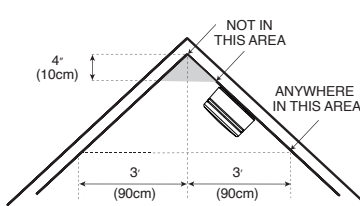
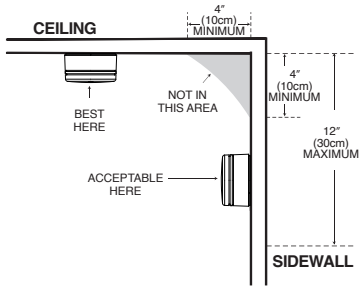

- Turn the mounting bracket **counterclockwise** to remove the mounting bracket from the sensor.
- Place the mounting bracket at your desired position, and mark the screw hole positions on the ceiling or the wall with a pencil.
- For **hard surfaces** that are made out of stucco, brick, concrete, etc., drill holes with a 3/16" (5 mm) drill bit, and insert the anchors into the holes. For other types of surfaces, skip this step.
- Secure the mounting bracket to the ceiling or the wall with the provided screws.

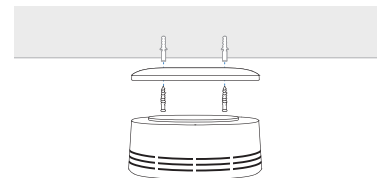

- Attach the smoke alarm to the mounting bracket, and turn **clockwise** to lock the sensor.

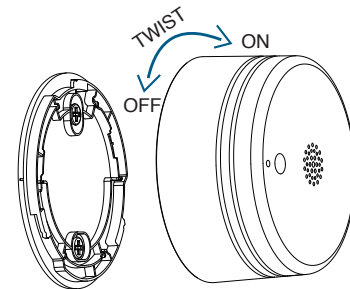

- Press the Test/Hush button to test the smoke alarm. Refer to **Testing** for details.

NOTE: Test the smoke alarm every time you replace the battery.

CAUTION: This smoke alarm comes with a design that prevents the smoke alarm cover from closing without the battery properly installed. This tells you that the smoke alarm will not work until a new battery is properly installed.

Testing

Test the smoke alarm **EVERY WEEK** to ensure it is working properly.

- DO NOT stand close to the unit when the horn is sounding. Always stand an arm's-length away from the unit when testing.

- Press and hold the Test/Hush button on the sensor until the alarm sounds. During the test, you will hear a repeating siren sound (3 beeps followed by a pause). The sensor may continue to alarm for a few seconds after you release the button.
 - If the sensor alarm does not sound, make sure the battery is installed properly, and test it again.
 - If it still does not sound, replace the sensor immediately.

- Open the app and make sure the smoke alarm is online, and tap **Events** at the bottom of the app.
 - If a new event appears on the event list, it indicates that the smoke alarm is ready for use. The time for updates depends on networking conditions. If you can't get updates in time, please refresh the event list.

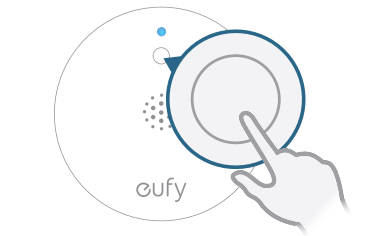

Maintenance

To keep the smoke alarm working properly, follow these simple tips:

- Clean the alarm annually by using compressed air or a vacuum cleaner hose. Never use water, cleaners or solvents since they may damage the sensor.
- If unwanted alarms persist after cleaning the sensor, replace the device immediately.

When the Alarm Sounds

If You Discover a Fire...

If the alarm sounds, check for fires first. If a fire is discovered, do the following:

- Get everyone out of the house immediately by your escape plan.
- Keep doors and windows closed, unless you must escape through them.
- Stay close to the floor if the air is smoky. Cover your nose and mouth with a cloth (preferably damp).
- Meet at your planned meeting place outside your home and make sure everyone is there.
- Never return to a burning building for any reason.

- Contact your local fire department for advice on improving home safety.

These are situations where a smoke alarm may not be effective to protect against fire as stated in the NFPA Standard 72.

For instance:

- Smoking in bed.
- Leaving children home alone.
- Cleaning with flammable liquids, such as gasoline.

Develop and Practice a Plan of Escape

- Make a floor plan indicating all doors and windows and at least two escape routes from each room. Second story windows may need a rope or chain ladder.
- Have a family meeting and discuss your escape plan, showing everyone what to do in case of fire.
- Determine a place outside your home where all of you can meet if a fire occurs.
- Familiarize everyone with the sound of the smoke alarm and train them to leave your home when they hear the sound.
- Identify children's bedrooms with red stickers placed in the upper left corner of the windows. They are available from your local fire department.
- Practice a fire drill at least every six months. Practice allows you to test your plan before an emergency. You may not be able to reach your children. It is important they know what to do!

Silencing Unwanted Alarms

If no fire is present, check if the alarm is caused by nuisance alarms (caused by cooking smoke, etc.). If so, you can press the Test/Hush button on the sensor to temporarily mute the alarm.

 If you do not know the source of the smoke, do not assume it is an unwanted alarm. Not responding to an alarm can result in property loss, injury, or death.

The Silence function can temporarily mute an unwanted alarm for approximately 10 minutes. If the smoke is not too dense, the alarm will stop

immediately and the red LED will flash every 10 seconds. If smoke around the sensor is dense enough to suggest a potentially dangerous situation, the sensor will stay in alarm or may re-alarm quickly. This function is used only when there is a known alarm condition, such as smoke caused by cooking.

 Never remove the batteries to stop an unwanted alarm. This will disable the alarm so it cannot sense smoke. Instead, open a window or fan the smoke away from the sensor.

The silence feature is only for your convenience and will not correct a problem. Always check your home for a potential problem after any alarm. Failure to do so can result in injury or death.

LED Indication and Audible Alarm

CONDITION	LED INDICATOR	AUDIBLE ALARM	NOTE
Standby	Red LED flashes once every 54 seconds.	None	
Testing	Red LED flashes rapidly.	3 short quick beeps	
Alarm	Red LED flashes rapidly.	3 short quick beeps	
Hush	Red LED flashes once every 10 seconds.	None	One press can mute the alarm for 10 minutes.
Low battery	Red LED flashes once every 54 seconds.	1 beep every 54 seconds	Action required: replace battery
Hush for low battery warning	Red LED flashes once every 54 seconds.	None	One press can mute the low battery warning for 12 hours.
Malfunction	Red LED flashes twice every 54 seconds.	2 beeps every 54 seconds	Action required: replace sensor
End of life	Yellow LED flashes three times every 54 seconds.	3 beeps every 54 seconds	Action required: replace sensor

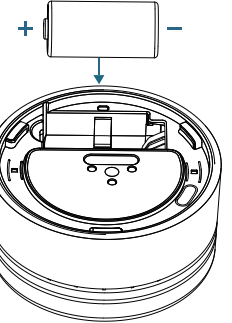

Replacing the Battery

When the battery is low, the smoke alarm will chirp approximately every 54 seconds. Replace with a **CR123A battery** immediately.

Required Battery Type:

1. Turn the sensor counterclockwise to open it.
2. Align the negative (-) and positive (+) ends of the battery properly, and insert the battery into the battery compartment.
3. Turn the sensor clockwise back in place on the mounting bracket.
4. Press and hold the Test/Hush button to test the sensor.

 Use only batteries specified in this user manual. The use of a different type of battery will affect the operation of the smoke alarm.

- Constant exposure to high or low temperatures or high humidity may reduce battery life.

Specification

Battery	EVE CR123A 3V lithium battery
Sensor Type	Photoelectric
Alarm Sound Level	≥ 85dB (at 3m straight ahead)
Alarm Sensitivity	1.9%/ft ± 0.33%/ft OBS
Operating Environment	Temperature: 40 °F (4.4°C) to 100 °F (37.8°C) Humidity: ≤ 95% RH (no condensation)
Dimensions	Φ 70 mm x H 37 mm

Codes and Standards

**Agency Placement Recommendations
NFPA 72 Chapter 29**

For your information, the National Fire Alarm and Signaling Code, NFPA 72, reads as follows:

29.5.1 *Required Detection.

*29.5.1.1 Where required by other governing laws, codes, or standards for a specific type of occupancy, approved single and multiple-station smoke alarms shall be installed as follows:

- (1) *In all sleeping rooms and guest rooms.
- (2) *Outside of each separate dwelling unit sleeping area, within 21 ft (6.4 m) of any door to a sleeping room, with the distance measured along a path of travel.
- (3) On every level of a dwelling unit, including basements.
- (4) On every level of a residential board and care occupancy (small facility), including basements and excluding crawl spaces and unfinished attics.
- (5) *In the living area(s) of a guest suite.
- (6) In the living area(s) of a residential board and care occupancy. (Reprinted with permission from NFPA 72®, National Fire Alarm and Signaling Code Copyright © 2012 National Fire Protection Association, Quincy, MA 02269. This reprinted material is not the complete and official position of the National Fire Protection Association, on the referenced subject which is represented only by the standard in its entirety.)

(National Fire Alarm and Signaling Code® and NFPA 72® are registered trademarks of the National Fire Protection Association, Inc, Quincy, MA 02269.)

California State Fire Marshal(CSFM)

Early warning detection is best achieved by the installation of fire detection equipment in all rooms and areas of the household as follows:

A smoke alarm installed in each separate sleeping area (in the vicinity, but outside bedrooms), and heat or smoke alarms in the living rooms, dining rooms, bedrooms, kitchens, hallways, finished attics, furnace rooms, closets, utility and storage rooms, basements, and attached garages.

Limitations of Smoke Alarms

- The smoke alarm can help save lives by providing an early warning of a fire, but they are not foolproof. Smoke alarms can only work if they are properly located, installed, and maintained, and if smoke reaches them.
- This smoke alarm is NOT designed to be the primary protection for buildings that require complete fire alarm systems. Buildings of this type include hotels, motels, dormitories, hospitals, nursing homes, and group homes. This is true even if they were once single family homes. However, this smoke alarm may be used inside individual rooms as supplemental protection.
- Smoke alarms cannot prevent or extinguish fires. They are not a substitute for property or life insurance.
- Smoke alarms cannot provide an alarm if the smoke does not reach them. Therefore, smoke alarms may not sense the smoke from fires in chimneys or walls, on roofs, or on a different floor.
- Smoke alarms can sound their alarms only when they detect smoke. Smoke alarms detect combustion particles in the air. They do not sense heat, flame, or gas. This smoke alarm is designed to give audible warning of a developing fire. However, many fires are fast-burning, explosive, or intentional. Others are caused by carelessness or safety hazards. Smoke may not reach the sensor quickly enough to ensure safe escape.
- Smoke alarms may not alert all individuals. The alarm horn is loud in order to alert individuals to a potential danger. However, there may be limiting circumstances where a household member may not hear the alarm. The use of alcohol or drugs may also impair one's ability to hear the smoke alarm. Special purpose units, like those with visual and vibration alarms, should be installed for hearing-impaired residents.
- Smoke alarms have limitations. This smoke alarm is not foolproof and is not warranted to protect lives or property from fire. Smoke alarm devices are not a substitute for insurance. Homeowners and renters should insure their lives and property. In addition, it is possible for smoke alarms to fail at any time. **You should always replace a smoke alarm after 10 years from date of purchase.**

Notice

FCC Statement

This device complies with Part 15 of the FCC Rules. Operation is subject to the following two conditions: (1) this device may not cause harmful interference, and (2) this device must accept any interference received, including interference that may cause undesired operation.

Warning: Changes or modifications not expressly approved by the party responsible for compliance could void the user's authority to operate the equipment.

Note: This equipment has been tested and found to comply with the limits for a Class B digital device, pursuant to Part 15 of the FCC Rules. These limits are designed to provide reasonable protection against harmful interference in a residential installation. This equipment generates uses and can radiate radio frequency energy and, if not installed and used in accordance with the instructions, may cause harmful interference to radio communications. However, there is no guarantee that interference will not occur in a particular installation. If this equipment does cause harmful interference to radio or television reception, which can be determined by turning the equipment off and on, the user is encouraged to try to correct the interference by one or more of the following measures: (1) Reorient or relocate the receiving antenna. (2) Increase the separation between the equipment and receiver. (3) Connect the equipment into an outlet on a circuit different from that to which the receiver is connected. (4) Consult the dealer or an experienced radio/TV technician for help.

FCC Radio Frequency Exposure Statement

The device has been evaluated to meet general RF exposure requirement. The device can be used in portable exposure condition without restriction.

The following importer is the responsible party:
Company Name: POWER MOBILE LIFE, LLC
Address: 10800 NE 8TH ST #900, BELLEVUE, WA, 98004, UNITED STATES
Telephone: 1-800-988-7973

IC Statement

This device complies with Industry Canada licence-exempt RSS standard(s). Operation is subject to the following two conditions:

- (1) this device may not cause interference, and
- (2) this device must accept any interference, including interference that may cause undesired operation of the device.

This Class B digital apparatus complies with Canadian ICES (B).

IC RF Statement

The device has been evaluated to meet general RF exposure requirement. The device can be used in portable exposure condition without restriction.

Customer Support

 (US) +1 (888) 3839-123  support.expert@eufy.com

Anker Innovations Limited
Unit 56, 8th Floor, Tower 2, Admiralty Centre, 18
Harcourt Road, Hong Kong

 @EufyOfficial  @EufyOfficial
 @EufyOfficial



©Anker Innovations Limited. All rights reserved, registered in the United States and other countries.