

Breast Pump Overview

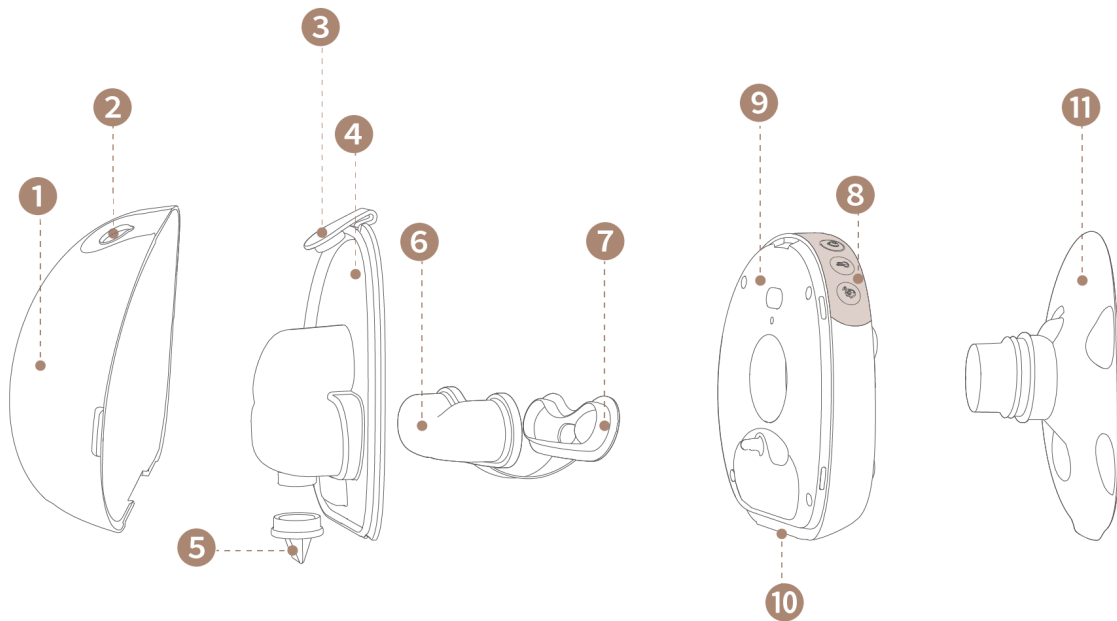

1. Milk Container
2. Pouring Spout
3. Container Lid
4. Container Back
5. Duckbill Valve
6. Diaphragm
7. Diaphragm Lid
8. Control Panel
9. Pump Hub
10. Charging Pins
11. Flange (24 mm)

Accessories also include:

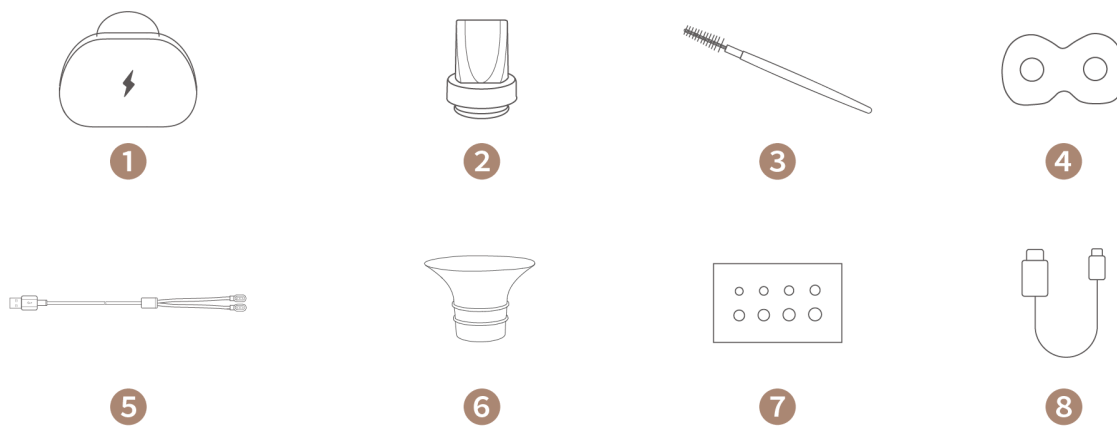

1. Charging Case
2. Extra Duckbill Valves

3. Duckbill Valve Cleaning Brush
4. Stain-proof Mat
5. Magnetic Charging Cable
6. Sizing Inserts (15/17/19/21 mm)
7. Nipple Measuring Card
8. USB-C Charging Cable

1 Charging

Fully charge the pump hub before initial use; it won't operate while charging.

- **Option 1: 2-in-1 Magnetic Charging Cable**

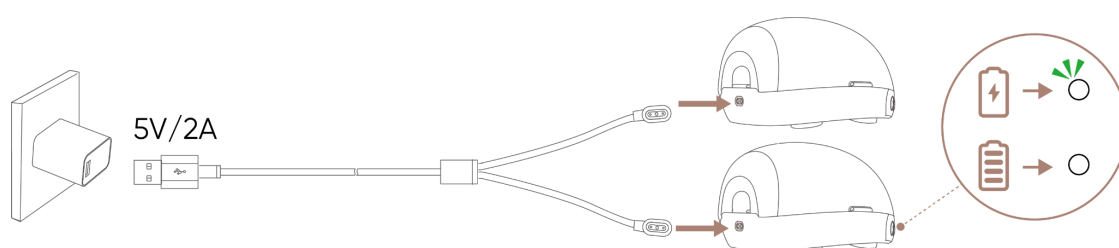

- **Option 2: Charging Case**

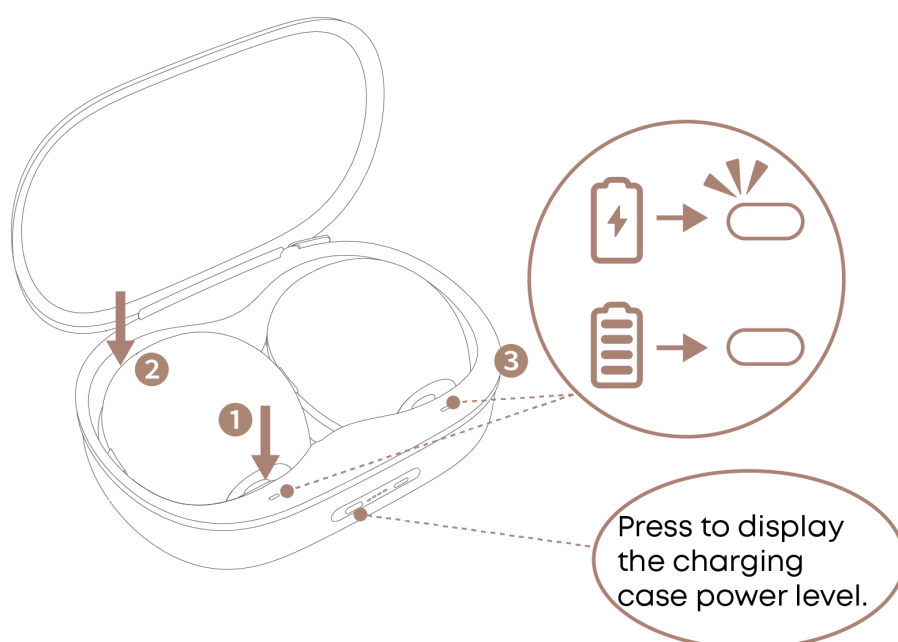

1. Align the pump hub's charging pins with the port inside the case until you hear them click.
2. Let go of the pumps to allow the entire pump to be placed in the slot.
3. Ensure the indicator light flashes white, indicating the pumps are charging properly. The charging case automatically stops charging once the breast pumps are fully charged. The charging case LED will remain on when plugged in.

 The charging case is not washable. The removable silicon stain-proof mat inside the charging case is washable and helps prevent the milk from spilling into the case.

2 Disassembling

1. Pull the side grip of the milk container to detach it from the pump hub.

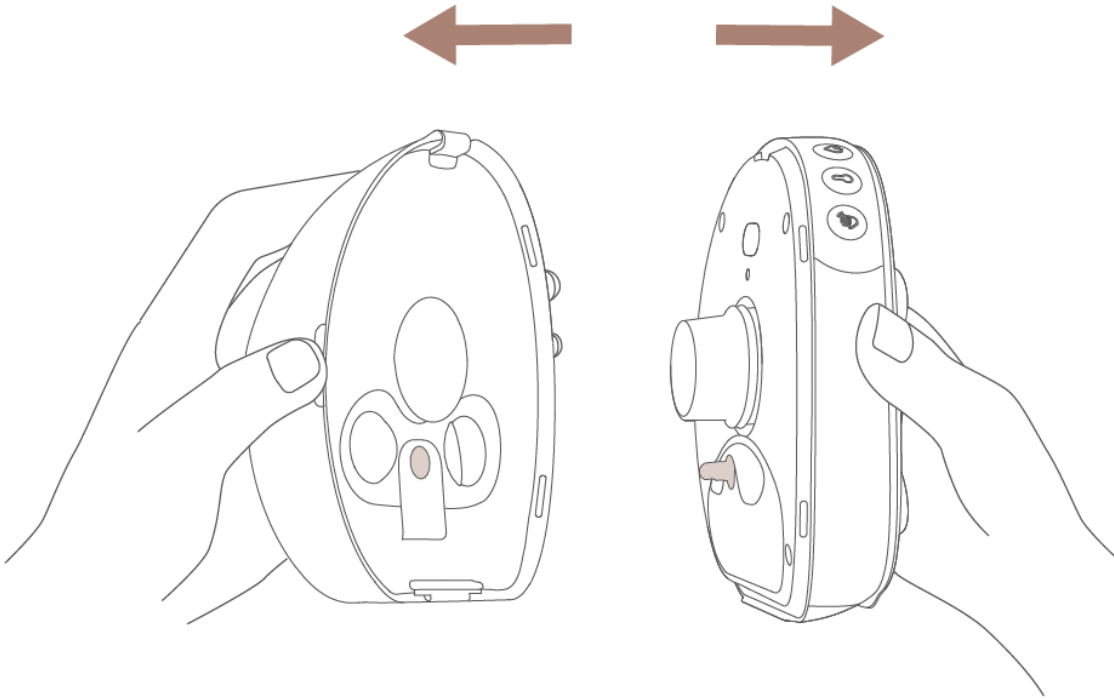

2. Press to release the flange from the pump hub.

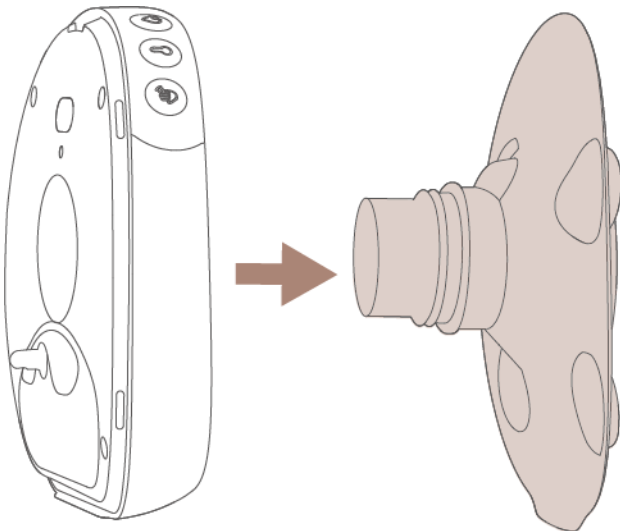

3. Pull out the diaphragm.

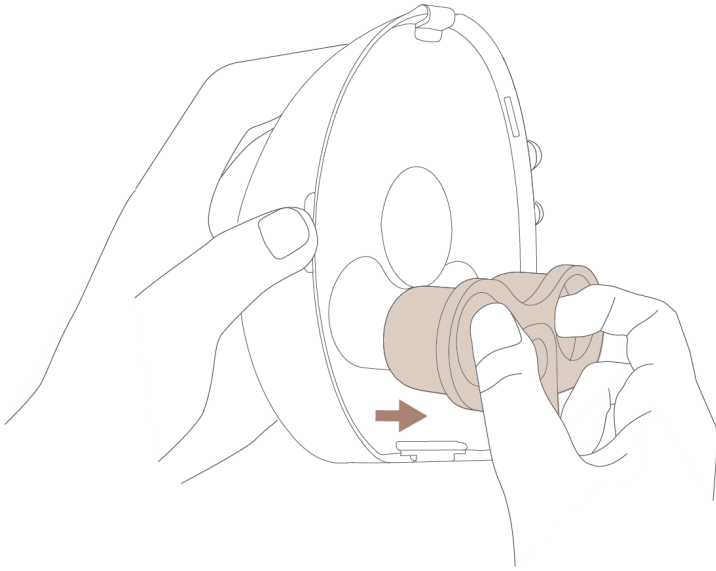

💡 For moms with long nails — lift here to pull out the diaphragm.

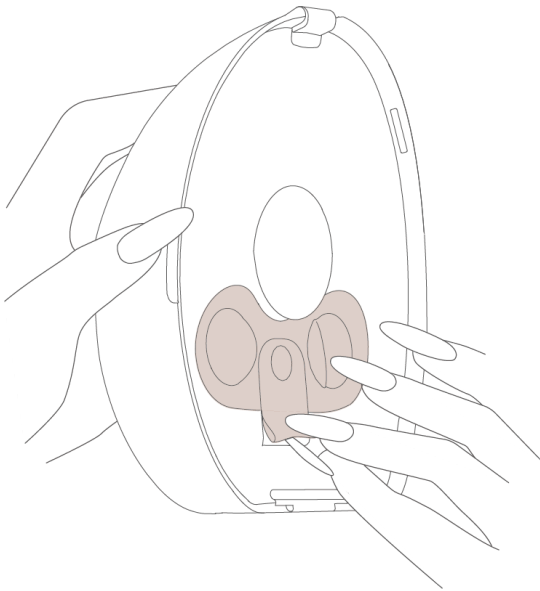

4. Open the container lid, and pull from the bottom to remove the container back.

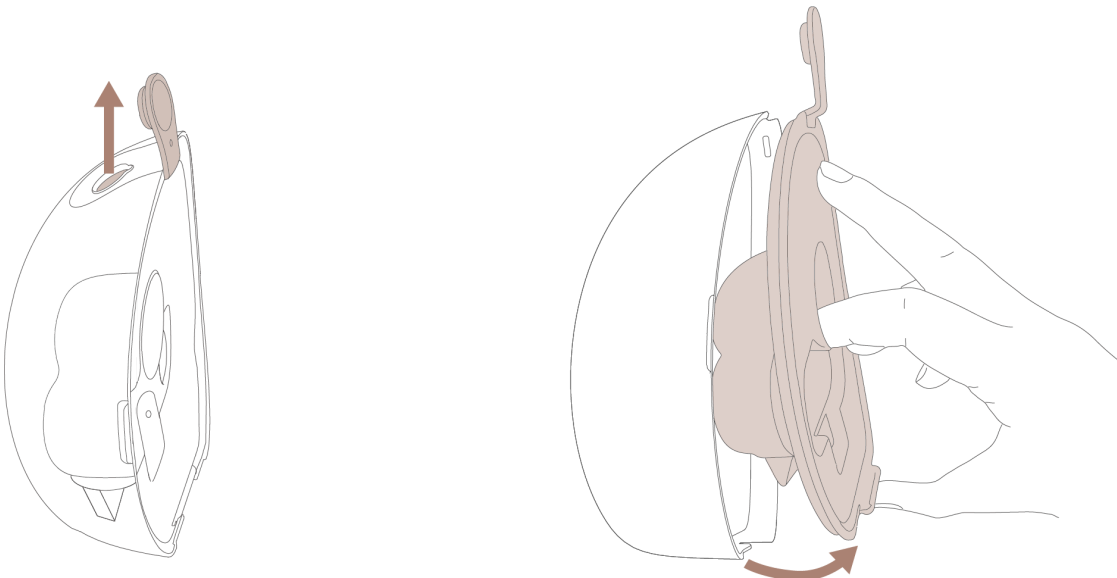

5. Remove the duckbill valve.

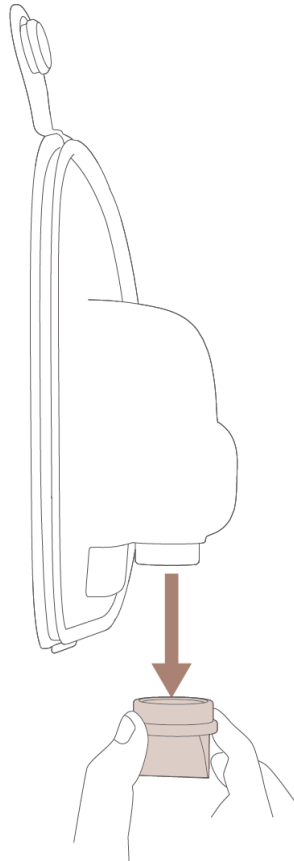

3 Cleaning

Do not use a microwave to sanitize.



All parts except the pump hub and the charging case can be washed and sanitized as follows.

! The pump hub is NOT washable. Always keep the pump hub dry and clean after each pumping session. If milk is spilled on the pump hub, wipe it clean with a dry cloth to ensure proper charging.

Dishwasher

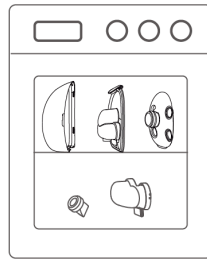

Cooking Pot

Keep stirring to prevent deformation.



Baby Bottle Sterilizer

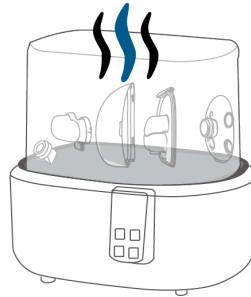

Before First Use: Sanitize all washable parts by boiling for up to 5 minutes, stirring constantly to prevent the parts from sticking to the container and melting. You can also steam-sanitize them.

Daily Cleaning: Rinse all washable parts with warm, soapy water, then air dry. Sanitize if needed, using the same methods as the initial cleaning.

- 💡 · To avoid damage, use only the provided duckbill valve cleaning brush to clean the valve.
- To prevent scratches, clean the rest of the washable parts with a silicon or sponge brush.

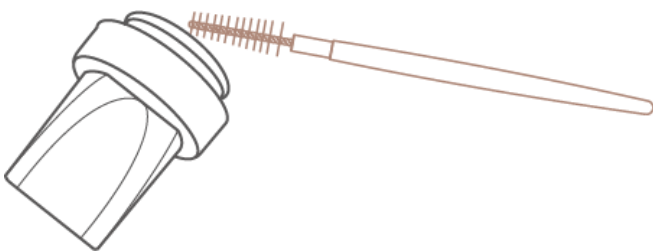

4 Assembling

1. Attach the duckbill valve to the small hole inside the container. Flick it to ensure it does not fall out.

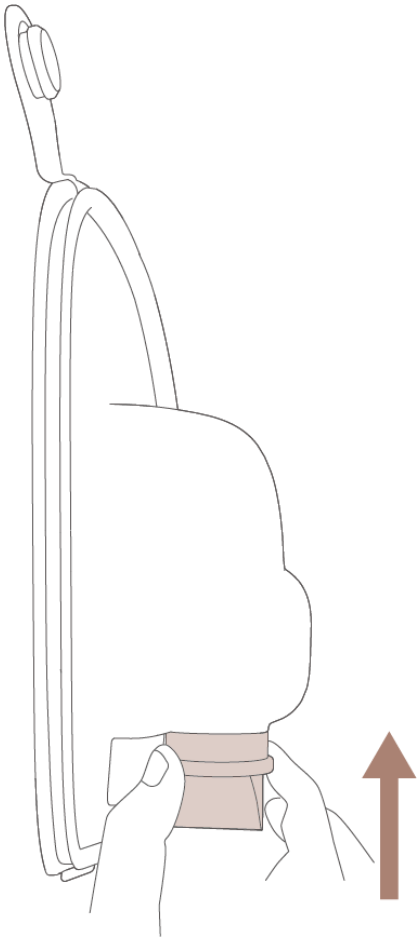

2. Reassemble the container back.

① Align the lid with the top slot and fit the bottom tab into the container slot.

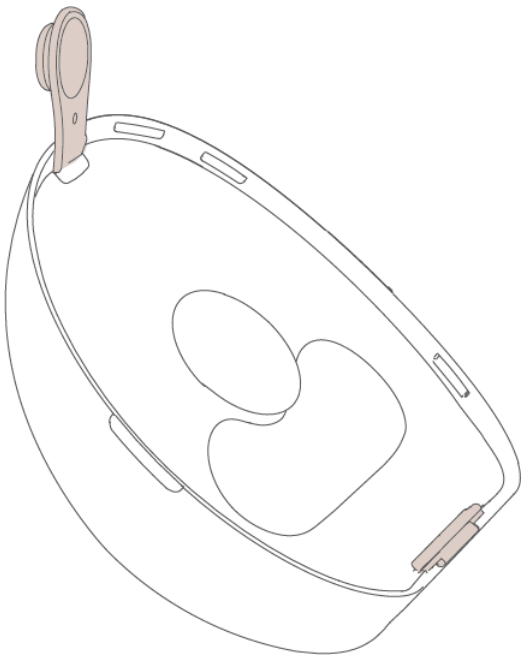

② Press firmly the upper part of the container back with both hands first, then the lower part until you hear a click. Ensure all 4 alignment marks are positioned above the container back to prevent low suction and leaking.

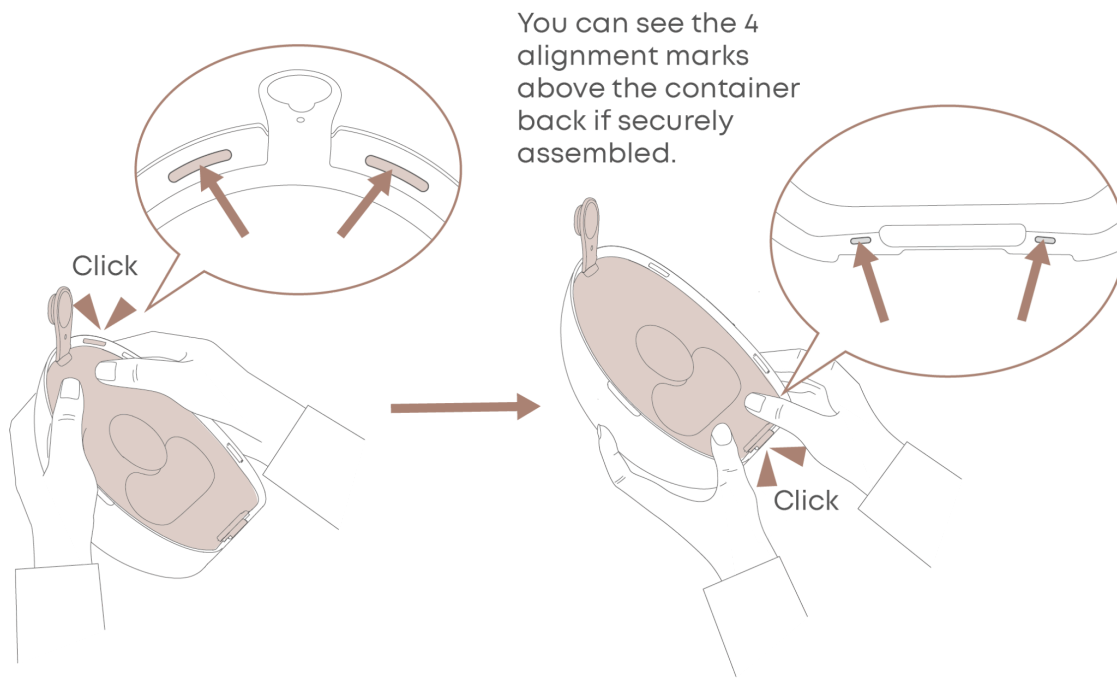

💡 Don't worry! The milk container is made of durable PPSU plastic. It won't break when pressed.

③ Press the container lid firmly into the spout.

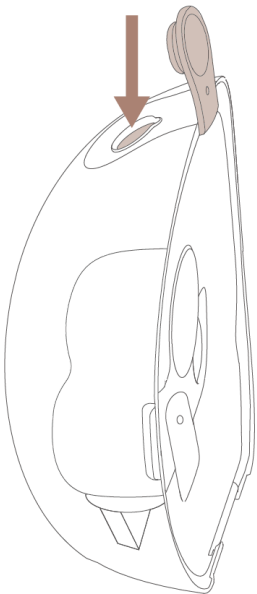

3. Fit the diaphragm into the contoured recess at the back of the container. Ensure the diaphragm rim is fully seated along the groove edge, especially the upper curve.

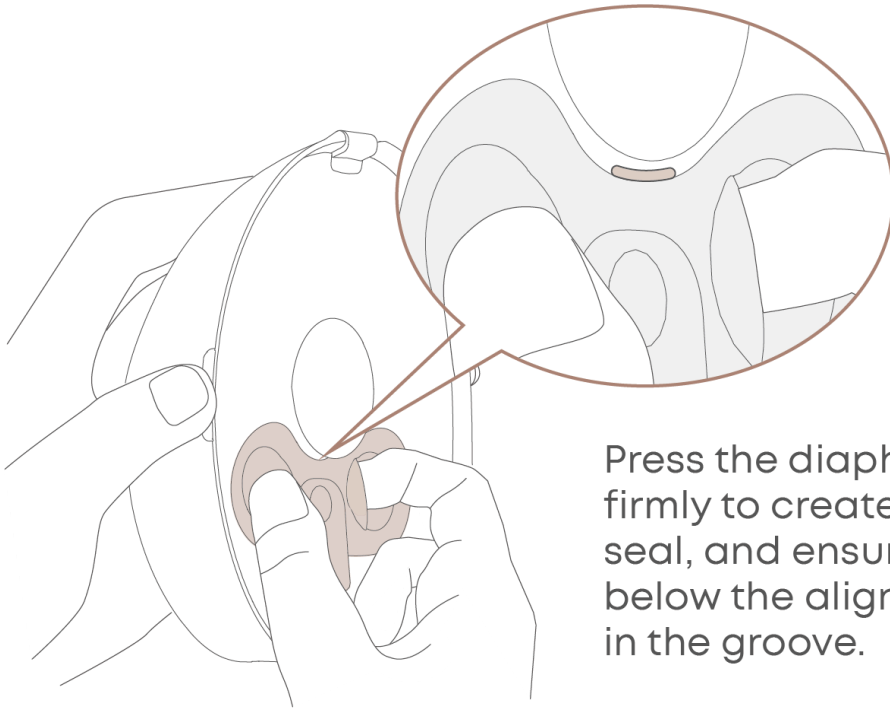

Press the diaphragm lid firmly to create a secure seal, and ensure it sits below the alignment mark in the groove.

 Ensure the diaphragm is completely dry before assembly. Moisture may cause damage to the pump hub.

4. Align the peg on the pump hub with the hole in the diaphragm, and press the assembled container onto the hub until it clicks.

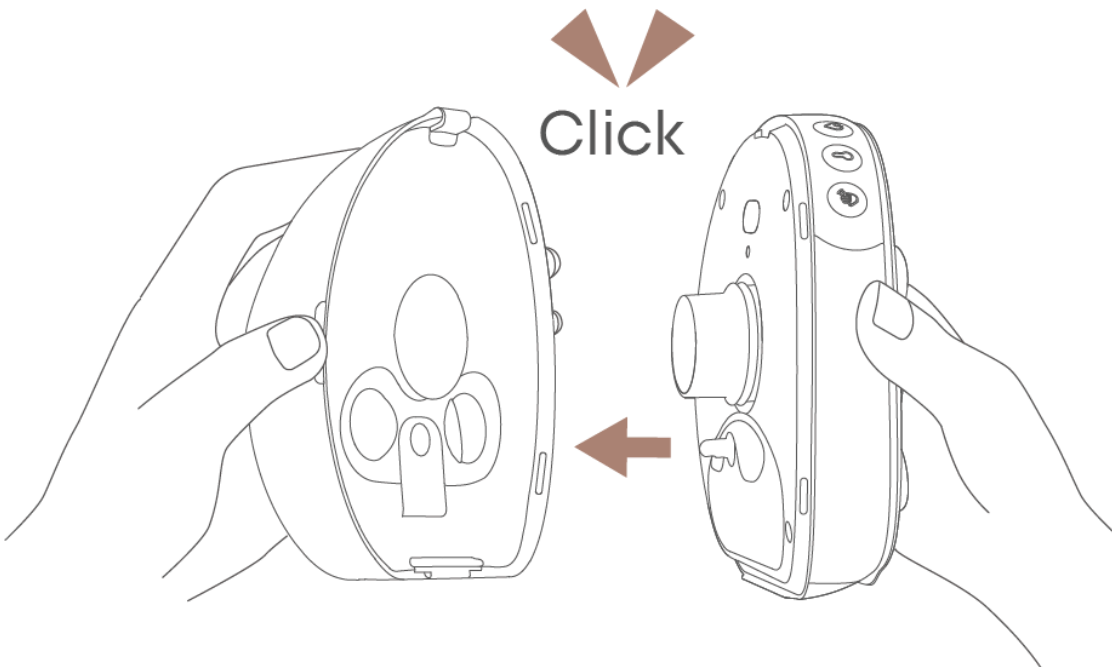

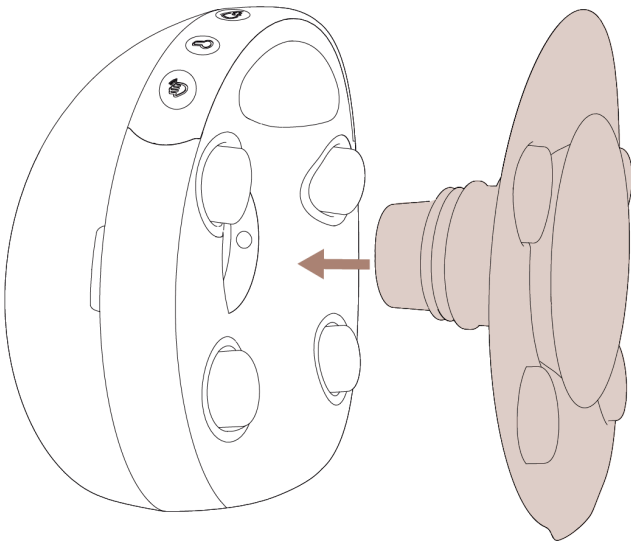

 **Important:** After clicking the container onto the hub, gently tug it to confirm it is securely attached. If not, follow the steps above to reassemble them.

5. Press the flange onto the pump.

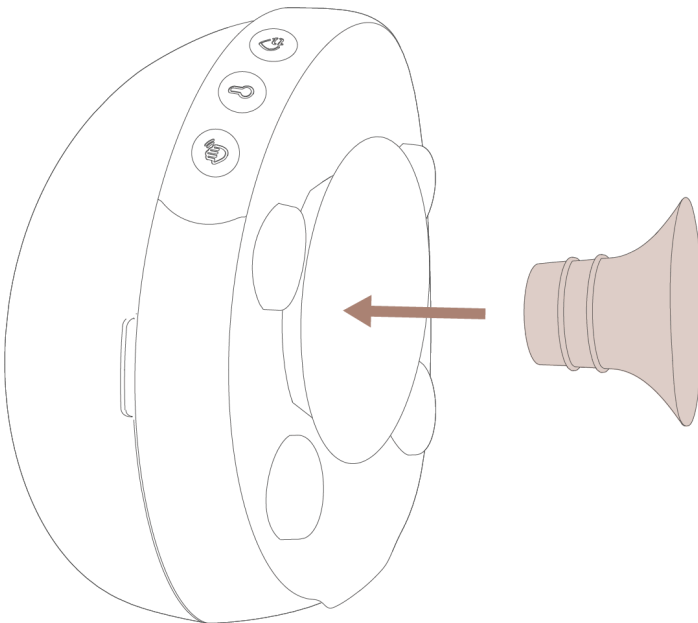

6. Use the Nipple Measurement Card to select an appropriate sizing insert, and place it in the flange tunnel.



 **Very Important:** Choosing the correct flange size is critical for both comfort and output. Use the included Nipple Measurement Card before first use. If you experience low output or discomfort, try a different sizing insert.

5 Wearing

1. Slightly lean forward to make sure your nipple is centered in the flange tunnel. The breast pump should be firmly against your breast.

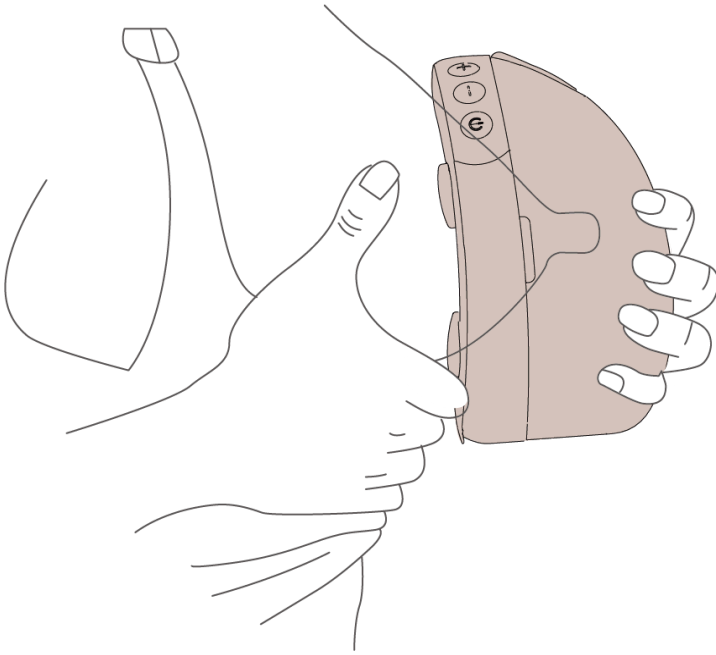

- ② Use a full-coverage nursing bra with a flap to create a tight seal between your breasts and the flange.

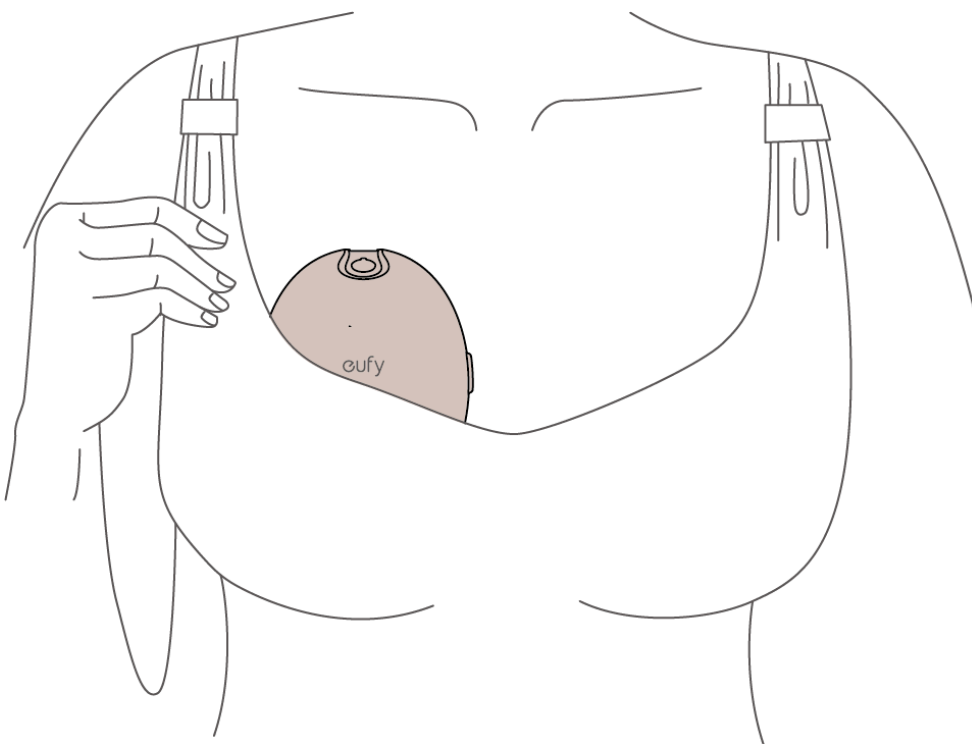





 The massage heads may cause temporary marks on the skin. This is a normal response to gentle stimulation and will disappear shortly after use.

6 Using











Button Controls

Icon		Action	Function
	Power Button	Press and hold for 2 seconds	Turn Breast Pump On / Off <ul style="list-style-type: none"> The breast pump will turn off automatically after 10 minutes of inactivity.
		Press	Pause / Continue
	Mode Button	Press	Press to select the current mode. Press again to switch to the next mode: Stimulation, Expression, Rest, and Mix. <ul style="list-style-type: none"> There are 7 levels in stimulation mode and 10 levels in the expression mode.
		Quick press twice	Turn Nipple Tunnel Light On / Off
	Massage Button	Press	Turn Massage mode On / Off. There are 3 levels in massage mode.
	Heating Button	Press	Turn Heating On / Off <ul style="list-style-type: none"> The default heating duration is 15 minutes. You can change the heating duration in the app.

	Level Up / Down Buttons	Press	<ul style="list-style-type: none"> Increase / Decrease the Suction/Heating/Massage Level.
---	----------------------------	-------	--

Light & Display Guide

Light		Description	Status
	Battery	Flashing White	Charging in Process
		Steady White	Fully Charged
		Steady Orange	Battery Level <30%
		Flashing Orange	Battery Level <5%
	Stimulation Mode	Steady White	In Stimulation / Expression / Massage/ Heating Mode
	Expression Mode		
	Massage Mode		
		Steady White	The corresponding function is selected to adjust stimulation / expression / massage / heating levels.

	Heating Mode		
	Level	Steady White	Indicates the current level of the selected mode (the one that flashes white).
	Running Time	Steady White	Pumping time
	Pair Mode	Left / Right Indicator Flashing Alternately	Left / Right Side Pairing in the App
		Left / Right Indicator White	Left / Right Side Paired in the App

7 Transferring Milk

1. Pause or turn off the breast pump. Lean forward when taking out the pump to prevent leakage.

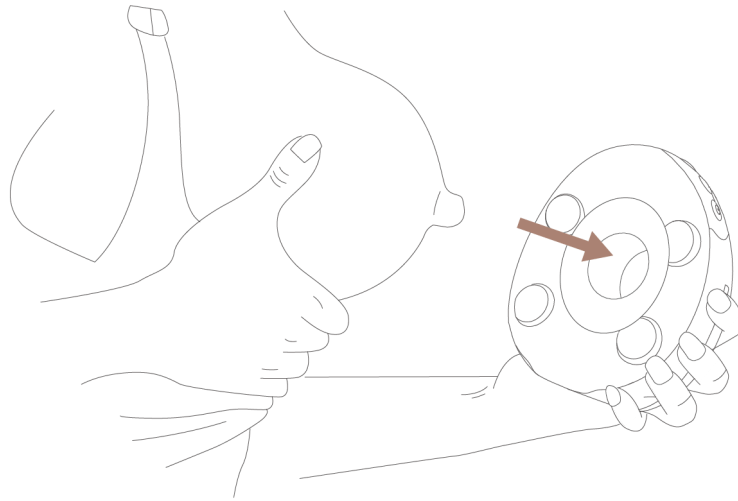

2. Remove the container from the pump hub.

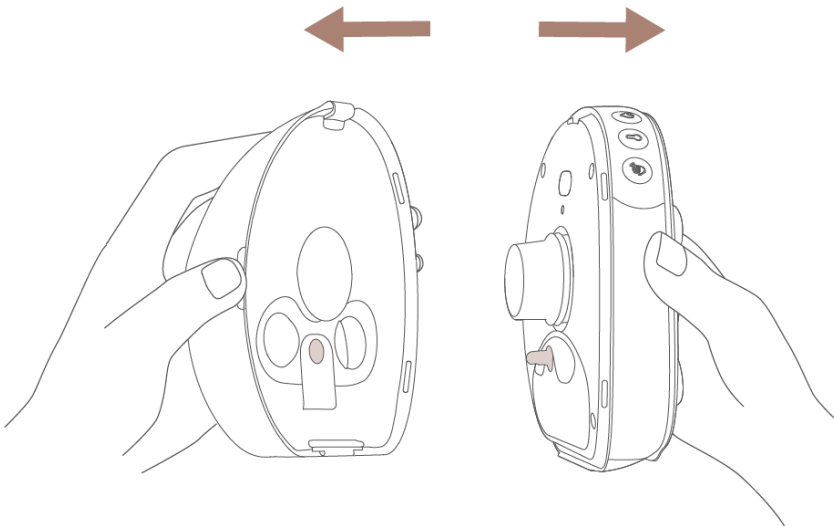

 Do not remove any parts from the container before pouring out the milk to avoid leakage.

3. Open the container lid.

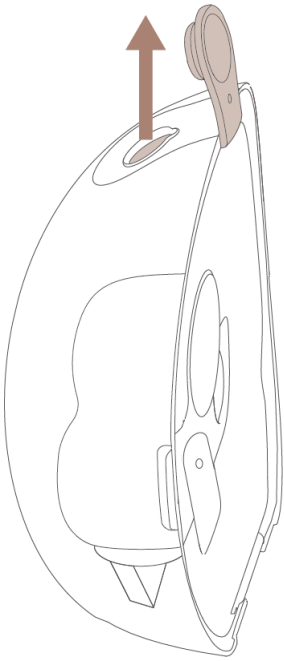

4. Pour out the milk.

- 1 Tilt the container with the pouring spout facing down. Remove the diaphragm if needed to collect any trapped milk under it.

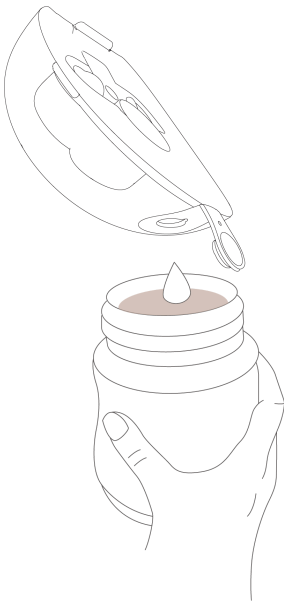

- 2 A small amount of milk may remain in the diaphragm chamber after pouring. To collect all milk, remove the diaphragm, and place the container upright on the table for 10 seconds to allow any trapped milk to flow back into it.

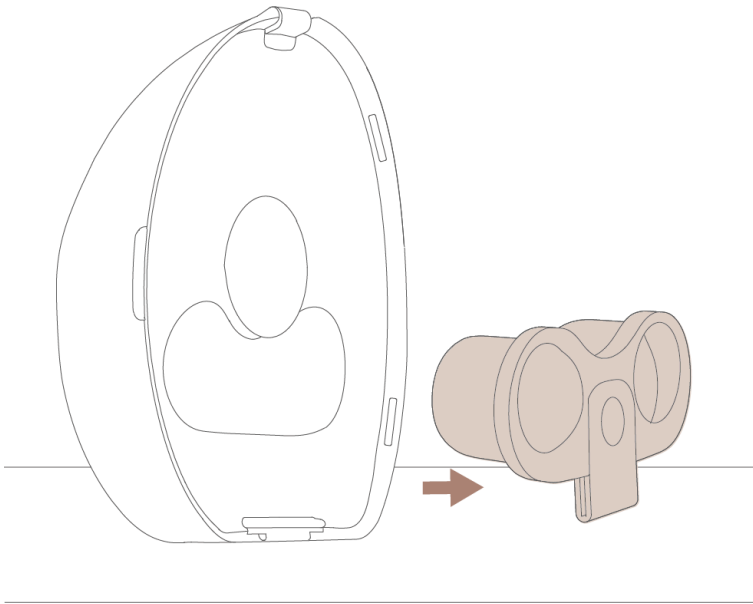

③ Pour out the collected milk.

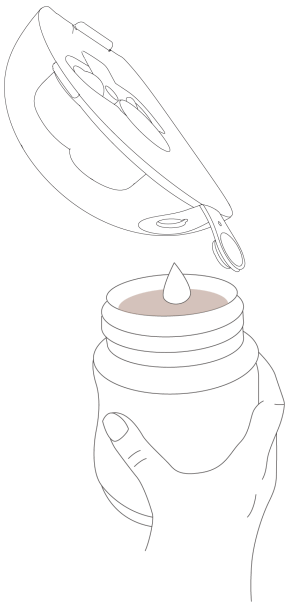



8 The App

Use your pump with the **eufy app** for a fully personalized pumping experience. Customize pumping settings, track and log your data, and manage sessions with ease.

1. Visit the App Store or Google Play to get the latest version of the **eufy app (not eufy Baby)**, and create an account.



 If you are currently using the **eufy Baby app**, please switch to the **eufy app** to continue using all existing devices and access new devices and features.

2. Tap **Add Device > Baby > Breast Pump > Wearable Breast Pump S2 Pro**, and follow in-app instructions to pair the device.
3. Check the firmware updates to ensure you have the latest version of the software:
 - 1 On the **Home** screen, tap **Baby**  >  to enter the Setting page.
 - 2 Select a breast pump, and tap **About Device > Check for Firmware Updates**.
 - 3 After you complete the update of one breast pump, select another breast pump, and repeat Step 2.

9 Replacing and Purchasing Washable Parts

The estimated life of the washable parts is 1-3 months, and actual life will vary with use and sterilization frequency.

Replace them if you notice a decrease in suction and performance (particularly the duckbill valve), or if you have stored them too long when planning to pump for your next child.

Need extra washable parts for your breast pump? Visit [eufy.com](https://www.eufy.com) to find and order what you need.

10 Top 10 Troubleshooting Tips

1. Container won't click tightly onto the hub?

Step 1: reassemble the container back.

Press firmly the upper part of the container back with both hands first, then the lower part. Ensure all 4 alignment marks are positioned above the container back to prevent low suction and leaking. There are 4 alignment marks in total: 2 on the left and right sides of the pouring spout, and 2 at the bottom.

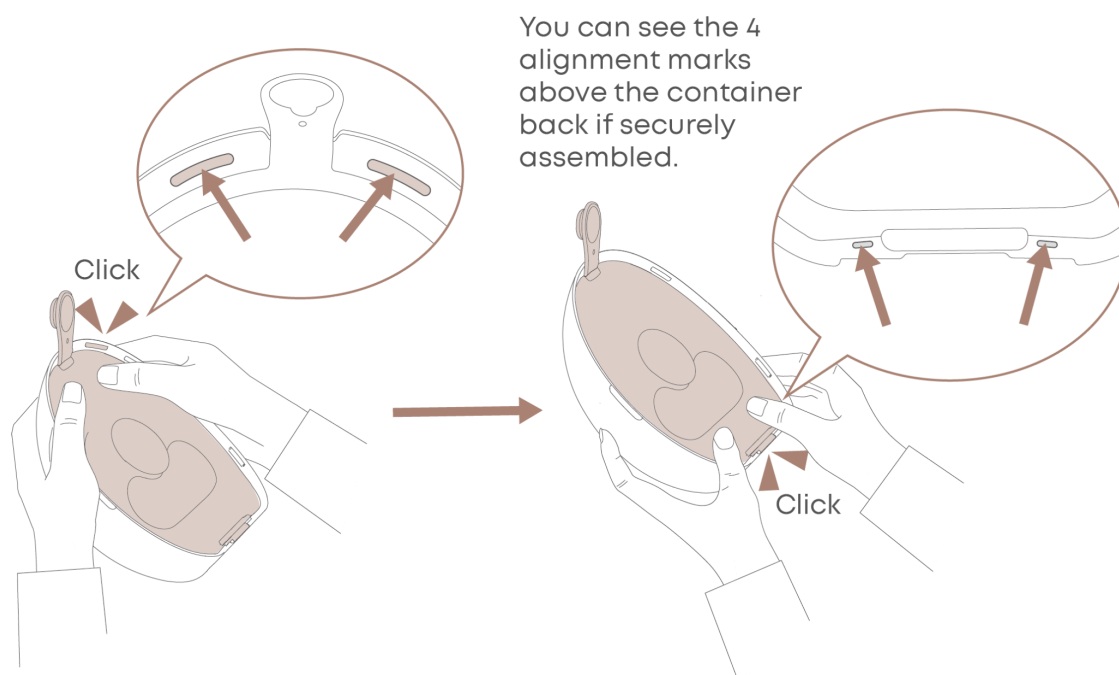

Step 2: reassemble the diaphragm.

Fit the diaphragm into the contoured recess at the back of the container. Ensure the diaphragm rim is fully seated along the groove edge, especially the upper curve. Press the diaphragm lid firmly to create a secure seal, and confirm it sits below the alignment mark in the groove.

Step 3: reattach the container to the hub.

Align the peg on the pump hub with the hole in the diaphragm, then press the assembled container firmly onto the hub until you hear and feel a click.

2. No suction, or very little output?

- Inspect the duckbill valve and diaphragm for any damage — cracks, chips, holes, or tears. If damage is found, stop using immediately and replace the affected part.
- Check if the 4 main components (duckbill valve, diaphragm, container, and flange tunnel) are correctly assembled and fully sealed. Possible causes of improper assembly:
 - The duckbill is not fully pushed in place.
 - The container back is not fully seated under all 4 alignment marks.
 - The diaphragm rim is not fully seated along the groove edge.
 - The diaphragm lid is not firmly pressed and does not sit below the alignment mark in the groove.
 - The container is not fully clicked onto the hub.
 - The flange is not fully pushed in and securely clicked.

- Adjust the fit: ensure your nipple is centered in the flange tunnel and the pump is sealed snugly against your breast.
- Try a different insert size for a better fit.

 It takes time for your body to respond to a new pump — don't be discouraged if output is low at first.

3. Milk left behind after pouring?

- Milk trapped in the diaphragm: remove the diaphragm, and place the container upright on the table for 10 seconds to allow any trapped milk to flow back into it, then pour.
- Milk remaining in the container: give the container a few quick flicks toward the bottle to help any remaining milk flow down.

4. How to prevent leak?

- Ensure the container back is firmly pushed in and fully seated under all 4 alignment marks—two on the left and right sides of the pouring spout, and two at the bottom.
- Wear a full-coverage nursing bra to create a tight seal between the breasts and the flange.
- Do not lean back or bend forward excessively while pumping.
- Do not disassemble the container before transferring the milk.
- Keep the flange tunnel facing upward when transferring the milk.

5. Feel painful?

Ensure you have selected the correct flange size for your nipple. Refer to the provided nipple measurement card and sizing guide. If needed, try sizing up or down to find the most comfortable and effective fit.

Adjust the wearing position so the nipple is centered within the flange tunnel.

Gradually increase the suction until it feels strong yet comfortable.

Use the heating and massage features to enhance comfort and relaxation.

Try pumping spray.

6. How to do the fridge hack with the S2?

Detach the container from the pump hub. Insert the flange tunnel into the container tunnel to form a single integrated unit, then store in the fridge.

 Do not put the pump hub in the fridge.

7. The breast pump hub won't charge or turn on?

- Press and hold the power button on the pump hub for 12 seconds to reset it.

- If using the charging case, adjust the breast pumps to ensure proper contact with the charging pins.
- Press and hold the power display button on the charging case for 2 seconds to reset it
- Use a 5V/2A or higher power adapter.
- Charge directly using the included magnetic charging cable.

8. The charging case cannot be charged or charge the breast pumps?

Press and hold the power display button on the charging case for 2 seconds to reset it.

9. The app can't find or can't add the device?

Step 1: update to the latest version of the eufy app from your app store.



Step 2: press + and – simultaneously for 2 seconds until the L and R indicator lights flash alternately, indicating the device is in pairing mode.

Step 3: follow the in-app instructions to complete the pairing.

Only one pump connects to the app?

Close and reopen the eufy app. Make sure the unconnected pump is in pairing mode, then redo the pairing process for that unit.

10. How do I update the firmware?

Step 1: on the Home screen, tap **Baby** >  >  to enter the Setting screen.

Step 2: select a breast pump, and tap **About Device** > **Check for Firmware Updates**.

Step 3: after you complete the update of one breast pump, select another breast pump, and repeat **Step 2**.