

## OVERVIEW

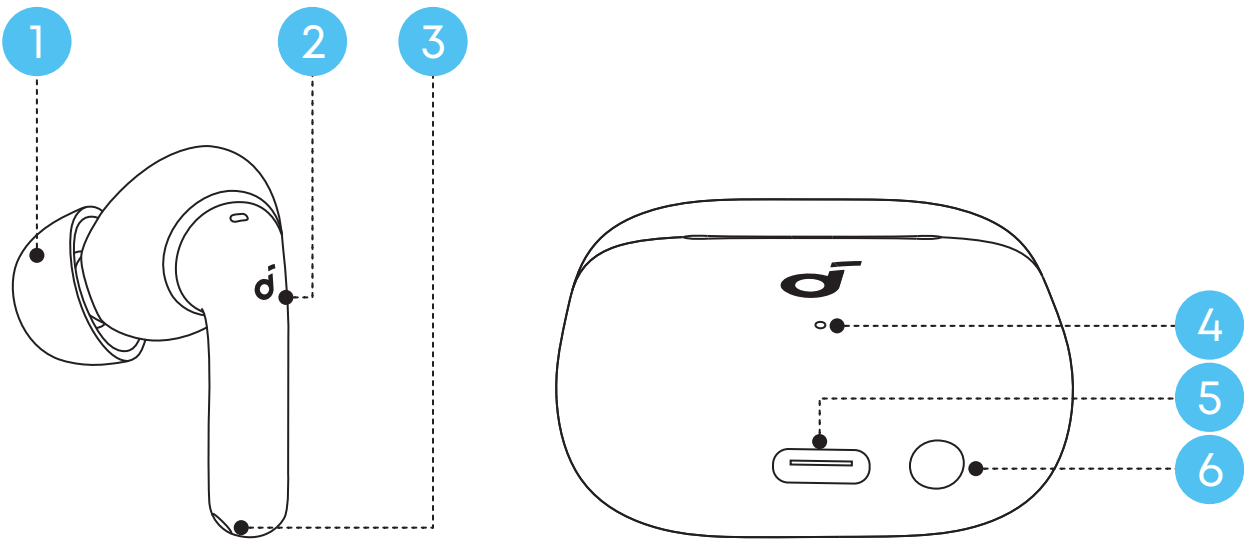

### 1. Ear Tip

- M-sized ear tips come attached to the earbuds.

### 2. Touch Control Area

- Tap the control area on the earbud stems to manage different functions.

### 3. Earbud Charging Contacts

### 4. LED Indicator

### 5. USB-C Charging Port

### 6. Charging Case Button

## POWERING ON & PAIRING

### First-time Pairing

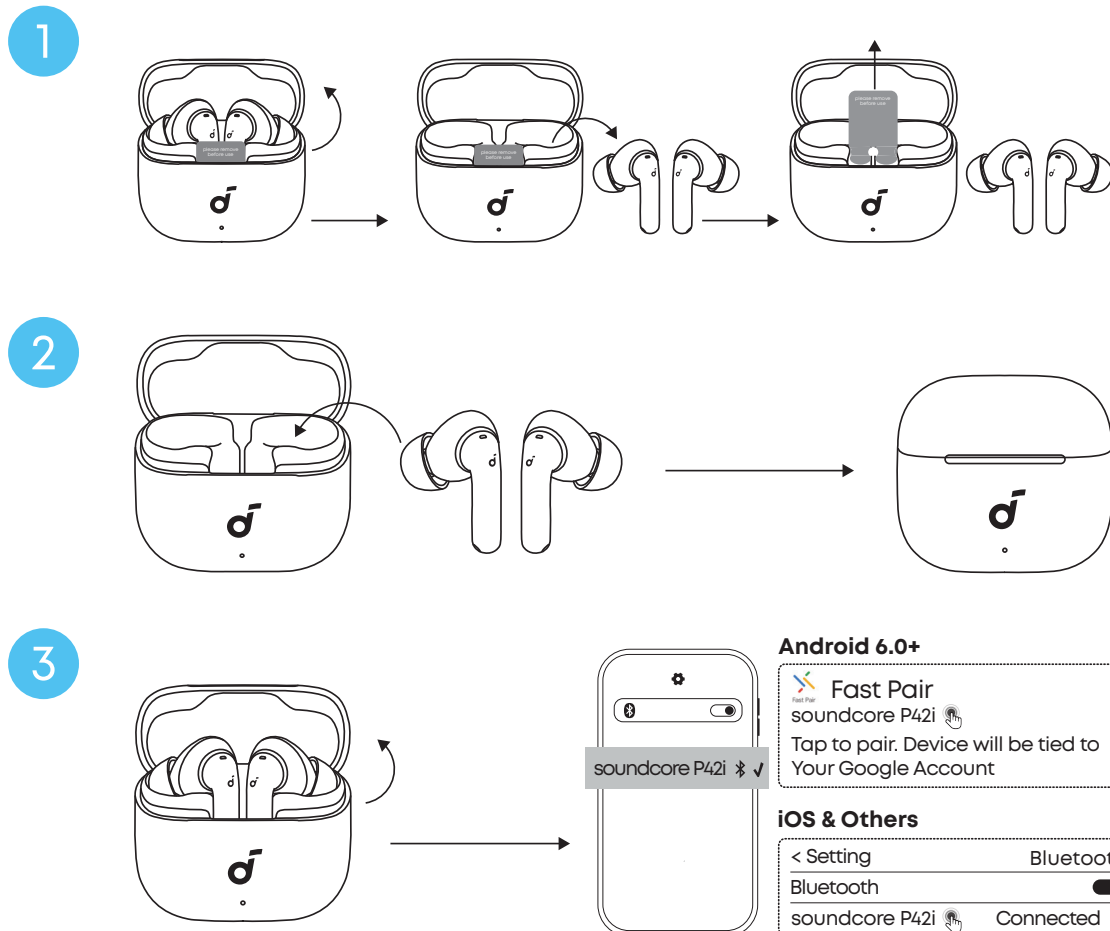

1. Remove the protective films from the charging case.
2. Place the earbuds back in the charging case and close the lid.
3. Reopen the lid. The earbuds will automatically power on and enter Bluetooth pairing mode. On Android 6.0 or above, tap the Fast Pair prompt to connect instantly. On iOS and other devices, select "soundcore P42i" from your Bluetooth settings.

**Note: On Android 6.0+, Google Fast Pair automatically detects and pairs the earbuds. Simply tap the notification to complete the connection.**

## Manual Pairing

The earbuds will automatically reconnect to the last paired device when you open the charging case. If the earbuds do not reconnect, tap and hold the control area on both earbud stems for 3 seconds until you hear a voice prompt indicating the earbuds are in pairing mode. You can then proceed to pair with your device.

## WEARING GUIDE

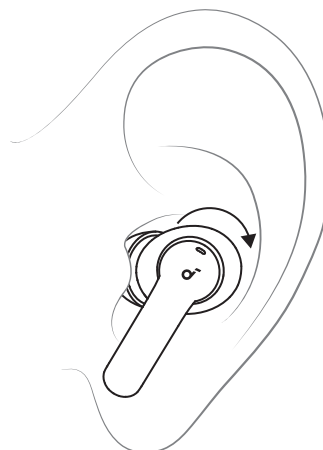
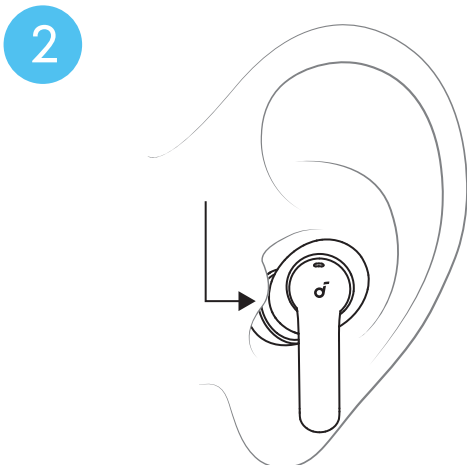
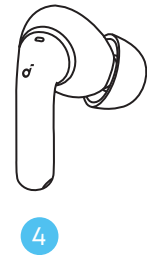
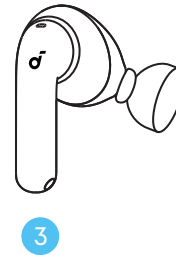
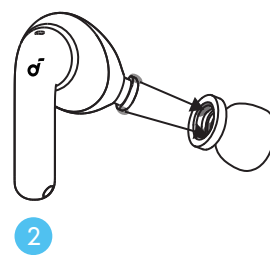
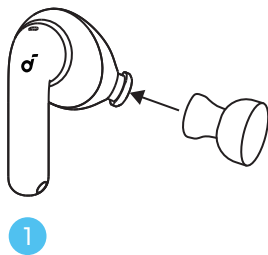
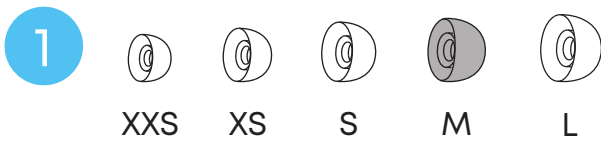

Properly wearing your earbuds will provide a more comfortable and stable fit while ensuring optimal noise cancellation and sound quality.

1. The earbuds come with five sizes of ear tips. Try with the default M-size ear tips. If one earbud doesn't fit well, try using different sizes for each ear, such as medium in one ear and large in the other.
2. Gently place the earbuds into your ear canal and rotate them for a snug fit.
3. Use the soundcore app's **Fit Test** feature to ensure the earbuds are worn correctly for optimal sound quality and noise isolation.



- When wearing the earbuds, avoid touching the area near the logo to prevent accidental touches.
- Dust, earwax, or other debris can accumulate in the earbuds. To maintain optimal sound quality, clean them regularly. Use a slightly moistened cotton swab with rubbing alcohol to gently wipe the metal mesh filter beneath the rubber ear tips. Make sure the alcohol has completely dried on the metal mesh filter before using the earbuds again.

## DUAL CONNECTIONS

Dual Connections is enabled by default. You can connect your earbuds to two Bluetooth devices at the same time using either of the following methods.

### Method 1: Using the Earbuds

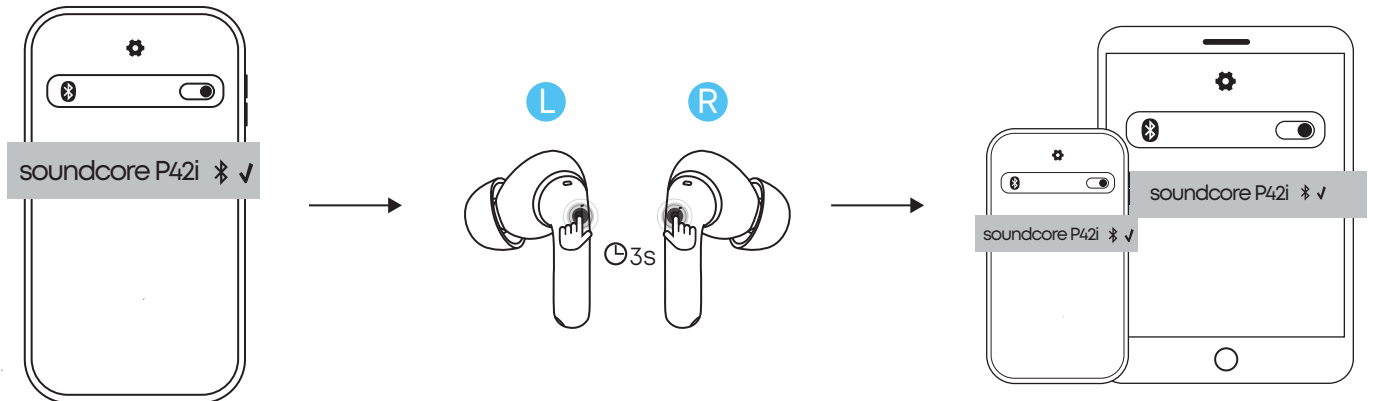

1. Make sure the earbuds are already connected to the first device.
2. Tap and hold the control area on both earbuds for 3 seconds until you hear a voice prompt indicating pairing mode.
3. On your second device, select "**soundcore P42i**" on the Bluetooth list to complete pairing.

### Method 2: Using the Charging Case

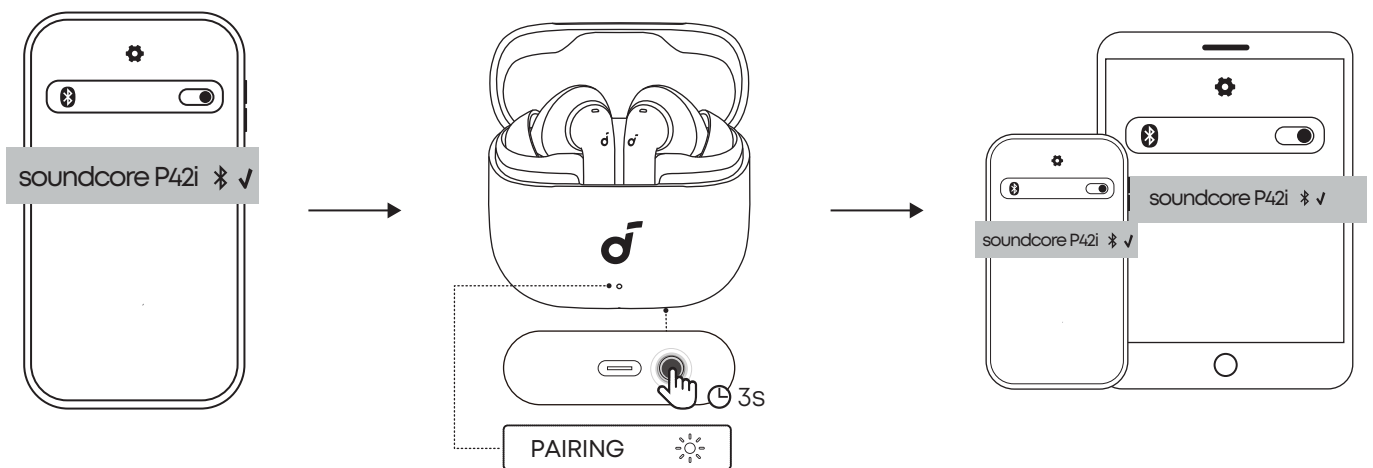

1. Ensure the earbuds are connected to the first device and placed in the charging case.
2. With the lid open, press and hold the case button for 3 seconds until the LED indicator flashes white, indicating that the earbuds are in pairing mode.
3. On your second device, select "**soundcore P42i**" on the Bluetooth list to complete pairing.



- Manual pairing and Dual Connections pairing follow the same procedure.
- Dual Connections can be turned off in the soundcore app. Tap the gear icon in the upper-right corner to access Settings, then tap the toggle switch for Dual Connections to turn it off.

## CHARGING

1

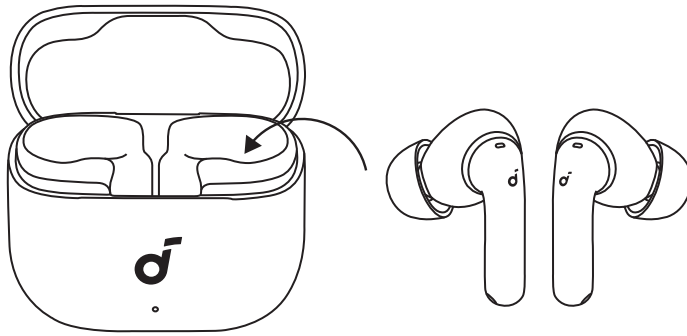

2

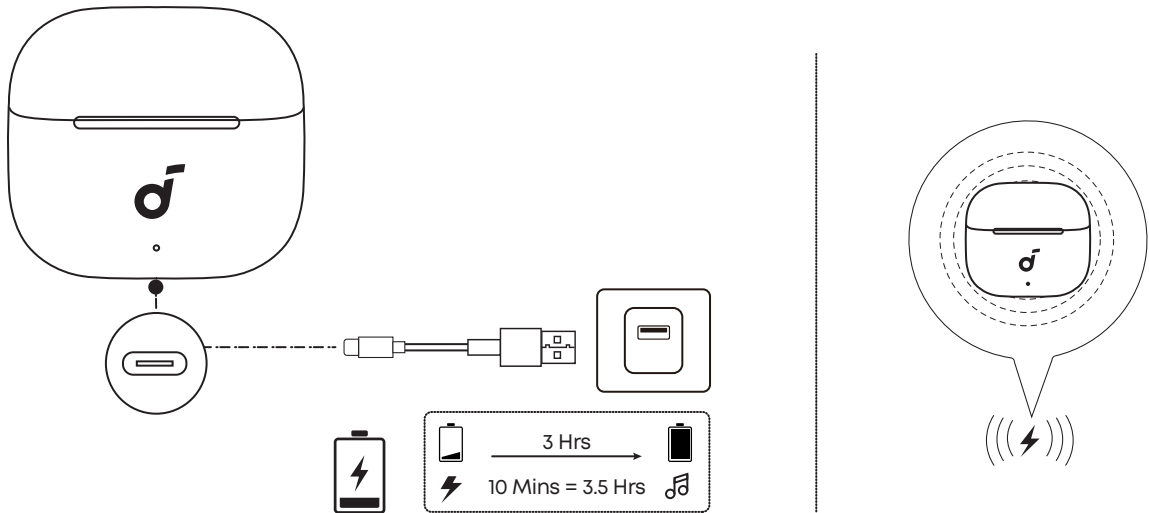

1. Place the earbuds into the charging case, ensuring the charging contacts align.
  - Fully dry off the earbuds and the USB-C port before charging.
2. Connect the charging case to a power supply using the provided USB-C charging cable. For wireless charging, place the charging case at the center of your wireless charger.
  - Fully charging the case with the earbuds inside takes about 3 hours via cable or 4 hours wirelessly. A quick 10-minute charge gives the earbuds up to 3.5 hours of playtime.

## CONTROLS

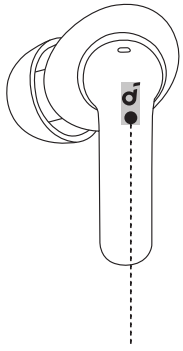

Touch Control Area

### Using Both Earbuds

	 Lx2	 Rx2	 ANC On → Transparency L/R ⊖ 2s
	 L/Rx2	 L/R ⊖ 2s	

### Using Single Earbud

	 x2	 ANC Off → Transparency ⊖ 2s
	 x2	
	 ⊖ 2s	

		Using Both Earbuds	Using Single Earbud
	Play / Pause Audio	Double Tap (R)	Double Tap
	Play the Next Track	Double Tap (L)	/
	Answer / End a Call	Double Tap (L/R)	Double Tap
	Reject a Call	Tap and Hold for 2 Seconds (L/R)	Tap and Hold for 2 Seconds
	Switch Ambient Sound Modes	Tap and Hold for 2 Seconds to Switch from ANC On to Transparency Mode (L/R)	Tap and Hold for 2 Seconds to Switch from ANC Off to Transparency Mode



You can customize controls settings and touch sensitivity in the soundcore app.

## AMBIENT SOUND MODES

You can select from four ambient sound modes in the soundcore app. By default, with the earbuds out of the case, press and hold the touch control area to switch between Noise Canceling and Transparency modes. To include additional modes, such as Adaptive or Normal, in the long-press cycle, customize the settings in the app.

**Go to the product's home page > Controls > Long Press Settings.**

### Noise Canceling

**Ultra ANC:** Delivers the strongest ANC performance, significantly reducing environmental noise such as on airplanes, subways, or in noisy offices. Ideal when you need complete focus or uninterrupted rest.

**Natural ANC:** Evenly lowers ambient volume while keeping surrounding sounds clear. Higher levels provide stronger noise cancellation. Ideal for protecting your hearing at concerts without losing the atmosphere, or for reducing distractions in libraries and offices while still staying aware of your

surroundings.

Note: Unlike **Ultra ANC**, which blocks out most external noise, **Natural ANC** lowers the volume without changing the ambient sound quality—voices, instruments, and ambient sounds remain clear, only quieter. This mode is especially suitable for hearing protection at concerts or music festivals.

### **Adaptive**

Automatically detects changes in ambient noise and adjusts the noise canceling level accordingly, so you can move from a quiet room to a noisy street without switching modes manually. Ideal for commuting and changing environments.

### **Transparency**

Lets in external sounds naturally, so you can hear conversations, traffic alerts, and your surroundings clearly without removing your earbuds. Suitable for commuting and office use.

### **Normal**

Turns off active noise canceling and transparency processing for a more natural listening experience. Best for quiet environments or when you want pure, unprocessed sound.

## **AI ASSISTANT**

### **Before Use:**

- Uninstall any previous versions of the soundcore app on your device and download the latest version.
- Keep the app open and your earbuds connected to your phone via Bluetooth while using the AI assistant. On Android devices, allow the app to run in the background.

### **Note:**

- The AI assistant prioritizes your privacy and data security.
- AI-generated responses are for reference only and may contain inaccuracies. Please use your discretion.
- Feature interfaces may vary with app version updates.

### **What Anka Can Do for You**

<b>Function</b>	<b>What It Does</b>	<b>Example Command (Say the following to Anka after activating with "Hey Anka")</b>
Answering Questions	Acts as your portable encyclopedia. Ask any question anytime.	"Why do giraffes have such long necks?"
Casual Conversation	Chats with you like a friend would and helps you relax.	"Tell me a joke."
Information Aggregation	Keeps you up to date with daily news and updates.	"Tell me the latest tech news for today."
Information Lookup	Checks the weather, the latest match scores, and more.	"What's the weather like in New York today? Will I need an umbrella when I go out?"



- Some voice commands may not work due to app limitations.

### **How to Access the Feature**

In the soundcore app, go to **Anka Page > Chat With Anka**.

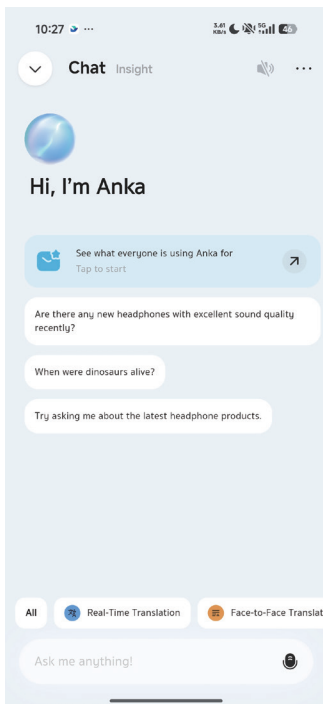

## AI TRANSLATION

Note: Feature paths and interface visuals may change with software updates. For the most accurate guidance, please refer to your latest app version.

### Before Use:

- Please upgrade to the latest version of the soundcore app and ensure that your earbuds are connected to the app.
- Disable Multi-Device Connection.

### Real-Time Translation

In settings where you're exposed to content in a foreign language for extended periods (e.g., lectures, classes), real-time translation delivers continuous text display and audio playback of the translated content with almost no lag.

In the soundcore app, go to **Anka page** and tap **Real-Time Translation**. Make sure your earbuds are connected to the app.



1. Tap **Real-Time Translation**.
2. Tap the language section at the top of the page, then select **Their Language** and **My Language**.

3. Tap the microphone button to start recording.

## Face-to-Face Translation

In the soundcore app, go to **Anka page** and tap **Face-to-Face Translation**.

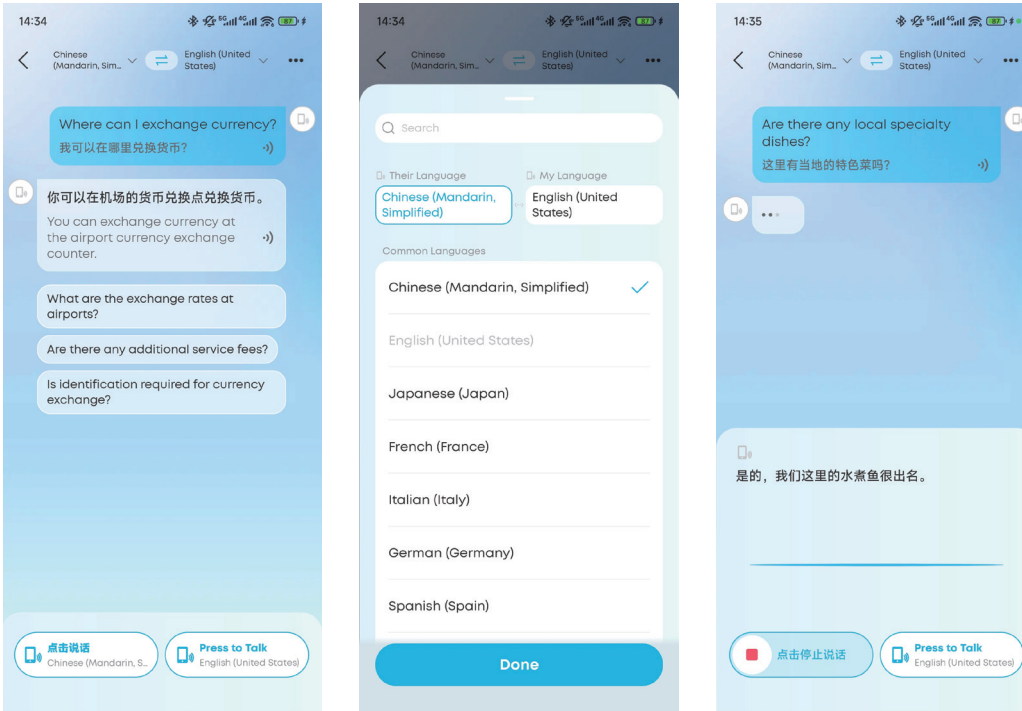

When your earbuds are connected to the app, follow the steps below to try out Face-to-Face Translation.

1. Tap the language section at the top of the page, then select **Their Language** and **My Language**.
2. Tap the bottom-right button and speak into your earbuds. The translation will play from your phone.
3. Tap the bottom-left button and speak into your phone. The translation will play from your earbuds.

**Note: This feature works even if your earbuds aren't connected to the app. Just speak into your phone, and the translation will play through its speaker.**

## LDAC

Enable LDAC in the soundcore app to enjoy high-resolution audio on devices running Android 8.0 or later. This feature delivers higher sound quality but may increase power consumption and reduce playtime. For the best LDAC performance with stable Bluetooth connection, use LDAC in a low-interference environment.

Follow the steps below to enable LDAC on your device:

1. Open the soundcore app and go to Settings.
2. Tap **"Sound Mode"**.
3. Select **"Preferred audio quality"** to switch to LDAC codec.
4. Tap **"Agree"** to proceed.
5. Switching audio codecs takes about 10 seconds. You may be prompted to update your earbuds' firmware if an update is available.

## RESETTING

1

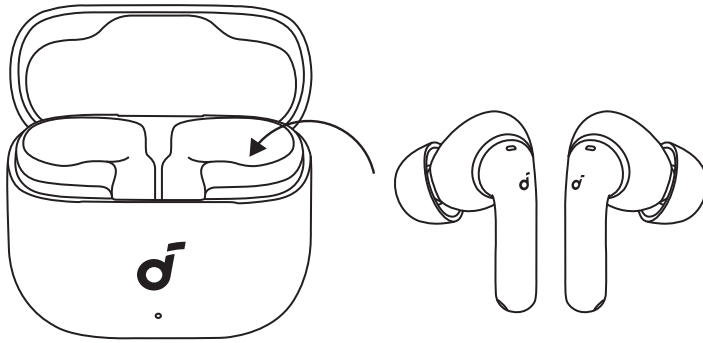

2

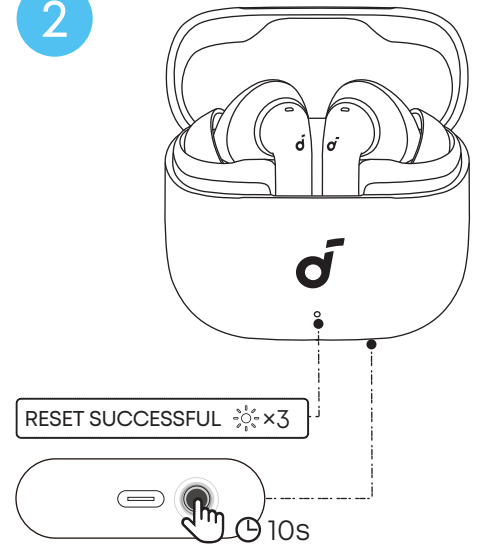

You might need to reset the earbuds if you experience any connectivity issues.

Press and hold the case button for 10 seconds until the LED indicator flashes white, indicating a successful reset.

## LED BEHAVIOR

### Pairing and Connected

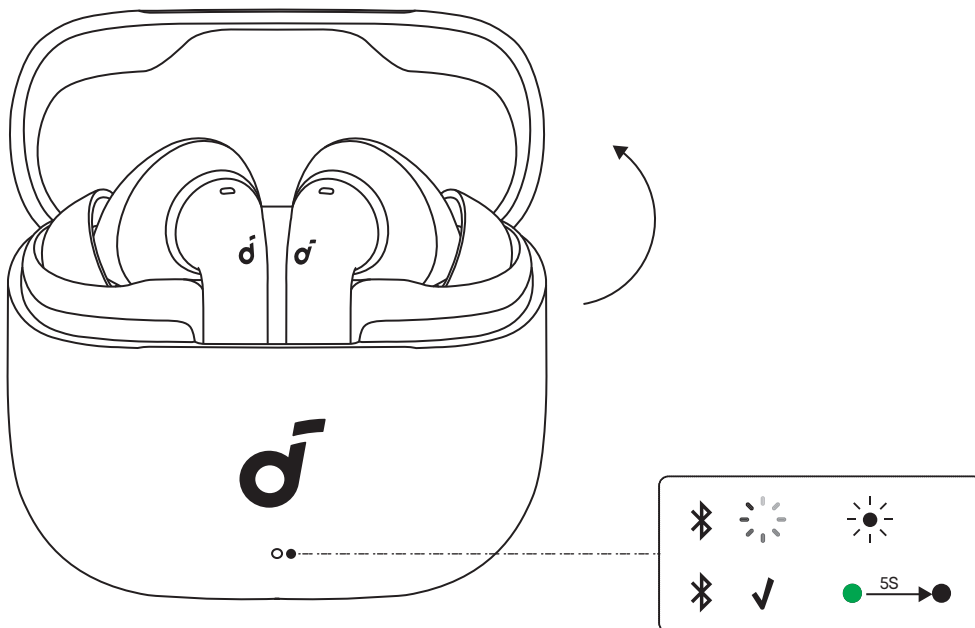

During Bluetooth pairing, the LED Indicator displays the pairing status in real time.

## Check the Battery Level

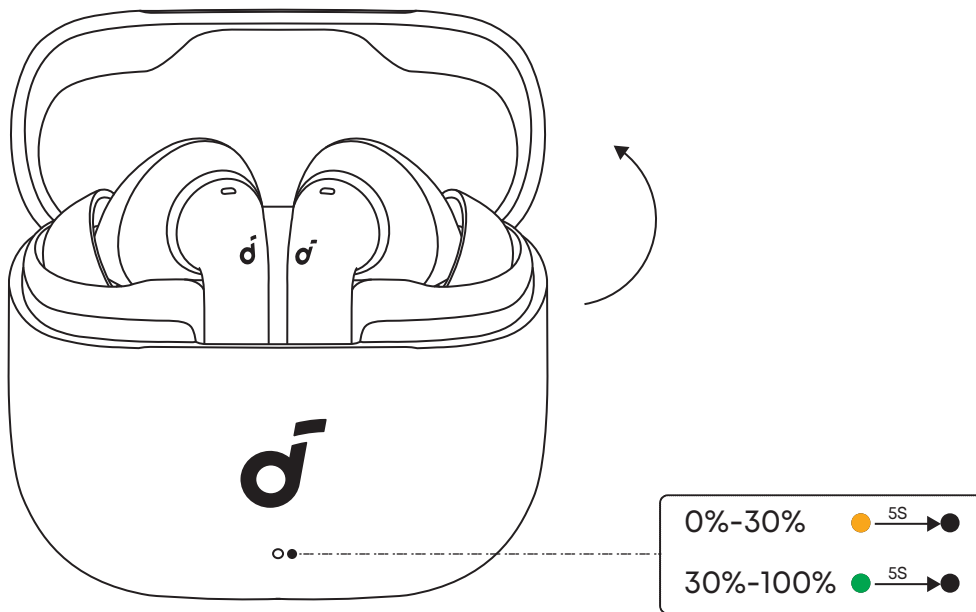

The LED light strip shows the battery level whenever you open the charging case.

Battery Level	LED Behavior
0-30%	The LED Indicator turns orange for 5 seconds and then goes off.
30-100%	The LED Indicator turns green for 5 seconds and then goes off.

## Charging

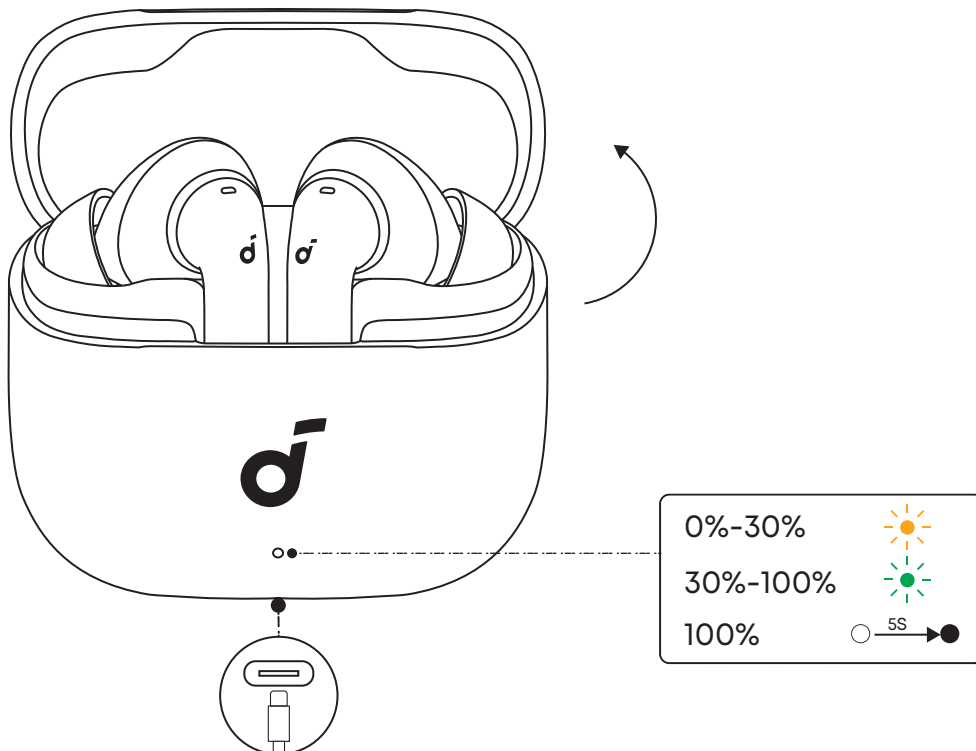

When charging, the LED behavior varies as the battery reaches different levels.

Battery Level	LED Behavior
0-30%	The LED light strip breathes orange.

30-100%	The LED light strip breathes green.
100%	The LED light strip turns solid green for 5 minutes and then goes off.

## FIRMWARE UPDATE

You will be informed once a new firmware version is detected when you connect the earbuds to the app. Ensure the earbuds are placed in the charging case and the lid remains open until the firmware update is complete. During the update, ensure the earbuds are being charged and avoid using them.

## SPECS

Specifications are subject to change without notice.

Input	Earbud (Single): 5V $\approx$ 0.12A (0.6W) Charging Case (Wired Charging): 5V $\approx$ 0.4A (2W) Charging Case (Wireless Charging): 5V $\approx$ 0.33A (1.65W)
Output	Charging Case: 5V $\approx$ 0.24A (1.2W)
Battery Capacity	Earbud (Single): 60mAh (0.231Wh) Charging Case: 690mAh (2.6565Wh)
Playtime (with ANC Off)	12 Hours (Up to 56 Hours with the Charging Case)
Playtime (with ANC On)	8.5 Hours (Up to 40 hours with the Charging Case)
Charging Time	Full Charging Time for Earbuds: 1 Hour Full Charging Time for Charging Case (Wired Charging): 3 Hours Full Charging Time for Charging Case (Wireless Charging): 4 Hours
Driver Unit	11 mm
Frequency Response	20 Hz - 40 kHz
Impedance	14.2 $\Omega$
Waterproof & Dustproof Rating (Earbuds Only)	IP55
Bluetooth Version	BT 6.1
Bluetooth Range	10 m / 33 ft

## CUSTOMER SERVICE

service@soundcore.com  
 uk.support@soundcore.com (UK)  
 ie.support@soundcore.com (IE)  
 ced-cn@anker.com (中国)  
 support@anker.com (日本)  
 support.kr@anker.com (한국)  
 support.taiwan@anker.com (中國台灣)  
 support.mea@soundcore.com (For Middle East and Africa Only)  
 support.india@anker.com (India)  
 it.support@soundcore.com (IT)  
 es.support@soundcore.com (ES)  
 (US/CA) +1 (800) 988-7973  
 (UK) +44 (0) 1604 936 200  
 (DE) +49 (0) 69 9579 7960  
 (IE) 1800 456 942  
 (South Africa) +27 801112209  
 (UAE) +971 8000 320 817  
 (KSA) +966 8008 500 030  
 (Kuwait) +965 2206 9086  
 (Egypt) +20 8000 000 826  
 (AU) +61 1800 920 330  
 (NZ) 0800 207 521  
 (PL) +48 800 707 993  
 (SE) +46 20 012 33 22  
 (中国) +86 400 0550 036  
 (中國台灣) +886 80 149 1310  
 (日本) 03 4455 7823 (平日 9:00~17:00/ 年末年始を除く)  
 (한국) +82 1666-8470  
 (India) +91 8000 504 414  
 (BR) +55 0800 000 7720  
 (MX) +52 800 461 1188

Note: The 'x' of SN Code: xxxxxxxxxxxxxxx is a variable, see below table.

Variable 'x'	Range of variable	Content
Eighth	0-9 or A-F	Denotes the hardware version which is not affected on the safety compliance.
Ninth	8,9,A,B,C...	Denotes the year, 8 means 2018, 9 means 2019, A means 2020, B means 2021, C means 2022, and so on.
Tenth and Eleventh	01,02,03...	Denotes weeks, 01 means the first week in this year, 02 means the second week in this year, and so on.
Twelfth	1-7	Denotes date, 1 means Monday, 2 means Tuesday..., 7 means Sunday and so on.
The last five	00001-99999	Denotes serial No.

Hereby, Anker Innovations Limited declares that this device is in compliance with The Product Security and Telecommunications Infrastructure (Security Requirements for Relevant Connectable Products) Regulations 2023. For the Statement of Compliance, visit the website:

<https://uk.soundcore.com/pages/psti-related>.

**Default Open Port:** Classic Bluetooth

**Port Description:** After the device is powered on, Classic Bluetooth visibility (or pairing mode) is automatically enabled, providing Bluetooth pairing (or control) services. The Bluetooth service is disabled when the device is powered off.

This product is designed and intended for personal consumer use only.